

6 SPRUCE LANE TAX MAP R20 LOT 6 FLOOR PLAN

OF LAND IN
KINGSTON, NH

AS OWNED BY
**CAPRI REALTY AND
MANAGEMENT, LLC**

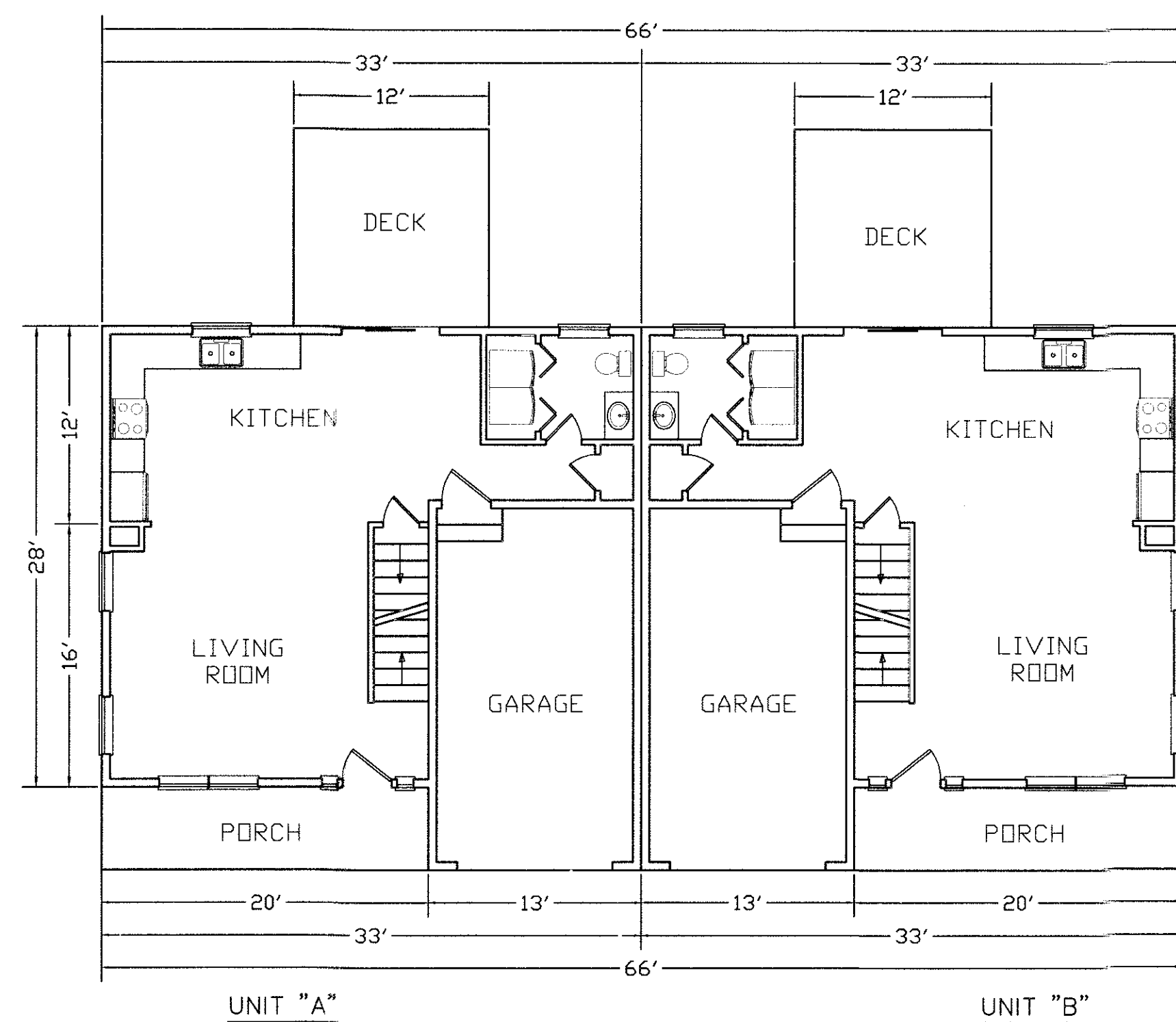

FIRST FLOOR PLAN

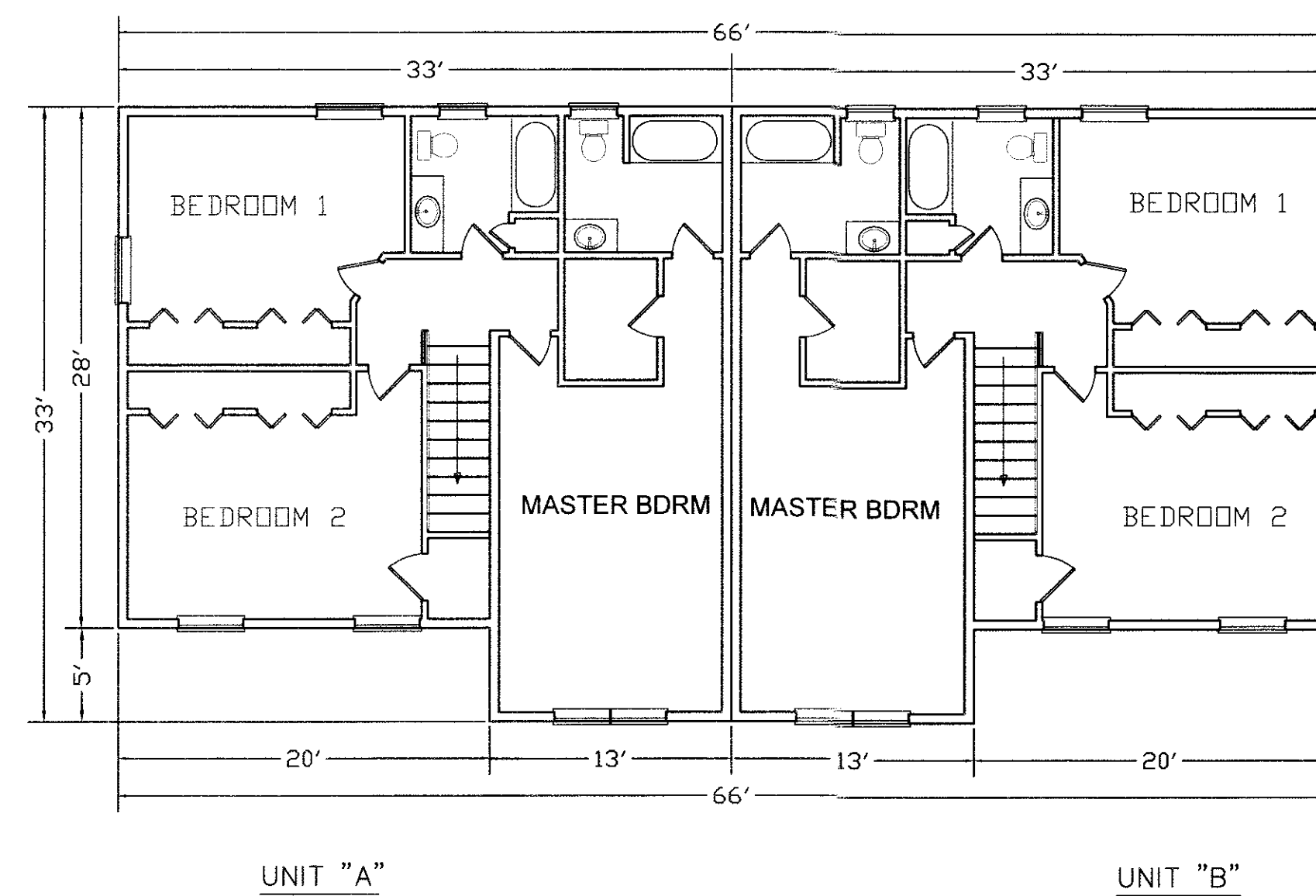

SECOND FLOOR PLAN

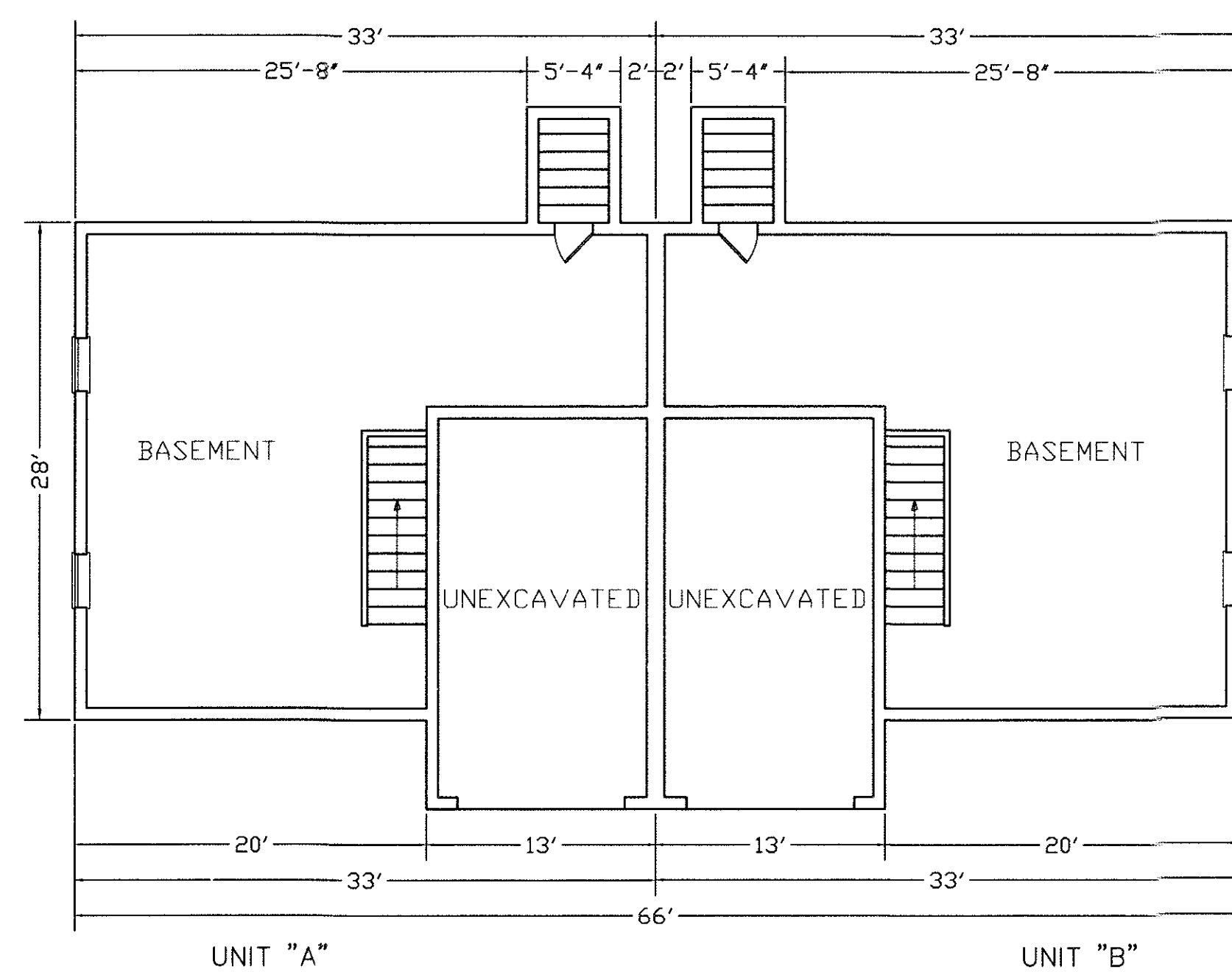

BASEMENT PLAN

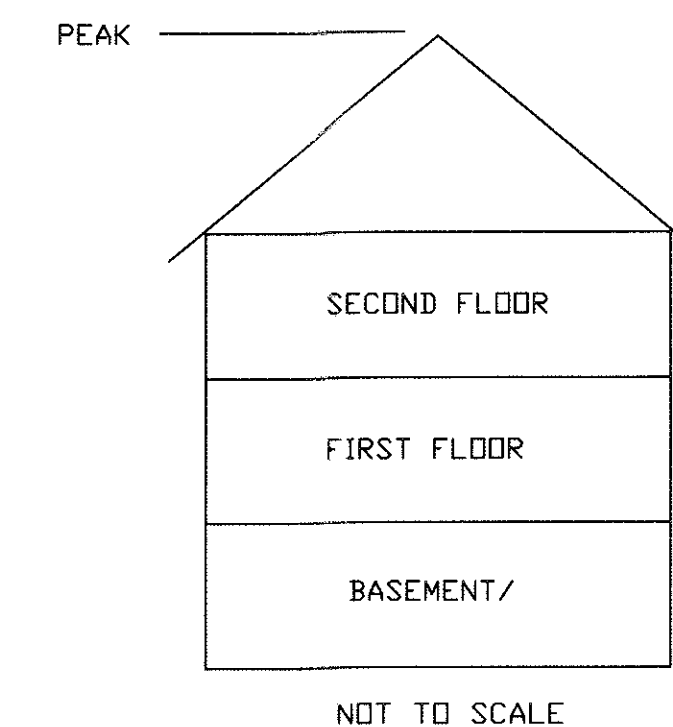

I, James M. Lavelle L.L.S., licensed land surveyor, hereby certify that this plan fully and accurately depicts the location and dimensions of the unit and existing improvements shown thereon and, to the extent feasible, all easements appurtenant thereto; and that the unit depicted thereon have been substantially completed, unless otherwise noted, and that this plan complies with the provisions of RSA 356-B:20, I, II and V.

James M. Lavelle
LICENSED LAND SURVEYOR
6/24/20
DATE

"I CERTIFY THAT THIS SURVEY PLAT IS NOT A SUBDIVISION PURSUANT TO THIS TITLE AND THAT THE LINES OF STREETS AND WAYS SHOWN ARE THOSE OF PUBLIC OR PRIVATE STREETS OR WAYS ALREADY ESTABLISHED AND THAT NO NEW WAYS ARE SHOWN."

DATE: 6/24/20 *James M. Lavelle*

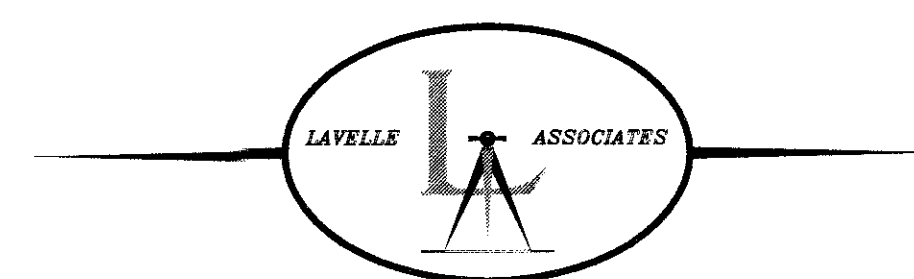
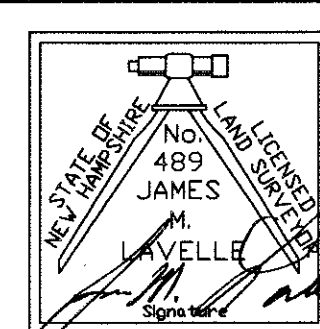

PREPARED BY
JAMES M. LAVELLE, LLS
2 STARWOOD DRIVE
HAMPSTEAD, NH 03841
TEL. (603) 329-6851

Declarant/Owners of Record:

**CAPRI REALTY AND
MANAGEMENT LLC**
52 COLBY ROAD
DANVILLE, NH 03819

Date: APRIL 7, 2020