



HISTORIC PRESERVATION ASSISTANCE PROJECT

Strafford Rockingham Regional Council

1 Water Street, Exeter, New Hampshire

Phone: (603) 778-0885

TOWN: Kingston	COUNTY: Rockingham	UTM: Z 19 /E 332475 /N 4755125
SURVEY NUMBER: 14 *		USGS QUAD: Kingston Quad 7.5' series
COMMON NAME: Sykes House		FUNCTIONAL TYPE: Commercial
HISTORIC NAME: General Store		PRESENT USE: Residential
LOCATION: North side of Bartlett St.		ARCHITECT/BUILDER: Unknown
OWNER: Ron & Anastasia Sykes		CONDITION: Exc. <input checked="" type="checkbox"/> Good <input type="checkbox"/> Fair <input type="checkbox"/> Poor <input type="checkbox"/> Ruins <input type="checkbox"/>
ADDRESS: 8 Bartlett Street, Kingston, NH		INTEGRITY: Original Site <input checked="" type="checkbox"/> Moved <input type="checkbox"/> (When:)
MAP & PARCEL #: U-9/13		Major alterations & date: Victorian era
DATE: c. 1870		remodeled, dates unknown
SOURCE: Inspection		LEVEL/SIGNIFICANCE: Natl <input type="checkbox"/> State <input type="checkbox"/> Local <input checked="" type="checkbox"/>
STYLE: Greek Revival		

GENERAL DESCRIPTION: Structural System

1. FOUNDATION: Stone ☐ Brick ☒ Concrete ☐ Concrete Block ☐
2. WALL STRUCTURE: Wood Frame ☐ Post & Beam ☐ Ballon Frame ☐ Other ☐ Transitional Frame ☐
Load Bearing Masonry ☐ Stone ☐ Brick ☐ Concrete Block ☐ Other ☐
Metal ☐ Iron ☐ Steel ☐ Other ☐
3. WALL COVERING: Clapboard ☒ Wood Shingle ☐ Board & Batten ☐ Shiplap ☐ Aluminum ☐
Novelty ☐ Stucco ☐ Stone ☐ Brick ☐ Sheet Metal ☐ Asphalt Shingles ☐ Vinyl ☐
Asphalt Sheeting ☐ Composite Board ☐ Other ☐
4. ROOF SHEATHING: Wood Shingle ☐ Asphalt Shingle ☒ Standing Seam Tim ☐ Slate ☐
Pressed Metal ☐ Sheet Metal ☐ Rolled Asphalt ☐ Other ☐
5. ENGINEERING STRUCTURE:
6. OTHER:
of Stories 2 1/2 # of Bays 4x7 Approx. Dimensions 25' x 30'
Roof Style: Gable ☐ Hip ☐ Gambrel ☐ Flat ☐ Shed ☐ Mansard ☐ Jerkinhead ☐
Monitor ☐ Sawtooth ☐ Other ☐
Appendages: Porches ☐ Towers ☐ Dormers ☐ Bay Windows ☐ Ells ☐ Chimneys ☐
Wings ☐ Cupolas ☐ Sheds ☐ Garage ☐ Other ☐
Entry Location: Center ☐ Sidehall ☐ Other ☐

MAP (Indicate North in circle):

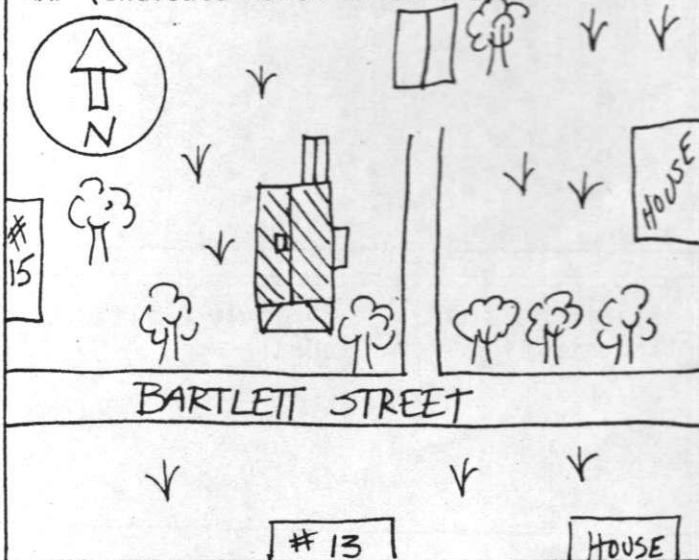

PHOTO

Description of View: Front-south
Side-eastPhotographer: H. Bubert
Negative with: S.R.R.C.
Negative File Number: K-80-5-c/18-18A

ADDITIONAL ARCHITECTURAL AND STRUCTURAL DESCRIPTION:

The Sykes House is a Greek Revival style structure featuring a hip-roofed veranda (Victorian era) along its gable-end facade.

The sidehall entry has a 4-panelled door, with one light sheltered by a 1-story hip-roofed veranda supported by turned posts. The veranda is lined by balusters and railings. A 1-story, gable-roofed porch supported by round posts is located on the east elevation. All of the windows are two-over-one and some have projecting caps. The medium-pitch roof is topped by a narrow chimney with a corbelled and the eaves treatment consists of a boxed cornice with a wide plain frieze and gable-end returns. The main block rests on a brick foundation.

A 1-story, gable-roofed ell with two-over-one windows and clapboard and wood shingle siding extends to the north.

RELATED STRUCTURES AND CONTEXT: There is a 1-story, gable-roofed garage located to the northeast.

BOUNDARY AND ACREAGE DESCRIPTION: .2 acres bounded to the N-Normand, S-Bartlett Street, E-Poloquin, W-Normand.

REFERENCES:

Kingston Historic Advisory Committee; interviews with members, spring 1980

1892 Map

STATEMENT OF SIGNIFICANCE (Evaluation & Historical Associations):

The E. Shaw House is the oldest of a group of five related vernacular houses on Bartlett Street. It is also the largest and has Greek Revival detailing. It may have served as the inspiration for the others and is certainly the anchor in the grouping. Its commercial history contributes to the expansion of the town center to Bartlett Street in the late 19th century.

Historic Associations: Map Data: 1892 - E. Shaw

At one time it was George Emery's grocery store (no feed); at another time, L. S. Bartlett had a shoe shop and store here.

MAP DATA 1892-E. Shaw

SURROUNDING ENVIRONMENT: Open Land__ Woodland__ Scattered Bldgs__ Moderately Built Up__
Densely Built Up__ Residential__ Commercial__ Industrial__ Agricultural__
Roadside Strip Development__ Other__

Recorded By: Herb Eubert
Scott Kovak

Date: 1/4/80