

HISTORIC PRESERVATION ASSISTANCE PROJECT

Strafford Rockingham Regional Council

1 Water Street, Exeter, New Hampshire

Phone: (603) 778-0885

TOWN: Kingston	COUNTY: Rockingham	UTM: Z 19 /E 332525 /N 4755400
SURVEY NUMBER: 35*		USGS QUAD: Kingston Quad 7.5' series
COMMON NAME: Herrick House		FUNCTIONAL TYPE: Residential
HISTORIC NAME: The J. Lyford House		PRESENT USE: Residential
LOCATION: S side of Depot Rd., .20 miles E of the intersection of Main Street.		ARCHITECT/BUILDER: J. Alfred Lyford
OWNER: Wilbur & Karin Herrick		CONDITION: Exc. <input checked="" type="checkbox"/> Good <input type="checkbox"/> Fair <input type="checkbox"/> Poor <input type="checkbox"/> Ruins
ADDRESS: 15 Depot Rd., Kingston, NH		INTEGRITY: Original Site <input checked="" type="checkbox"/> Moved <input type="checkbox"/> (When:)
MAP & PARCEL #: U-9/27		Major alterations & date: Use to be a
DATE: c. 1890		barn where garage is now.
SOURCE: Inspection		LEVEL/SIGNIFICANCE: Natl State Local <input checked="" type="checkbox"/>
STYLE: Vernacular		

GENERAL DESCRIPTION: Structural System

1. FOUNDATION: Stone ☒ Brick ☐ Concrete ☐ Concrete Block ☐
2. WALL STRUCTURE: Wood Frame ☐ Post & Beam ☐ Ballon Frame ☒ Other ☐
Load Bearing Masonry ☐ Stone ☐ Brick ☐ Concrete Block ☐ Other ☐
Metal ☐ Iron ☐ Steel ☐ Other ☐
3. WALL COVERING: Clapboard ☒ Wood Shingle ☐ Board & Batten ☐ Shiplap ☐ Aluminum ☐
Novelty ☐ Stucco ☐ Stone ☐ Brick ☐ Sheet Metal ☐ Asphalt Shingles ☐ Vinyl ☐
Asphalt Sheeting ☐ Composite Board ☐ Other ☐
4. ROOF SHEATHING: Wood Shingle ☐ Asphalt Shingle ☒ Standing Seam Tim ☐ Slate ☐
Pressed Metal ☐ Sheet Metal ☐ Rolled Asphalt ☐ Other ☐
5. ENGINEERING STRUCTURE:
6. OTHER:
of Stories 2 1/2 # of Bays 3x3 Approx. Dimensions 25' x 30'
Roof Style: Gable ☐ Hip ☐ Gambrel ☐ Flat ☐ Shed ☐ Mansard ☐ Jerkinhead ☐
Monitor ☐ Sawtooth ☐ Other ☐
Appendages: Porches 2 Towers ☐ Dormers ☐ Bay Windows 1 Ells 1 Chimneys 1
Wings ☐ Cupolas ☐ Sheds ☐ Garage ☐ Other ☐
Entry Location: Center ☐ Sidehall ☒ Other ☐

MAP (Indicate North in circle):

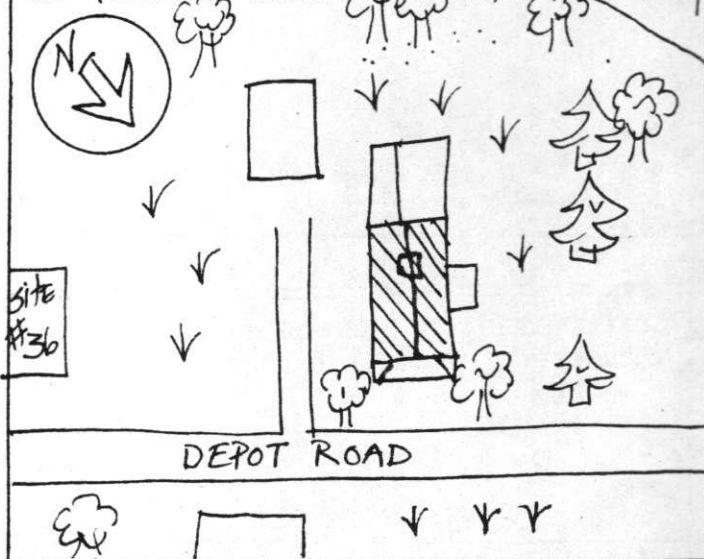

PHOTO



Description of View: Front-northeast
Side-southeast

Photographer: Herb Bubert
Negative with: S.R.R.C.
Negative File Number: K-80-7c/8-8A

ADDITIONAL ARCHITECTURAL AND STRUCTURAL DESCRIPTION:

The Herrick House is a 2 $\frac{1}{2}$ -story, late nineteenth century vernacular structure. The sidehall entry has a Victorian era door sheltered by a 1-story, screened porch. A 2-story, three-sided, bay window is located on the southeast elevation. Most of the windows have two-over-two sash with shutters (some new six-over-six windows). The medium-pitched roof is topped by a narrow chimney and the eaves treatment consists of a boxed cornice with gable-end returns. The house rests on a stone foundation.

A 2 $\frac{1}{2}$ -story, gable-roofed ell projects to the southwest. It has a 1-story, shed-roofed, open porch on its southeast elevation. There is a 1-story, enclosed porch on the northwest elevation of the main block.

RELATED STRUCTURES AND CONTEXT: To the southeast of the house is a 1 $\frac{1}{2}$ -story, gambrel-roofed barn/garage.

BOUNDARY AND ACREAGE DESCRIPTION: .6 acres bounded to the N-Town of Kingston, S-Sanborn, E-Depot Road, W-Cemetery.

REFERENCES: Kingston Historic Advisory Committee; interviews with members, spring 1980
1892 Map -- J. Lyford

STATEMENT OF SIGNIFICANCE (Evaluation & Historical Associations):

The J. Lyford House is a typical example of late 19th century vernacular residential construction. It is nicely proportioned and most of its original detail survives. J. Lyford, the builder, was a local carpenter and built this house for his home.

Historic Associations: The house was built by carpenter Lyford. At one time, there was a dressmaking shop on the site; at another, it was a 2-family house. In c. 1942, Leonard Sanborn bought the house from Lyford's estate.

MAP DATA 1892-J. Lyford

SURROUNDING ENVIRONMENT: Open Land__ Woodland__ Scattered Bldgs__ Moderately Built Up__
Densely Built Up__ Residential__ Commercial__ Industrial__ Agricultural__
Roadside Strip Development__ Other__

Recorded By: Herb Bubert
Scott Novak

Date: 1/17/80

