

## HISTORIC PRESERVATION ASSISTANCE PROJECT

Strafford Rockingham Regional Council

1 Water Street, Exeter, New Hampshire

Phone: (603) 778-0885

TOWN: Kingston	COUNTY: Rockingham	UTM: Z19 /E 332550 /N 4755500
SURVEY NUMBER: 39*		USGS QUAD: Kingston Quad 7.5' series
COMMON NAME: The Roberts House		FUNCTIONAL TYPE: Residential
HISTORIC NAME: "Old Wilkinson Place"		PRESENT USE: Residential
LOCATION: NW side Depot Rd., .1 Miles E. of Intersection Main & Depot		ARCHITECT/BUILDER: Unknown
OWNER: Ralph & Marcia Roberts		CONDITION: Exc. <u>Goody</u> Fair <u>Poor</u> Ruins
ADDRESS: 6 Depot Road, Kingston, NH		INTEGRITY: Original Site <u>X</u> Moved (When: )
MAP & PARCEL #: U10,33		Major alterations & date: Remodeled c.1860/1870, and at many other times.
DATE: C. 1820		LEVEL/SIGNIFICANCE: Natl State Local <u>X</u>
SOURCE: Assessors Office, Kingston		
STYLE: Federal		

GENERAL DESCRIPTION: Structural System

1. FOUNDATION: Stone Brick X Concrete Concrete Block
2. WALL STRUCTURE: Wood Frame Post & Beam X Ballon Frame Other  
Load Bearing Masonry Stone Brick Concrete Block Other  
Metal Iron Steel Other
3. WALL COVERING: Clapboard Wood Shingle X Board & Batten Shiplap Aluminum  
Novelty Stucco Stone Brick Sheet Metal Asphalt Shingles Vinyl  
Asphalt Sheeting Composite Board Other
4. ROOF SHEATHING: Wood Shingle Asphalt Shingle X Standing Seam Tim Slate  
Pressed Metal Sheet Metal Rolled Asphalt Other
5. ENGINEERING STRUCTURE:
6. OTHER:  
# of Stories 2 # of Bays 5X2 Approx. Dimensions 25' X 15'  
Roof Style: Gable X Hip Gambrel Flat Shed Mansard Jerkinhead  
Monitor Sawtooth Other  
Appendages: Porches 1 Towers Dormers Bay Windows Ells 1 Chimneys 2  
Wings 2 Cupolas Sheds Garage Other  
Entry Location: Center X Sidehall Other

MAP (Indicate North in circle):

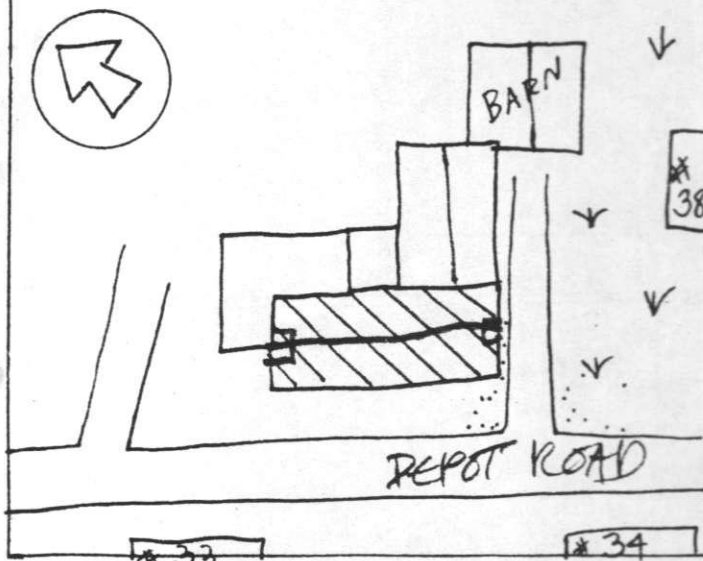

PHOTO



## Description of View:

Front, South Side, East

Photographer: Scott Novak

Negative with: S.R.R.C.

Negative File Number: K-80-5-C/23-23A

**ADDITIONAL ARCHITECTURAL AND STRUCTURAL DESCRIPTION:**

The Roberts House is a 2-story twin-chimney Federal style structure. The center entry is sheltered by a 1-story vestibule with a multi-light door. Windows are one-over-one and two-over-two with plain surrounds. The low-pitched roof is topped by two chimneys with corbeled caps. The cornice treatment consists of close raking eaves and close molded lateral eaves.

The 2 story ell has the same windows, siding, and eaves treatment as the main block. There is a 1-story wing/ell on the north and east elevations that has the same siding and cornice treatment.

**RELATED STRUCTURES AND CONTEXT:**

The attached barn has a steeply pitched gable roof, a boxed cornice and wood shingle siding.

**BOUNDARY AND ACREAGE DESCRIPTION:** .9 Acres. Bounded to the N. by Bartlett, E. by Martin S. by Martin, W. by Depot Road.

**REFERENCES:** Kingston Historic Advisory Committee; interviews with members, spring 1980  
1892 Map -- Mrs. M. A. Martin

**STATEMENT OF SIGNIFICANCE (Evaluation & Historical Associations):**

The proportions of the "Old Wilkinson Place" are tall and narrow, indicating construction during the federal period, although the brick foundation (rare before 1850) and absence on the 1856 map would seem to belie this. Whatever the reason, this house is a contributing structure in the Historic District.

MAP DATA 1892-Mrs. M A Martin

**SURROUNDING ENVIRONMENT:** Open Land ☐ Woodland ☐ Scattered Bldgs ☐ Moderately Built Up ☒  
Densely Built Up ☐ Residential ☒ Commercial ☐ Industrial ☐ Agricultural ☐  
Roadside Strip Development ☐ Other ☐

Recorded By: Scott Novak, Herb Bubert

Date: 12/19/79

