

HISTORIC PRESERVATION ASSISTANCE PROJECT

Strafford Rockingham Regional Council

1 Water Street, Exeter, New Hampshire

Phone: (603) 778-0885

TOWN: Kingston	COUNTY: Rockingham	UTM: Z19 /E332500 /N4755575
SURVEY NUMBER: 40*		USGS QUAD: Kingston Quad 7.5' series
COMMON NAME: The Bartlett House		FUNCTIONAL TYPE: Residential
HISTORIC NAME: S. H. Towle House		PRESENT USE: Residential (3 apartments)
LOCATION: NE side Depot Rd., .05 mi. E. intersection Main & Depot		ARCHITECT/BUILDER: Unknown
OWNER: Marilyn Bartlett		CONDITION: Exc. <input checked="" type="checkbox"/> Good <input type="checkbox"/> Fair <input type="checkbox"/> Poor <input type="checkbox"/> Ruins <input type="checkbox"/>
ADDRESS: 4 Depot Road, Kingston, NH		INTEGRITY: Original Site <input checked="" type="checkbox"/> Moved <input type="checkbox"/> (When: <input type="text"/>)
MAP & PARCEL #: U10 32		Major alterations & date: Unknown
DATE: c. 1870		
SOURCE: Inspection		
STYLE: Stick Style		LEVEL/SIGNIFICANCE: Natl <input type="checkbox"/> State <input type="checkbox"/> Local <input checked="" type="checkbox"/>

GENERAL DESCRIPTION: Structural System

- FOUNDATION: Stone ☐ Brick ☒ Concrete ☐ Concrete Block ☐
- WALL STRUCTURE: Wood Frame ☐ Post & Beam ☐ Ballon Frame ☒ Other ☐
Load Bearing Masonry ☐ Stone ☐ Brick ☐ Concrete Block ☐ Other ☐
Metal ☐ Iron ☐ Steel ☐ Other ☐
- WALL COVERING: Clapboard ☒ Wood Shingle ☐ Board & Batten ☐ Shiplap ☐ Aluminum ☐
Novelty ☐ Stucco ☐ Stone ☐ Brick ☐ Sheet Metal ☐ Asphalt Shingles ☐ Vinyl ☐
Asphalt Sheeting ☐ Composite Board ☐ Other ☐
- ROOF SHEATHING: Wood Shingle ☐ Asphalt Shingle ☒ Standing Seam Tin ☐ Slate ☐
Pressed Metal ☐ Sheet Metal ☐ Rolled Asphalt ☐ Other ☐
- ENGINEERING STRUCTURE:
- OTHER:
of Stories 2 # of Bays 5X2 Approx. Dimensions 25' X 35'
Roof Style: Gable ☒ Hip ☐ Gambrel ☐ Flat ☐ Shed ☐ Mansard ☐ Jerkinhead ☐
Monitor ☐ Sawtooth ☐ Other ☐
Appendages: Porches ☐ Towers ☐ Dormers 3 Bay Windows ☐ Ells 1 Chimneys ☐
Wings 1 Cupolas ☐ Sheds ☐ Garage 1 Other ☐
Entry Location: Center ☐ Sidehall ☐ Other Side

MAP (Indicate North in circle):

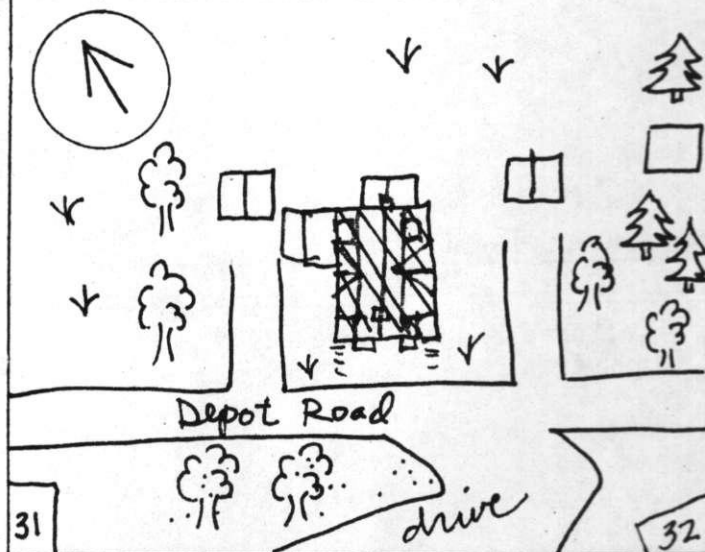

PHOTO



Description of View:

Front (s) Side (w)

Photographer: Herb Bubert

Negative with: S.R.R.C.

Negative File Number: K-80 2-C 18A-19

ADDITIONAL ARCHITECTURAL AND STRUCTURAL DESCRIPTION:

The Bartlett house is an unusual 2 $\frac{1}{2}$ story, stick style structure with gable-front orientation to the road. Notable for its symetry, it is balanced by two side entrys, whose porches extend to repeat the slope of the roof, creating a layered effect. The symetry is also accentuated by the fenestration which features two pairs of 1/1 windows on the first and second stories. The first story windows are sheltered by shedlike window hoods supported by truss brackets. The structure and wooden fabric of the house have been emphasized by surface boards applied over the clapboards in a sill course, belt course, corner boards, and in particular the facia at the eaves on both main block and porch.

The symetry is broken by two offset gables on the northwest and southeast elevations. They have been treated with the same eaves as the main block. There is a shed-roofed dormer on the east.

A 1-story, gable-roofed ell has clapboard siding, a victorian era door, two-over-two windows, and rests on a brick foundation. A 1-story, shed-roofed wing projects to the northwest.

RELATED STRUCTURES AND CONTEXT:

On each side of the house is a separate 1-story garage. A 1-story shed is located to the northeast of the house.

BOUNDARY AND ACREAGE DESCRIPTION: 3.4 Acres. Bounded to the N. and E. by Bartlett, S. by Roberts, Martin, W. by Town of Kingston, Depot Road.

REFERENCES: Kingston Historic Advisory Committee; interviews with members, spring 1980

STATEMENT OF SIGNIFICANCE (Evaluation & Historical Associations):

The H. Towle House is the finest residential example of Stick Style architecture in Kingston. (The Kingston Church on the Plains is a noteworthy ecclesiastical example, and the Watson Academy in Epping is a similarly inspired academic example). The architecture would be better displayed by painting the clapboard wall surface and flat stick trim in contrasting colors.

Historic Associations: Owned c. 1910 by Dr. Sweeney; Dr. Zuck, the dentist, owned the house in the 1960's.

Map Data: 1892: Mrs. H. Towle

MAP DATA 1892-Mrs. H. Towle

SURROUNDING ENVIRONMENT: Open Land__ Woodland__ Scattered Bldgs X Moderately Built Up__
Densely Built Up__ Residential__ Commercial__ Industrial__ Agricultural__
Roadside Strip Development__ Other__

Recorded By: Scott Novak, Herb Bubert

Date: 12/19/79

