

HISTORIC PRESERVATION ASSISTANCE PROJECT

Strafford Rockingham Regional Council

1 Water Street, Exeter, New Hampshire

Phone: (603) 778-0885

TOWN: Kingston COUNTY: Rockingham
 SURVEY NUMBER: 42
 COMMON NAME: Burbank House
 HISTORIC NAME: Sanborn House
 LOCATION: E side of Main St., .07 miles N
of intersection of Main & Depot
 OWNER: Daniel & Barbara Burbank
 ADDRESS: 171 Main Street, Kingston, NH
 MAP & PARCEL #: 1U-10/30
 DATE: c. 1780 (c.1755 for original house)
 SOURCE: Inspection
 STYLE: Federal

UTM: Z 19/E 332475 /N 4755675
 USGS QUAD: Kingston Quad 7.5' Series
 FUNCTIONAL TYPE: Farmhouse
 PRESENT USE: Residential
 ARCHITECT/BUILDER: Unknown
 CONDITION: Exc. X Good Fair Poor Ruins
 INTEGRITY: Original Site X Moved _____
(When: _____)
 Major alterations & date: Heavy alterations
c. 1800-1820; interior modification c.1940
 LEVEL/SIGNIFICANCE: Nat'l State Local X

GENERAL DESCRIPTION: Structural System

1. FOUNDATION: Stone X Brick Concrete Concrete Block Granite slab
2. WALL STRUCTURE: Wood Frame Post & Beam Ballon Frame X Other
Load Bearing Masonry Stone Brick Concrete Block Other
Metal Iron Steel Other
Other
3. WALL COVERING: Clapboard X Wood Shingle Board & Batten Shiplap Aluminum
Novelty Stucco Stone Brick Sheet Metal Asphalt Shingles Vinyl
Asphalt Sheeting Composite Board Other
4. ROOF SHEATHING: Wood Shingle Asphalt Shingle X Standing Seam Tim Slate
Pressed Metal Sheet Metal Rolled Asphalt Other
5. ENGINEERING STRUCTURE:
6. OTHER:
of Stories 2 1/2 # of Bays 5x3 Approx. Dimensions 35' x 30'
Roof Style: Gable X Hip Gambrel Flat Shed Mansard Jerkinhead
Monitor Sawtooth Other
Appendages: Porches 1 Towers Dormers Bay Windows Ells 1 Chimneys 2
Wings Cupolas Sheds 2 Garage Other Barn
Entry Location: Center X Sidehall Other

MAP (Indicate North in circle):

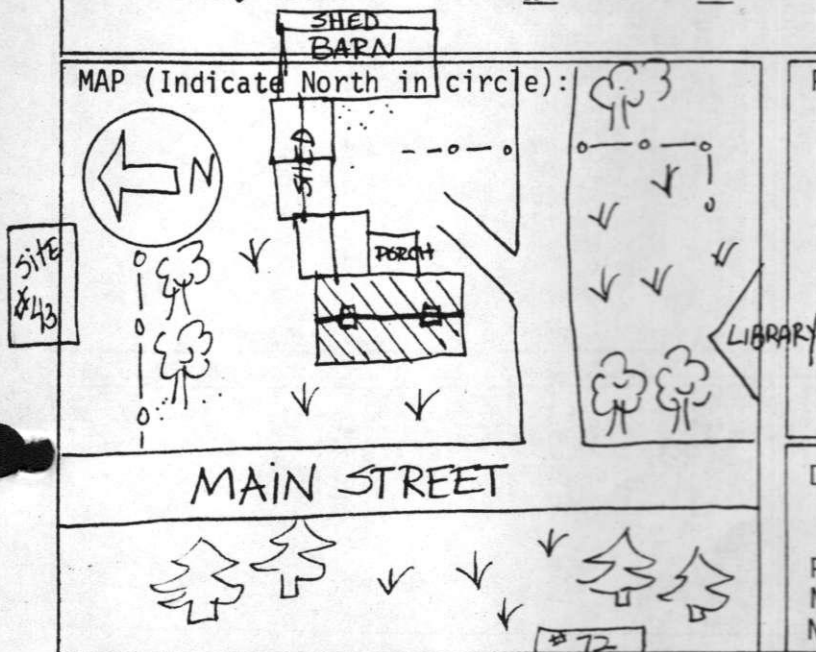

PHOTO



Description of View: Front-west
Side-east

Photographer: Scott Novak
 Negative with: S.R.R.C.
 Negative File Number: K-80-2-C/20A-21

ADDITIONAL ARCHITECTURAL AND STRUCTURAL DESCRIPTION:

The Burbank house is a twin chimney Federal style structure which was remodelled during the Greek Revival period. The center entry has a six-panel door with sidelights extending half its height and is flanked by narrow pilasters rising to a full entablature. All of the windows have six-over-six sash and are framed by shutters. Those on the first story and in the gable-ends have projecting caps. The medium-pitched roof is topped by large twin chimneys and the roofline has a boxed cornice with a narrow frieze and gable-end returns. The main block rests on a granite slab foundation.

A 1½-story, gable-roofed ell extends to the east. It has six-over-six windows and a granite slab foundation. To the south of this ell is an open porch with a shed roof supported by square columns.

Extending east from the ell is an attached 1-story shed with clapboard siding, six-over-six windows and a fieldstone foundation. Another 1-story shed extends from the first and connects with the barn.

RELATED STRUCTURES AND CONTEXT: To the east is a 1½-story, gable-roofed barn with a large sliding door topped by a transom light. The front facade is clapboarded, and the sides of the barn are wood shingled. An attached shed extends to the east. Both of the structures rest on a fieldstone foundations.

BOUNDARY AND ACREAGE DESCRIPTION: 1.84 acres bounded to the N-Chase, S-Nicholas, Library, Bartlett, Martin, E-Rte. 125, W-Main Street.

REFERENCES: Kingston Historic Advisory Committee; interviews with members, spring 1980
1856 Map -- N. Parker; 1892 Map -- F. A. Woodman; Kingston Historical Society,
"The History of Kingston: 1694-1969." Kingston Improvement and Historic Society, 1969.
Sanborn, Leonard, "The Sanborns of Kingston, New Hampshire" typed manuscripts.

STATEMENT OF SIGNIFICANCE (Evaluation & Historical Associations):

The Fifield/Sanborn House is a twin chimney, 2½ story, 5 bay structure which seems to have been inspired by the Josiah Bartlett House. While the site is documented to 1755, the current structure is clearly Federal in style. The 5x3 bay configuration speaks of a large and substantial structure which could easily house the inn and tavern. Historic Associations: In 1755, John Fifield built a house on this site. The present house either replaced or was built around the original about 1780, and was perhaps patterned after the Josiah Bartlett House. Jacob Hook Sanborn (1173-1848) kept a tavern and inn here. In the 1930's, it was a luncheon place called Bradless Inn. In the 1940's, the house was part of the summer tourist business.

MAF DATA 1892-F A Woodman

1856-N. Parker

SURROUNDING ENVIRONMENT: Open Land ☐ Woodland ☐ Scattered Bldgs ☐ Moderately Built Up ☐
Densely Built Up ☐ Residential ☐ Commercial ☐ Industrial ☐ Agricultural ☐
Roadside Strip Development ☐ Other ☐

Recorded By: Scott Novak
Herb Bubert

Date: 12-20-79

