

Strafford Rockingham Regional Council

1 Water Street, Exeter, New Hampshire

Phone: (603) 778-0885

TOWN: Kingston	COUNTY: Rockingham
SURVEY NUMBER: 43	
COMMON NAME: Chase House	
HISTORIC NAME: O. H. Key House	
LOCATION: E side of Main Street, .1 mile N of intersection of Main & Depot.	
OWNER: Lorraine H. Chase	
ADDRESS: 173 Main Street, Kingston, NH	
MAP & PARCEL #: U-10/29	
DATE: c. 1870	
SOURCE: Inspection	
STYLE: Italianate	

UTM: Z 19 /E 332475 /N 4755725
USGS QUAD: Kingston Quad 7.5' series
FUNCTIONAL TYPE: Farmhouse
PRESENT USE: Residential - Apartments
ARCHITECT/BUILDER: Unknown
CONDITION: Exc. <u>Good</u> Fair Poor Ruins
INTEGRITY: Original Site <u>X</u> Moved (When:)
Major alterations & date:
LEVEL/SIGNIFICANCE: Natl State Local <u>X</u>

GENERAL DESCRIPTION: Structural System

1. FOUNDATION: Stone X Brick X Concrete Concrete Block
2. WALL STRUCTURE: Wood Frame Post & Beam Ballon Frame X Other
Load Bearing Masonry Stone Brick Concrete Block Other
Metal Iron Steel Other
3. WALL COVERING: Clapboard X Wood Shingle Board & Batten Shiplap Aluminum
Novelty Stucco Stone Brick Sheet Metal Asphalt Shingles Vinyl
Asphalt Sheeting Composite Board Other
4. ROOF SHEATHING: Wood Shingle Asphalt Shingle X Standing Seam Tin Slate
Pressed Metal Sheet Metal Rolled Asphalt Other
5. ENGINEERING STRUCTURE:
6. OTHER:
of Stories 2 1/2 # of Bays 3 X 3 Approx. Dimensions 25' x 30'
Roof Style: Gable X Hip Gambrel Flat Shed Mansard Jerkinhead
Monitor Sawtooth Other 1 on ell
Appendages: Porches Towers Dormers Bay Windows Ells 2 Chimneys 1 on M.B.
Wings Cupolas Sheds Garage Other Barn converted to apartments
Entry Location: Center Sidehall X Other

MAP (Indicate North in circle):

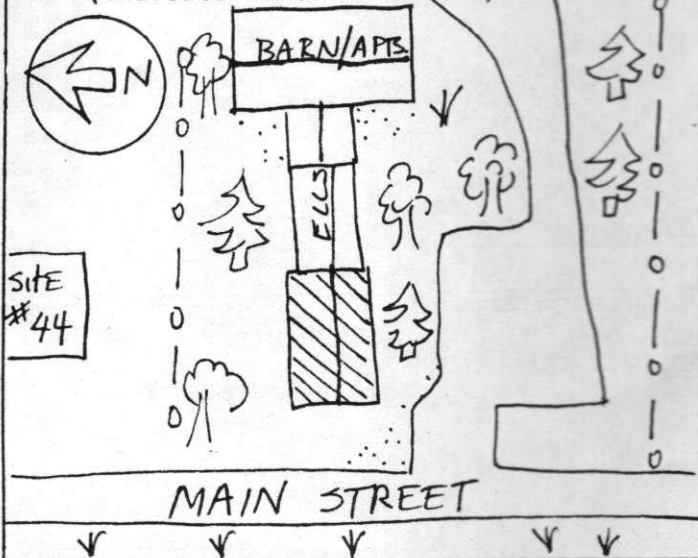

PHOTO



Description of View: Front-west
Side-south

Photographer: Scott Novak
Negative with: S.R.R.C.
Negative File Number: K-80-2c/21A-22

ADDITIONAL ARCHITECTURAL AND STRUCTURAL DESCRIPTION:

The Chase House is a 2½-story Italianate style house. The sidehall entry has a four-panelled door, with two wooden panels below and two round-arched lights above, and is sheltered by a flat-roofed door hood supported by heavy brackets. All of the windows are two-over-two with projecting caps. The medium-pitch roof has projecting, bracketed eaves with a boxed cornice and gable-end returns. Wide panelled pilasters frame the main block of the house. The main block rests on a brick and fieldstone foundation.

A 2-story, gable-roofed ell extends to the east. It has clapboard siding, two-over-two and two-over-one windows, and a fieldstone foundation. Another 2-story ell extends to the east of the first. It has a flat roof, clapboard siding, and rests on a concrete block foundation. The second ell connects with a large 2½-story, four-by-three bay, gable-roofed structure which appears to have been the barn. It has been remodeled and now contains apartments.

RELATED STRUCTURES AND CONTEXT:

BOUNDARY AND ACREAGE DESCRIPTION: .6 acres bounded to the N-Penney, Bakie School, S-Bartlett, E-Mason, W-Main Street.

REFERENCES: Kingston Historic Advisory Committee; interviews with members, spring 1980
1893 Map -- O. H. Key

STATEMENT OF SIGNIFICANCE (Evaluation & Historical Associations):

The O. H. Key House is a fine example of vernacular late Italianate style as exemplified by the 2½ story, sidehall configuration and detailing.

Historic Associations: In the 1890's, there was a post office in the building. In the early 20th century, a woman recluse, whose husband had a team, lived here. Local legend says the house was haunted.

MAP DATA 1892-O.H. Key

SURROUNDING ENVIRONMENT: Open Land ☐ Woodland ☐ Scattered Bldgs ☐ Moderately Built Up ☒
Densely Built Up ☐ Residential ☒ Commercial ☐ Industrial ☐ Agricultural ☐
Roadside Strip Development ☐ Other ☐

Recorded By: Herb Eubert
Scott Novak

Date: 12-20-79

