

HISTORIC PRESERVATION ASSISTANCE PROJECT

Strafford Rockingham Regional Council

1 Water Street, Exeter, New Hampshire

Phone: (603) 778-0885

TOWN: Kingston	COUNTY: Rockingham	UTM: Z 19 /E 332575 /N 4756000
SURVEY NUMBER: 48*		USGS QUAD: Kingston Quad 7.5' series
COMMON NAME: Shalett House		FUNCTIONAL TYPE: Dwelling
HISTORIC NAME: J. Goodrich House		PRESENT USE: Residential
LOCATION: E side of Main St., .29 miles N of inter. Main & Depot.		ARCHITECT/BUILDER: Unknown
OWNER: Stanley & Myra Shalett		CONDITION: Exc. <u>Good</u> Fair <u>X</u> Poor <u>Ruins</u>
ADDRESS: 183 Main Street, Kingston, NH		INTEGRITY: Original Site <u>X</u> Moved <u> </u> (When: <u> </u>)
MAP & PARCEL #: R-34/75		Major alterations & date: Aluminum siding applied date unknown
DATE: c. 1876		LEVEL/SIGNIFICANCE: Natl <u> </u> State <u> </u> Local <u>X</u>
SOURCE: Inspection		
STYLE: Mansard		

GENERAL DESCRIPTION: Structural System

- FOUNDATION: Stone Brick X Concrete Concrete Block
- WALL STRUCTURE: Wood Frame Post & Beam Ballon Frame X Other
Load Bearing Masonry Stone Brick Concrete Block Other
Metal Iron Steel Other
- WALL COVERING: Clapboard Wood Shingle Board & Batten Shiplap Aluminum X
Novelty Stucco Stone Brick Sheet Metal Asphalt Shingles Vinyl
Asphalt Sheeting Composite Board Other
- ROOF SHEATHING: Wood Shingle Asphalt Shingle X Standing Seam Tin Slate
Pressed Metal Sheet Metal Rolled Asphalt Other
- ENGINEERING STRUCTURE:
- OTHER:
of Stories 1 1/2 # of Bays 3x2 Approx. Dimensions 30' x 30'
Roof Style: Gable Hip Gambrel Flat Shed Mansard Jerkinhead
Monitor Sawtooth Other
Appendages: Porches 1 Towers Dormers 9 Bay Windows 1 Ells 1 Chimneys 2
Wings Cupolas Sheds Garage Other
Entry Location: Center X Sidehall Other

MAP (Indicate North in circle):

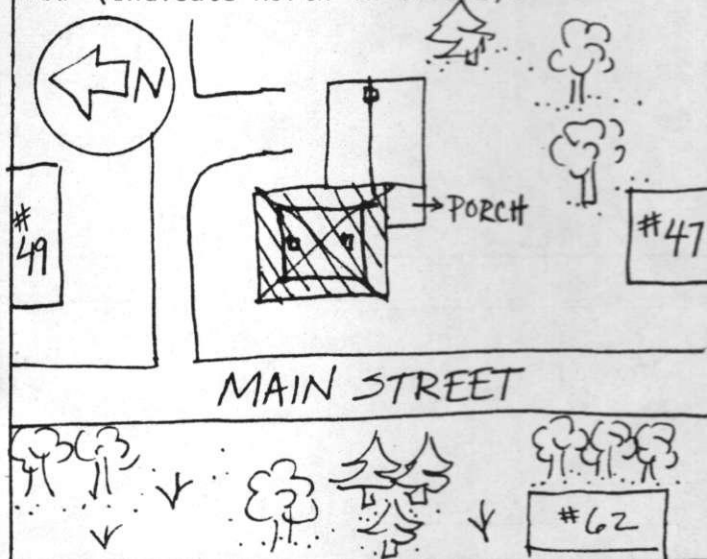

PHOTO



Description of View: Front-west
Side-south

Photographer: Herb Bubert
Negative with: S.R.R.C.
Negative File Number: K-80-20-27-28

ADDITIONAL ARCHITECTURAL AND STRUCTURAL DESCRIPTION:

The Shalett house is a 1½-story Mansard style structure of the late 19th century. The center entry has double-leaf doors, each with two panels and one large light. All of the windows are two-over-two and some have projecting caps. To the right of the entrance is a 1-story, flat-roofed bay window. Nine flat-roofed dormers have been set into the Mansard roof. The main block rests on a brick foundation. To the south is a 1-story, open porch with a hip-roof supported by one tapered square column.

A 1½-story gambrel-roofed ell extends to the east. It has five dormers set into its roof. These dormers are identical to those on the main block. The ell rests on a brick foundation.

RELATED STRUCTURES AND CONTEXT:

BOUNDARY AND ACREAGE DESCRIPTION: 4.8 acres bounded to the N-Martin, S-Evan, Bakie School, E-State of N.H., W-Main Street, Evans, Parker.

REFERENCES: Kingston Historic Advisory Committee; interviews with members, spring 1980

1856 Map -- J. Goodrich
1892 Map -- S. W. Stevens

STATEMENT OF SIGNIFICANCE (Evaluation & Historical Associations):

The J. Goodrich House is one of a pair of Mansard houses on the east side of Main St., the Patten House, Site #48, is the other. These two houses are clearly related as their style is remarkably alike. Both structures appear clearly on the 1856 map, a date which would seem early for this style to appear in Kingston. They may have been remodeled by the same person. Further investigation is necessary to support this theory. As a pair, they are extremely important to the district as the only examples of this style. Both are in need of proper paint colors to complement their architecture.

MAP DATA 1892-S W Stevens 1856-J Goodrich

SURROUNDING ENVIRONMENT: Open Land__ Woodland__ Scattered Bldgs__ Moderately Built Up__
Densely Built Up__ Residential__☒ Commercial__ Industrial__ Agricultural__
Roadside Strip Development__ Other__

Recorded By: Herb Rubert
Scott Novak

Date: 10-22-80

