

HISTORIC PRESERVATION ASSISTANCE PROJECT

Strafford Rockingham Regional Council

1 Water Street, Exeter, New Hampshire

Phone: (603) 778-0885

TOWN: Kingston	COUNTY: Rockingham	UTM: Z 19/E 332625 /N 4756150
SURVEY NUMBER: 51*		USGS QUAD: Haverhill Quad 15' Series
COMMON NAME: Winter House		FUNCTIONAL TYPE: Residential
HISTORIC NAME: C. Nichols House		PRESENT USE: Residential
LOCATION: .38 miles N of inter. Main & Depot E side of Main Street.		ARCHITECT/BUILDER: Unknown
OWNER: Sandy & Debra Winter		CONDITION: Exc. <u>Good</u> X Fair <u>Poor</u> Ruins
ADDRESS: 189 Main St., Kingston, NH		INTEGRITY: Original Site X Moved (When:)
MAP & PARCEL #: R-34/71		Major alterations & date: Remodeled c.1940's
DATE: c. 1880		LEVEL/SIGNIFICANCE: Natl State Local X
SOURCE: Assessor's Office, Kingston		
STYLE: Late 19th century Vernacular		

GENERAL DESCRIPTION: Structural System

1. FOUNDATION: Stone Brick X Concrete Concrete Block
2. WALL STRUCTURE: Wood Frame Post & Beam Ballon Frame X Other Load Bearing Masonry Stone Brick Concrete Block Other Metal Iron Steel Other Other
3. WALL COVERING: Clapboard X Wood Shingle Board & Batten Shiplap Aluminum Novelty Stucco Stone Brick Sheet Metal Asphalt Shingles Vinyl Asphalt Sheeting Composite Board Other
4. ROOF SHEATHING: Wood Shingle Asphalt Shingle X Standing Seam Tim Slate Pressed Metal Sheet Metal Rolled Asphalt Other
5. ENGINEERING STRUCTURE:
6. OTHER:
 - # of Stories 2 1/2 # of Bays 3 Approx. Dimensions 20' x 25' M.B.
 - Roof Style: Gable X Hip Gambrel Flat Shed Mansard Jerkinhead Monitor Sawtooth Other
 - Appendages: Porches 2 Towers Dormers Bay Windows Ells 1 Chimneys 1 Wings Cupolas Sheds 1 Garage 1 Other
 - Entry Location: Center X Sidehall Other

MAP (Indicate North in circle):

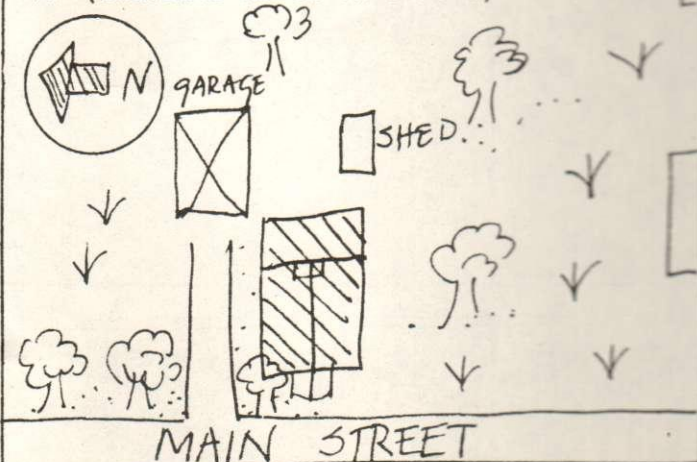

PHOTO

Description of View: Front-west
Side-south

Photographer: Scott Novak

Negative with: S.R.R.C.

Negative File Number: K-80-5-C/26-26A

ADDITIONAL ARCHITECTURAL AND STRUCTURAL DESCRIPTION:

The house is a 2½-story structure, built in the Victorian era, with gable front orientation to the street. The gable-end center entry has a six-panel door with sidelights, and is sheltered by a 1-story, gable-roofed portico supported by square columns. All windows are nine-over-six and the windows in the gable-end have sidelights. Some of the windows have architrave trim and some have plain trim. The medium-pitched roof has a boxed cornice with a wide frieze and gable-end returns supported by wide corner boards. One tall chimney with a corbeled cap rests on the ridge line.

A 2-story, flat-roofed ell to the east has six-over-six windows, the same cornice treatment and siding as the main block, and a brick foundation.

There is a hipped roof, 1-story, enclosed porch along the north elevation. It is five-by-three bays and has the same eaves treatment as the main block.

RELATED STRUCTURES AND CONTEXT: A one story gable-roofed shed to the east has clapboard siding and a vertical board door. A one story garage has a ridge type hip roof, exposed rafters, and clapboard siding. It is located to the northeast.

BOUNDARY AND ACREAGE DESCRIPTION: 6.8 acres bounded to the N-Alberts, S-Saunders, Shatter, E-Magnuson, W-Main Street.

REFERENCES:

1856 Map
1892 Map

STATEMENT OF SIGNIFICANCE (Evaluation & Historical Associations):

The C. Nichols House is on the site of an earlier house. It is a typical example of late 19th century vernacular building. It contributes to the historic significance of Main Street.

MAP DATA: 1856: C. Nichols
1892: F. A. Spofford

MAP DATA 1856-C. Nichols 1892-F A Spofford

SURROUNDING ENVIRONMENT: Open Land__ Woodland__ Scattered Bldgs ☒ Moderately Built Up__
Densely Built Up__ Residential ☒ Commercial__ Industrial__ Agricultural__
Roadside Strip Development__ Other__

Recorded By: Scott Novak

Herb Bubert

Date: 12/21/79

