

HISTORIC PRESERVATION ASSISTANCE PROJECT

Strafford Rockingham Regional Council

1 Water Street, Exeter, New Hampshire

Phone: (603) 778-0885

TOWN: Kingston	COUNTY: Rockingham	UTM: Z 19 /E 332650 /N 4756325
SURVEY NUMBER: 54*		USGS QUAD: Haverhill Quad 15' series
COMMON NAME: The Magnusson House		FUNCTIONAL TYPE: BARN
HISTORIC NAME: Chase Barn		PRESENT USE: 2 FAMILY RESIDENTIAL
LOCATION: North side Main Street, .47 Mi. north of Main & Depot		ARCHITECT/BUILDER: Unknown
OWNER: Theodore & Ruth Magnusson		CONDITION: Exc. <u>Good</u> Fair <u>Poor</u> Ruins
ADDRESS: 194 Main St., Kingston, NH		INTEGRITY: Original Site <u>Moved</u> X From Site 55 (When: Unknown)
MAP & PARCEL #: R34 38		Major alterations & date: 1945-50 changed from barn to residence
DATE: c. 1880 as a barn; c. 1950 as house		LEVEL/SIGNIFICANCE: Natl State Local X
SOURCE: Inspection		
STYLE: Colonial Revival		

GENERAL DESCRIPTION: Structural System

1. FOUNDATION: Stone Brick Concrete Concrete Block xx
2. WALL STRUCTURE: Wood Frame Post & Beam Ballon Frame Other
Load Bearing Masonry Stone Brick Concrete Block Other
Metal Iron Steel Other
3. WALL COVERING: Clapboard X Wood Shingle Board & Batten Shiplap Aluminum
Novelty Stucco Stone Brick Sheet Metal Asphalt Shingles Vinyl
Asphalt Sheeting Composite Board Other
4. ROOF SHEATHING: Wood Shingle Asphalt Shingle xx Standing Seam Tim Slate
Pressed Metal Sheet Metal Rolled Asphalt Other
5. ENGINEERING STRUCTURE:
6. OTHER:
of Stories 2 1/2 # of Bays 6X2 Approx. Dimensions 40' X 20'
Roof Style: Gable x Hip Gambrel Flat Shed Mansard Jerkinhead
Monitor Sawtooth Other
Appendages: Porches 1 Towers Dormers Bay Windows Ells Chimneys 3
Wings Cupolas Sheds 2 Garage Other
Entry Location: Center X Sidehall Other
2 entrys

MAP (Indicate North in circle):

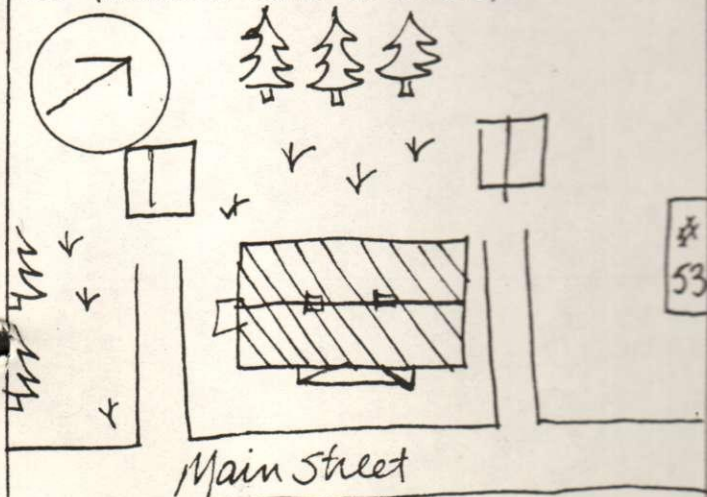

PHOTO



Description of View:

Front-Southeast Side- East

Photographer: Scott Novak

Negative with: S.R.R.C.

Negative File Number: K-80- C 2 -29A

ADDITIONAL ARCHITECTURAL AND STRUCTURAL DESCRIPTION:

The Magnusson House is a 2¹/₂ story Colonial Revival style structure. The two matching center entry doors each have four panels with two lights and are sheltered by a hipped-roof porch supported by square posts. The porch is lined by a railing of square balusters. The first floor front facade windows are eight-over-eight and the rest are six-over-six, most with shutters. The cornice treatment consists of projecting lateral and raking eaves with fascia boards but no soffits. The medium-pitched roof is topped by two central chimneys, and there is an exterior chimney to the South.

RELATED STRUCTURES AND CONTEXT: Two gable roofed, clapboard one car garages.

BOUNDARY AND ACREAGE DESCRIPTION: 1.4 Acres. Bounded to the N. by Harlow, E. by Main Street, S. by Brown Vincent & Page, W. by Levesque.

REFERENCES:**STATEMENT OF SIGNIFICANCE (Evaluation & Historical Associations):**

Site 54 was originally a barn associated with the A. C. Chase House (Site 55). Interestingly, it was remodeled c.1945 and has assumed a residential appearance much like Site 55. It may have been part of the Colonial Revival movement.

SURROUNDING ENVIRONMENT: Open Land__ Woodland__ Scattered Bldgs^x Moderately Built Up__
Densely Built Up__ Residential^x Commercial__ Industrial__ Agricultural__
Roadside Strip Development__ Other__

Recorded By: Scott Novak, Herb Bubert

Date: 12/21/79

