

HISTORIC PRESERVATION ASSISTANCE PROJECT

Strafford Rockingham Regional Council

1 Water Street, Exeter, New Hampshire

Phone: (603) 778-0885

TOWN: Kingston	COUNTY: Rockingham	UTM: Z 19/E 332550 /N 4756125
SURVEY NUMBER: 60*		USGS QUAD: Doverhill Quad 15' Series
COMMON NAME: Gibson House		FUNCTIONAL TYPE: Residential
HISTORIC NAME: A. Brown House		PRESENT USE: Residential
LOCATION: West side of Main St., .35 miles N of intersection Main & Depot.		ARCHITECT/BUILDER: Unknown
OWNER: Walter Gibson		CONDITION: Exc. <input checked="" type="checkbox"/> Good <input type="checkbox"/> Fair <input type="checkbox"/> Poor <input type="checkbox"/> Ruins
ADDRESS: 184 Main Street Kingston, NH.		INTEGRITY: Original Site <input checked="" type="checkbox"/> Moved <input type="checkbox"/> (When:)
MAP & PARCEL #: R-74/20		Major alterations & date:
DATE: c. 1840		
SOURCE: Assessor's Office, Kingston		
STYLE: Greek Revival		LEVEL/SIGNIFICANCE: Natl <input type="checkbox"/> State <input type="checkbox"/> Local <input checked="" type="checkbox"/>

GENERAL DESCRIPTION: Structural System

1. FOUNDATION: Stone ☒ Brick ☐ Concrete ☐ Concrete Block ☐
2. WALL STRUCTURE: Wood Frame ☐ Post & Beam ☐ Ballon Frame ☐ Other ☐
Load Bearing Masonry ☐ Stone ☐ Brick ☐ Concrete Block ☐ Other ☐
Metal ☐ Iron ☐ Steel ☐ Other ☐
3. WALL COVERING: Clapboard ☒ Wood Shingle ☐ Board & Batten ☐ Shiplap ☐ Aluminum ☐
Novelty ☐ Stucco ☐ Stone ☐ Brick ☐ Sheet Metal ☐ Asphalt Shingles ☐ Vinyl ☐
Asphalt Sheeting ☐ Composite Board ☐ Other ☐
4. ROOF SHEATHING: Wood Shingle ☐ Asphalt Shingle ☒ Standing Seam Tim ☐ Slate ☐
Pressed Metal ☐ Sheet Metal ☐ Rolled Asphalt ☐ Other ☐
5. ENGINEERING STRUCTURE:
6. OTHER:
of Stories 2 1/2 # of Bays 3x Approx. Dimensions 20' x 40' MB
Roof Style: Gable ☒ Hip ☐ Gambrel ☐ Flat ☐ Shed ☐ Mansard ☐ Jerkinhead ☐
Monitor ☐ Sawtooth ☐ Other ☐
Appendages: Porches ☐ Towers ☐ Dormers ☐ Bay Windows ☐ Ells 2 Chimneys 2 (M.B.)
Wings ☐ Cupolas ☐ Sheds ☐ Garage ☐ Other ☐
Entry Location: Center ☐ Sidehall ☒ Other ☐

MAP (Indicate North in circle):

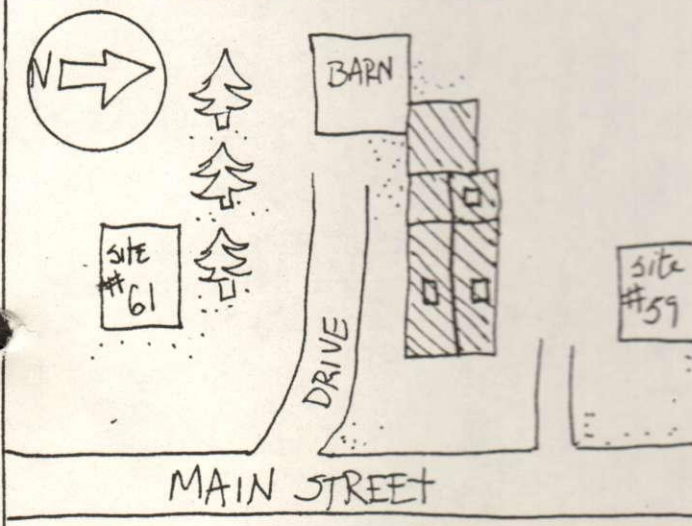

PHOTO



Description of View: Front-east
Side-south

Photographer: Scott Novak
Negative with: S.R.R.C.
Negative File Number: K-80-5c/34-34A

ADDITIONAL ARCHITECTURAL AND STRUCTURAL DESCRIPTION:

The Gibson House is a late Greek Revival style structure which was later modified by the raising of the roof. The recessed sidehall entry has a wooden door with one road-panel, and is flanked by sidelights extending its full height and paneled pilasters rising to a full entablature. Windows are two-over-one with shutters and the windows in the gable-end facade have segmentally arched window caps. The steeply pitched roof is surmounted by two chimneys with corbeled caps, and the eaves treatment consists of a boxed cornice with a wide frieze and gable-end returns supported by corner pilasters.

The 1½-story ell has a more steeply pitched roof topped by a tall chimney with a corbeled cap, close raking and lateral eaves, and clapboard wall covering. It rests on a granite block foundation, and has a four-panel door with transom lights on the south elevation. It connects to a 1-story, gable-roofed ell which rests on a cement block, brick, and fieldstone foundation.

RELATED STRUCTURES AND CONTEXT: A gable-roofed 2½-story barn has a horizontally sliding vertical-board door, nine-over-six windows, and clapboard siding. It has close raking & lateral eaves, and rests on a fieldstone foundation.

BOUNDARY AND ACREAGE DESCRIPTION: .5 acres bounded to the N-Dutton, S-Reynolds, E-Main Street, W-Reynolds, Moorse.

REFERENCES:

Kingston Historic Advisory Committee; interviews w/members, Spring 1980
1856 Map
1892 Map

STATEMENT OF SIGNIFICANCE (Evaluation & Historical Associations):

The A. Brown House is an unusual example of the Greek Revival Style executed in kneewall construction. Its uniqueness derives from the juxtaposition of its small size against the bigness and number of its details -- it manages to cram 5 full-sized windows and a fully scaled recessed entry on its tiny facade.

Historic Associations: The Gibsons, the present owners, came to the house in the 1920s. She was librarian and postmistress.

MAP DATA 1892-LF Prescott 1856-A Brown

SURROUNDING ENVIRONMENT: Open Land ☐ Woodland ☐ Scattered Bldgs ☐ Moderately Built Up ☒
Densely Built Up ☐ Residential ☒ Commercial ☐ Industrial ☐ Agricultural ☐
Roadside Strip Development ☐ Other ☐

Recorded By: Scott Novak
Herb Bubert

Date: 12/24/79

