

## HISTORIC PRESERVATION ASSISTANCE PROJECT

Strafford Rockingham Regional Council

1 Water Street, Exeter, New Hampshire

Phone: (603) 778-0885

TOWN: Kingston	COUNTY: Rockingham	UTM: Z 19 /E 332225 /N 4755775
SURVEY NUMBER: 79 *		USGS QUAD: Haverhill Quad 15' Series
COMMON NAME: Pilgrim United Church of Christ		FUNCTIONAL TYPE: Church
HISTORIC NAME: Methodist Church		PRESENT USE: Church
LOCATION: W side of Church St., .16 miles S of intersection of Church & Cottage.		ARCHITECT/BUILDER: Unknown
OWNER: Pilgrim Church of Christ 12 Church St.		CONDITION: Exc. <input checked="" type="checkbox"/> Good <input type="checkbox"/> Fair <input type="checkbox"/> Poor <input type="checkbox"/> Ruins
ADDRESS: Kingston, NH.		INTEGRITY: Original Site <input checked="" type="checkbox"/> Moved <input type="checkbox"/> (When: )
MAP & PARCEL #: U-10/15		Major alterations & date: Increased size, Balcony Front Entrance removed, covered with clapboards roof shingles replaced
DATE: c. 1899		LEVEL/SIGNIFICANCE: Natl <input type="checkbox"/> State <input type="checkbox"/> Local <input checked="" type="checkbox"/>
SOURCE: History of Kingston		
STYLE: Colonial Revival		

## GENERAL DESCRIPTION: Structural System

- FOUNDATION: Stone ☒ Brick ☐ Concrete ☐ Concrete Block ☐
- WALL STRUCTURE: Wood Frame ☐ Post & Beam ☒ Ballon Frame ☐ Other ☐  
Load Bearing Masonry ☐ Stone ☐ Brick ☐ Concrete Block ☐ Other ☐  
Metal ☐ Iron ☐ Steel ☐ Other ☐
- WALL COVERING: Clapboard ☒ Wood Shingle ☐ Board & Batten ☐ Shiplap ☐ Aluminum ☐  
Novelty ☐ Stucco ☐ Stone ☐ Brick ☐ Sheet Metal ☐ Asphalt Shingles ☐ Vinyl ☐  
Asphalt Sheeting ☐ Composite Board ☐ Other ☐
- ROOF SHEATHING: Wood Shingle ☐ Asphalt Shingle ☒ Standing Seam Tin ☐ Slate ☐  
Pressed Metal ☐ Sheet Metal ☐ Rolled Asphalt ☐ Other ☐
- ENGINEERING STRUCTURE:
- OTHER:  
# of Stories  $1\frac{1}{2}$  # of Bays 2x5 Approx. Dimensions \_\_\_\_\_  
Roof Style: Gable ☒ Hip ☐ Gambrel ☐ Flat ☐ Shed ☐ Mansard ☐ Jerkinhead ☐  
Monitor ☐ Sawtooth ☐ Other ☐  
Appendages: Porches ☐ Towers ☐ Dormers ☐ Bay Windows ☐ Ells ☐ Chimneys ☐  
Wings ☐ Cupolas ☐ Sheds ☐ Garage ☐ Other ☐  
Entry Location: Center ☐ Sidehall ☐ Other ☐ Sidewall ☐

MAP (Indicate North in circle):

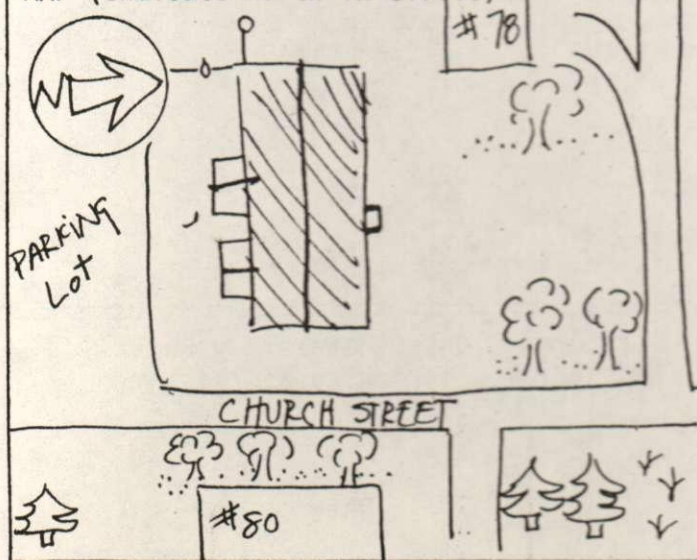

PHOTO

Description of View: Front-east  
Side-south

Photographer: Herb Bubert

Negative with: S.R.R.C.

Negative File Number: K-80-3c/19-19A, 21-21



### ADDITIONAL ARCHITECTURAL AND STRUCTURAL DESCRIPTION:

The Pilgrim United Church of Christ is a 1½-story, Colonial Revival style structure. The sidehall entry, located on the south elevation, has double-leaf doors, each with one light. Above the door is a gable-roofed door hood. All of the windows have eight-over-two sash. The windows in the gable-end, which is oriented toward the street, have projecting caps, while those on the north and south elevations have pedimented lintels.

The medium-pitch roof is topped by a narrow chimney with a vault. The eaves treatment consists of a boxed cornice with a wide frieze and gable-end returns supported by wide cornerboards capped with moldings to suggest pilasters. The main block rests on a fieldstone foundation.

A 2-story, gable-roofed ell extends to the west.

Two patterns of pressed tin have been applied (over the clapboards) to the exterior of the west elevation.

A 1-story, gable-roofed enclosed porch is located on the south elevation. It has clapboard siding and rests on a concrete block foundation.

### RELATED STRUCTURES AND CONTEXT:

### BOUNDARY AND ACREAGE DESCRIPTION:

.6 acres bounded to the N-Cross, S-Town of Kingston, E-Church Street, W-Greenwood Pond.

### REFERENCES: Kingston Historic Advisory Committee; interviews w/members, Spring 1980

Kingston Historical Society. The History of Kingston: 1694-1969. Kingston Improvement and Historical Society.

MAP DATA 1856 1892

### STATEMENT OF SIGNIFICANCE (Evaluation & Historical Associations):

The present appearance of the Methodist Church bears little resemblance to the original structure. Today it is a simple plain building shorn of its Colonial Revival character.

Historic Associations: See page 73 of Town History for a picture. Windows, steeple, bell went to Methodist Church in Fremont in 1917 when parish joined congregational church (until 1959). Was high school gym, acquired by John Swazey, trustee of Seminary. In 1960's was egg processing warehouse; balcony removed, front entrance closed. Became a church again in 1968; made a mezzanine.

MAP DATA: 1856: Methodist Church  
1892: Methodist Church

\* SEE ADDITION / CORRECTION SHEETS  
FOR OWNER COMMENTS

SURROUNDING ENVIRONMENT: Open Land    Woodland    Scattered Bldgs    Moderately Built Up X  
Densely Built Up    Residential X Commercial    Industrial    Agricultural     
Roadside Strip Development    Other   

Recorded By: Herb Bubert

Date: 12/27/79



