

HISTORIC PRESERVATION ASSISTANCE PROJECT

Strafford Rockingham Regional Council

1 Water Street, Exeter, New Hampshire

Phone: (603) 778-0885

TOWN: Kingston	COUNTY: Rockingham	UTM: Z 19/E 332275 /N 4755450
SURVEY NUMBER: 88 *		USGS QUAD: Haverhill Quad 15' Series
COMMON NAME: Sanborn House		FUNCTIONAL TYPE: Farmhouse
HISTORIC NAME: Levi Bartlett		PRESENT USE: Residential
LOCATION: .1 miles S. of inter. W. Main & Church, west side of West Main Street.		ARCHITECT/BUILDER: Levi S. Bartlett
OWNER: Alden Sanborn		CONDITION: Exc. <input checked="" type="checkbox"/> Good <input type="checkbox"/> Fair <input type="checkbox"/> Poor <input type="checkbox"/> Ruins <input type="checkbox"/>
ADDRESS: 154B Main St. West, Kingston, NH		INTEGRITY: Original Site <input checked="" type="checkbox"/> Moved <input type="checkbox"/> (When: <input type="text"/>)
MAP & PARCEL #: U-10/7		Major alterations & date: Unknown
DATE: C. 1892		
SOURCE: Inspection		
STYLE: Late 19th Century		LEVEL/SIGNIFICANCE: Natl <input type="checkbox"/> State <input type="checkbox"/> Local <input checked="" type="checkbox"/>

GENERAL DESCRIPTION: Structural System

- FOUNDATION: Stone ☐ Brick ☒ Concrete ☐ Concrete Block ☐
- WALL STRUCTURE: Wood Frame ☐ Post & Beam ☐ Ballon Frame ☒ Other ☐
Load Bearing Masonry ☐ Stone ☐ Brick ☐ Concrete Block ☐ Other ☐
Metal ☐ Iron ☐ Steel ☐ Other ☐
- WALL COVERING: Clapboard ☒ Wood Shingle ☐ Board & Batten ☐ Shiplap ☐ Aluminum ☐
Novelty ☐ Stucco ☐ Stone ☐ Brick ☐ Sheet Metal ☐ Asphalt Shingles ☐ Vinyl ☐
Asphalt Sheeting ☐ Composite Board ☐ Other ☐
- ROOF SHEATHING: Wood Shingle ☐ Asphalt Shingle ☒ Standing Seam Tim ☐ Slate ☐
Pressed Metal ☐ Sheet Metal ☐ Rolled Asphalt ☐ Other ☐
- ENGINEERING STRUCTURE:
- OTHER:
of Stories 2 1/2 # of Bays 2x2 Approx. Dimensions 25' x 30'
Roof Style: Gable ☒ Hip ☐ Gambrel ☐ Flat ☐ Shed ☐ Mansard ☐ Jerkinhead ☐
Monitor ☐ Sawtooth ☐ Other ☐
Appendages: Porches ☐ Towers ☐ Dormers ☐ Bay Windows ☐ Ells ☐ Chimneys ☐
Wings ☐ Cupolas ☐ Sheds ☐ Garage ☐ Other ☐
Entry Location: Center ☐ Sidehall ☐ Other ☒ sidewall

MAP (Indicate North in circle):

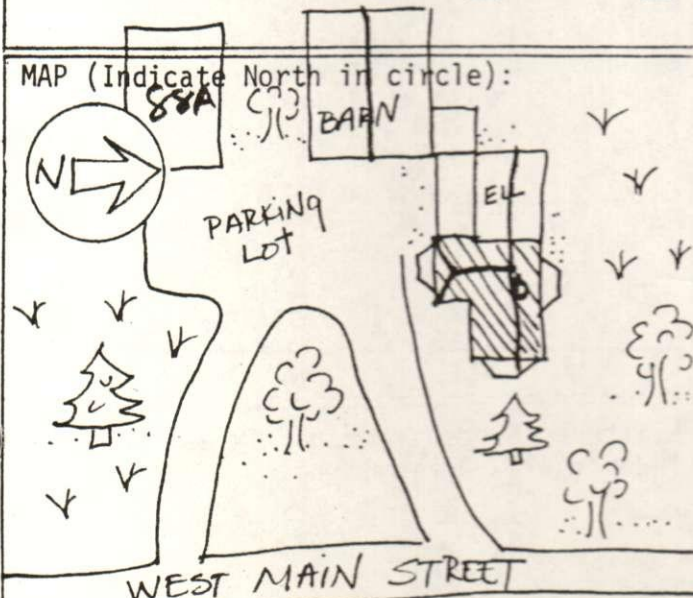

PHOTO

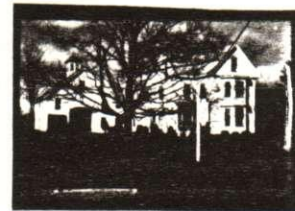

Description of View: Front-east
Side-south

Photographer: Scott Novak
Negative with: S.R.R.C.
Negative File Number: K-80-30/30-30A

ADDITIONAL ARCHITECTURAL AND STRUCTURAL DESCRIPTION:

The Sanborn House is a cross-gable house built in the late 19th century. The multi-panel and light entry door is sheltered by a 1-story, flat-roofed, open porch with decorative balusters supported by turned posts. Windows are two-over-two with caps, and the north, south, and east elevations each have a 2-story bay window with panels separating the stories. The medium-pitched roof has a boxed cornice and gable-end returns.

A 1½-story gable-roofed ell topped by a shed dormer meets an enclosed shed-roofed porch on the south elevation that has clapboard siding, a new door, and new one-over-one windows. The ell rests on a brick foundation. This ell is attached to a 1-story, shed which is clapboard siding, six-over-six windows with caps, and a boxed cornice with gable-end returns. It has an arched doorway and rests on a brick foundation.

RELATED STRUCTURES AND CONTEXT:

BOUNDARY AND ACREAGE DESCRIPTION: 1.7 acres bounded to the N-Wilson, E-Main Street, S-Moore, W-Wilson.

REFERENCES:

Kingston Historic Advisory Committee; interviews w/members, Spring 1980
1892 Map

STATEMENT OF SIGNIFICANCE (Evaluation & Historical Associations):

The L. S. Bartlett House is of interest to architectural historians and historians alike; to the former as a locally-designed example of the Victorian influence, and to the latter because the designer was the grandson of a nationally important figure.

Historic Associations: House was built by Levi S. Bartlett. Carpenter Alfred Lyford helped by Joseph & Maurice Maillette. Levi S. Bartlett did drawings of the house. Levi, a grandson of Josiah Bartlett, was a farmer and cattle dealer who wanted to be a lawyer. Scale drawings of bays are in attic of the J. Bartlett House next door.

MAP DATA: 1892: L. S. Bartlett

SURROUNDING ENVIRONMENT: Open Land__ Woodland__ Scattered Bldgs^x Moderately Built Up__
Densely Built Up__ Residential^x Commercial__ Industrial__ Agricultural__
Roadside Strip Development__ Other__

Recorded By: Scott Noyak

Ferb Bubert

Date: 12/28/79

