

HISTORIC PRESERVATION ASSISTANCE PROJECT

Strafford Rockingham Regional Council

1 Water Street, Exeter, New Hampshire

Phone: (603) 778-0885

TOWN: <u>Kingston</u>	COUNTY: <u>Rockingham</u>	UTM: <u>Z 19 /E 332175 /N 4755175</u>
SURVEY NUMBER: <u>05 *</u>		USGS QUAD: <u>Haverhill Quad 15' Series</u>
COMMON NAME: <u>Scalet House</u>		FUNCTIONAL TYPE: <u>Farmhouse</u>
HISTORIC NAME: <u>S. F. Nichols House</u>		PRESENT USE: <u>Residential</u>
LOCATION: <u>W side of W. Main St., .03 miles S of inter. of W. Main & Rockrimmon</u>		ARCHITECT/BUILDER: <u>Unknown</u>
OWNER: <u>Paul & Susan Scalet</u>		CONDITION: <u>Exc. <input checked="" type="checkbox"/> Good <input type="checkbox"/> Fair <input type="checkbox"/> Poor <input type="checkbox"/> Ruins <input type="checkbox"/></u>
ADDRESS: <u>146 Main St. West, Kingston, NH</u>		INTEGRITY: <u>Original Site <input checked="" type="checkbox"/> Moved <input type="checkbox"/> (When: <input type="text"/>)</u>
MAP & PARCEL #: <u>U-11/12</u>		Major alterations & date: <u>Unknown</u>
DATE: <u>c. 1890</u>		
SOURCE: <u>Inspection</u>		
STYLE: <u>Colonial Revival</u>		LEVEL/SIGNIFICANCE: <u>Nat'l <input type="checkbox"/> State <input type="checkbox"/> Local <input checked="" type="checkbox"/></u>

GENERAL DESCRIPTION: Structural System

1. FOUNDATION: Stone ☐ Brick ☒ Concrete ☐ Concrete Block ☐
2. WALL STRUCTURE: Wood Frame ☐ Post & Beam ☐ Ballon Frame ☒ Other ☐
Load Bearing Masonry ☐ Stone ☐ Brick ☐ Concrete Block ☐ Other ☐
Metal ☐ Iron ☐ Steel ☐ Other ☐
3. WALL COVERING: Clapboard ☒ Wood Shingle ☐ Board & Batten ☐ Shiplap ☐ Aluminum ☐
Novelty ☐ Stucco ☐ Stone ☐ Brick ☐ Sheet Metal ☐ Asphalt Shingles ☐ Vinyl ☐
Asphalt Sheeting ☐ Composite Board ☐ Other ☐
4. ROOF SHEATHING: Wood Shingle ☐ Asphalt Shingle ☒ Standing Seam Tim ☐ Slate ☐
Pressed Metal ☐ Sheet Metal ☐ Rolled Asphalt ☐ Other ☐
5. ENGINEERING STRUCTURE:
6. OTHER:
of Stories 2 1/2 # of Bays 3x4 Approx. Dimensions 30' x 30'
Roof Style: Gable ☐ Hip ☒ Gambrel ☐ Flat ☐ Shed ☐ Mansard ☐ Jerkinhead ☐
Monitor ☐ Sawtooth ☐ Other ☐
Appendages: Porches ☐ Towers ☐ Dormers ☐ Bay Windows ☐ Ells ☐ Chimneys ☐
Wings ☐ Cupolas ☐ Sheds ☐ Garage ☐ Other ☐ offset gables ☐
Entry Location: Center ☐ Sidehall ☐ Other ☐ sidewall ☐

MAP (Indicate North in circle):

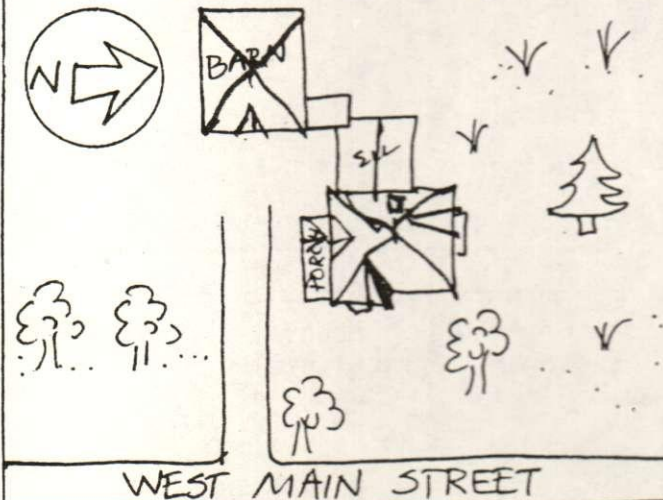

PHOTO



Description of View: Front-east
Side-north

Photographer: Herb Hubert
 Negative with: S.R.R.C.
 Negative File Number: K-80-30/36-36A

ADDITIONAL ARCHITECTURAL AND STRUCTURAL DESCRIPTION:

The Scalet House is a 2½-story, hip-roofed, Colonial Revival style house featuring two large pedimented gables with decorative shingles, on its north and east elevations. Entry is via a 1-story, shed-roofed, open porch which shelters a 1-story, shed-roofed enclosed porch with a Victorian era door framed by architrave trim. All of the windows have two-over-one sash framed by shutters and architrave trim except for the windows in the gables, which have eight-over-one sash framed by shutters. A 1-story, three-sided, bay window is located on the east elevation. A gable-roofed dormer with decorative shingles is located on the south elevation.

The hip-roof is topped by two, narrow, corbel-capped chimneys and the eaves treatment consists of a boxed cornice with a wide frieze. The house rests on a brick foundation.

A 1½-story, gable-roofed ell projects to the west. It has a 1-story, shed-roofed ell on its west elevation.

RELATED STRUCTURES AND CONTEXT: To the southwest of the house is a 2-story, barn with a hip-roof surmounted by a cupole. It has a dormer on its front facade with decorative shingles similar to those on the main block. Its entrance is surmounted by an entablature and it has two-over-two windows framed by architrave trim. The barn rests on a brick foundation.

BOUNDARY AND ACREAGE DESCRIPTION: 1.5 acres bounded to the N-Town of Kingston, S-Briggs, E-West Main Street, W-Howard.

REFERENCES:

Kingston Historic Advisory Committee; interviews w/members, Spring 1980
1856 Map
1892 Map

STATEMENT OF SIGNIFICANCE (Evaluation & Historical Associations):

The S. F. Nichols House is a well designed example of the Colonial Revival style. The plan and balanced massing give it dignity and the use of ornament is restrained.

Historic Associations: Fred Nichols owned the whole corner at one time and had a shop out back where he made window blinds.

MAP DATA: 1856: S. F. and F. G. Nichols (this house was later moved to SE end of Plains - Site #2)
1892: S. F. Nichols

SURROUNDING ENVIRONMENT: Open Land__ Woodland__ Scattered Bldgs__ Moderately Built Up__
Densely Built Up__ Residential__x Commercial__ Industrial__ Agricultural__
Roadside Strip Development__ Other__

Recorded By: Scott Novak
Herb Dubant

Date: 1/2/80

