

## HISTORIC PRESERVATION ASSISTANCE PROJECT

Strafford Rockingham Regional Council

1 Water Street, Exeter, New Hampshire

Phone: (603) 778-0885

TOWN: Kingston	COUNTY: Rockingham	UTM: Z 19/E 333550 /N4757150
SURVEY NUMBER: District 2 5**		USGS QUAD: Haverhill Quad 15' series
COMMON NAME: The Pelletier House		FUNCTIONAL TYPE: Residential
HISTORIC NAME: Unknown		PRESENT USE: Residential
LOCATION: NE side of Alma Ave. First house on right of 5		ARCHITECT/BUILDER: Unknown
OWNER: Wallace & Paula Pelletier		CONDITION: Exc. <input checked="" type="checkbox"/> Good <input type="checkbox"/> Fair <input type="checkbox"/> Poor <input type="checkbox"/> Ruins
ADDRESS: 1 Alma Ave., Kingston, NH		INTEGRITY: Original Site <input checked="" type="checkbox"/> Moved <input type="checkbox"/> (When: )
MAP & PARCEL #: R39-7		Major alterations & date:
DATE: C. 1960		
SOURCE: Site inspection		
STYLE: Cape		LEVEL/SIGNIFICANCE: Natl <input type="checkbox"/> State <input type="checkbox"/> Local <input checked="" type="checkbox"/>

GENERAL DESCRIPTION: Structural System

- FOUNDATION: Stone ☐ Brick ☐ Concrete ☒ Concrete Block ☐
- WALL STRUCTURE: Wood Frame ☐ Post & Beam ☐ Ballon Frame ☒ Other ☐  
Load Bearing Masonry ☐ Stone ☐ Brick ☐ Concrete Block ☐ Other ☐  
Metal ☐ Iron ☐ Steel ☐ Other ☐
- WALL COVERING: Clapboard ☐ Wood Shingle ☐ Board & Batten ☐ Shiplap ☐ Aluminum ☐  
Novelty ☐ Stucco ☐ Stone ☐ Brick ☐ Sheet Metal ☐ Asphalt Shingles ☐ Vinyl ☐  
Asphalt Sheeting ☐ Composite Board ☐ Other ☒ Vertical Board ☐
- ROOF SHEATHING: Wood Shingle ☐ Asphalt Shingle ☒ Standing Seam Tim ☐ Slate ☐  
Pressed Metal ☐ Sheet Metal ☐ Rolled Asphalt ☐ Other ☐
- ENGINEERING STRUCTURE:
- OTHER:  
# of Stories 1 1/2 # of Bays 4X2 Approx. Dimensions 25 x 25  
Roof Style: Gable ☒ Hip ☐ Gambrel ☐ Flat ☐ Shed ☐ Mansard ☐ Jerkinhead ☐  
Monitor ☐ Sawtooth ☐ Other ☐  
Appendages: Porches ☐ Towers ☐ Dormers 1 Bay Windows ☐ Ells ☐ Chimneys 1  
Wings 1 Cupolas ☐ Sheds ☐ Garage 1 Other ☐  
Entry Location: Center ☒ Sidehall ☐ Other ☐

MAP (Indicate North in circle):

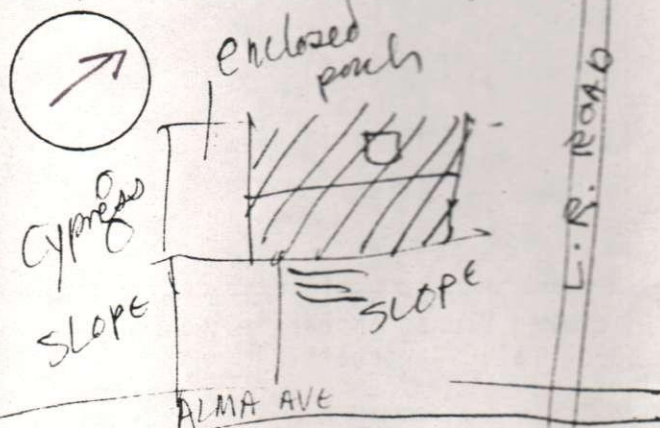

PHOTO

Description of View:

Photographer:  
Negative with: S.R.R.C.  
Negative File Number:



ADDITIONAL ARCHITECTURAL AND STRUCTURAL DESCRIPTION:

Perched on a slope in the Little River District, this c.1960 cape style house features a 2-bay basement garage, mature landscaping and a multipaned picture window.

RELATED STRUCTURES AND CONTEXT:

BOUNDARY AND ACREAGE DESCRIPTION: .5 Acres. Bounded to the N. by Sousa, E. by Sloan S. by Little River Rd., W. by Alma Avenue.

REFERENCES:

STATEMENT OF SIGNIFICANCE (Evaluation & Historical Associations):

SURROUNDING ENVIRONMENT: Open Land ☐ Woodland ☐ Scattered Bldgs ☐ Moderately Built Up ☐  
Densely Built Up ☐ Residential ☐ Commercial ☐ Industrial ☐ Agricultural ☐  
Roadside Strip Development ☐ Other ☐

Recorded By:

Date:

