

HISTORIC PRESERVATION ASSISTANCE PROJECT

Strafford Rockingham Regional Council

1 Water Street, Exeter, New Hampshire

Phone: (603) 778-0885

TOWN: <u>Kingston</u>	COUNTY: <u>Rockingham</u>
SURVEY NUMBER: <u>District 2, 12</u> **	
COMMON NAME: <u>Wight House</u>	
HISTORIC NAME: <u>R. L. Prescott House</u>	
LOCATION: <u>E. side of Little River Rd. at junction of Little River Rd. West</u>	
OWNER: <u>Robert & Nancy Wight</u>	
ADDRESS: <u>51 Little River Rd., Kingston, NH</u>	
MAP & PARCEL #: <u>R39 39</u>	
DATE: <u>C. 1820</u>	
SOURCE: <u>Inspection</u>	
STYLE: <u>Federal Cape</u>	

UTM: <u>Z 19 /E 333775 /N 4757425</u>
USGS QUAD: <u>Haverhill Quad 15' series</u>
FUNCTIONAL TYPE: <u>Mill House</u>
PRESENT USE: <u>Residential</u>
ARCHITECT/BUILDER: <u>Unknown</u>
CONDITION: <u>Exc. GoodxxFair Poor Ruins</u>
INTEGRITY: <u>Original Site X Moved</u> (When: <u> </u>)
Major alterations & date: <u>Unknown</u>
LEVEL/SIGNIFICANCE: <u>Nat'l State Local X</u>

GENERAL DESCRIPTION: Structural System

- FOUNDATION: Stone Brick X Concrete Concrete Block
- WALL STRUCTURE: Wood Frame Post & Beam X Ballon Frame Other
Load Bearing Masonry Stone Brick Concrete Block Other
Metal Iron Steel Other
- WALL COVERING: Clapboard X Wood Shingle Board & Batten Shiplap Aluminum
Novelty Stucco Stone Brick Sheet Metal Asphalt Shingles Vinyl
Asphalt Sheeting Composite Board Other
- ROOF SHEATHING: Wood Shingle Asphalt Shingle X Standing Seam Tim Slate
Pressed Metal Sheet Metal Rolled Asphalt Other
- ENGINEERING STRUCTURE:
- OTHER:
of Stories 1 # of Bays Approx. Dimensions
Roof Style: Gable X Hip Gambrel Flat Shed Mansard Jerkinhead
Monitor Sawtooth Other
Appendages: Porches Towers Dormers Bay Windows Ells Chimneys 1 MB
Wings 2 Cupolas Sheds Garage 1 Other 1 on ell
Entry Location: Center Sidehall Other Offset

MAP (Indicate North in circle):

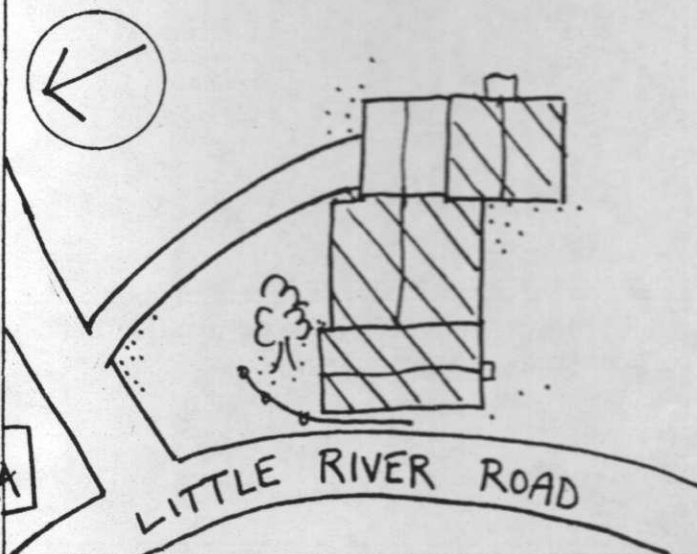

PHOTO



Description of View:

Front (N)

Photographer: Scott NovakNegative with: S.R.R.C.Negative File Number: K80 4C-15-15A

ADDITIONAL ARCHITECTURAL AND STRUCTURAL DESCRIPTION:

The main block of the Wight House is a 1½ story Federal Cape. It's offset entry features a four-panel door flanked by ¾ length sidelights which rest on recessed panels, and is topped by a full entablature.

Windows have six over six sash. The eaves treatment consists of close molded trim on both the lateral and raking eaves. There is an extended chimney with a corbeled cap. A large two story wing to the southeast, has a gable roof, the same siding and eaves treatment as the main block, and rests on a concrete block foundation. Extending further is an attached 2 story, gable roofed garage with living quarters in the second story. Another 2½ story wing extends behind the garage. Both wings and the garage are treated the same as the main block.

RELATED STRUCTURES AND CONTEXT:

Property is site of Old Sawmill

BOUNDARY AND ACREAGE DESCRIPTION:

1.2 Acres. Bounded to the N. by Little River Road, E. by the Little River, S. by the Little River, W. by Little River Road.

REFERENCES:

Kingston Historic Advisory Committee; interviews w/members, Spring 1980
1856 Map and 1892 Map
Kingston Historical Society. The History of Kingston: 1694-1969. Kingston
Improvement and Historical Society. 1969

STATEMENT OF SIGNIFICANCE (Evaluation & Historical Associations):

The main block of the Prescott House is a Federal Cape which was also associated with the Judkins family. Its many additions over time have considerably expanded it to its present rambling configuration.

Historic Associations: Possibly part of original 100-acre grant voted by Town in 1705 to anyone who would set up a mill. The land may have been given to Benjamin and Samuel Judkins, but the site is mentioned in a deed of Capt. Jonathan Sanborn, 1722. Lower pond -- tannery after sawmill. Eugene Prescott bought sawmill from J. Warren Sanborn. Dam restored c.1980, by David Gould.

MAP DATA: 1856: Tannery & Sawmill 1892: R. L. Prescott, Sawmill & shop

SURROUNDING ENVIRONMENT: Open Land ☒ Woodland ☐ Scattered Bldgs ☒ Moderately Built Up ☐
Densely Built Up ☐ Residential ☒ Commercial ☐ Industrial ☐ Agricultural ☐
Roadside Strip Development ☐ Other ☐

Recorded By: Scott Novak, Herb Bubert

Date: 1/9/80

