

HISTORIC PRESERVATION ASSISTANCE PROJECT

Strafford Rockingham Regional Council

1 Water Street, Exeter, New Hampshire

Phone: (603) 778-0885

TOWN: Kingston	COUNTY: Rockingham	UTM: Z19 /E 330950 /N 4748125
SURVEY NUMBER: 8		USGS QUAD: Haverhill Quad 15' series
COMMON NAME: The Mills House		FUNCTIONAL TYPE: Residential
HISTORIC NAME: S. Dargin House		PRESENT USE: Residence
LOCATION: 1.01 mi. S. of RT 103 on E. side of Newton Junction Rd.		ARCHITECT/BUILDER: Unknown
OWNER: Edward & Marion Mills		CONDITION: Exc. <u>Good</u> <input checked="" type="checkbox"/> Fair <u>Poor</u> <u>Ruins</u>
ADDRESS: 63 Newton Jct. Rd., Kingston, NH		INTEGRITY: Original Site <input checked="" type="checkbox"/> Moved <u> </u> (When: <u> </u>)
MAP & PARCEL #: R4-11		Major alterations & date: None
DATE: c. 1870		
SOURCE: Inspection		
STYLE: Italianate/Vernacular		LEVEL/SIGNIFICANCE: Natl <u>State</u> Local <input checked="" type="checkbox"/>

GENERAL DESCRIPTION: Structural System

- FOUNDATION: Stone Brick ☒ Concrete Concrete Block
- WALL STRUCTURE: Wood Frame Post & Beam Ballon Frame ☒ Other
Load Bearing Masonry Stone Brick Concrete Block Other
Metal Iron Steel Other
- WALL COVERING: Clapboard ☒ Wood Shingle Board & Batten Shiplap Aluminum Novelty Stucco Stone Brick Sheet Metal Asphalt Shingles Vinyl Asphalt Sheeting Composite Board Other
- ROOF SHEATHING: Wood Shingle Asphalt Shingle ☒ Standing Seam Tim Slate Pressed Metal Sheet Metal Rolled Asphalt Other
- ENGINEERING STRUCTURE:
- OTHER:
of Stories 2 # of Bays 3x2 Approx. Dimensions 20' x
Roof Style: Gable ☒ Hip Gambrel Flat Shed Mansard Jerkinhead Monitor Sawtooth Other
Appendages: Porches Towers Dormers Bay Windows Ells 1 Chimneys 1 1 ell
Wings Cupolas Sheds Garage Other
Entry Location: Center Sidehall Other

MAP (Indicate North in circle):

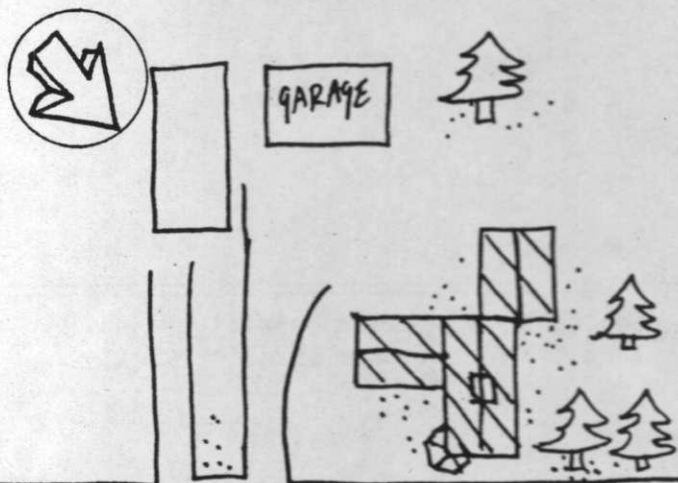

NEWTON JUNCTION ROAD

PHOTO



Description of View:

Front (NE) side (SE)

Photographer: Scott Novak

Negative with: S.R.R.C. 100-1-0/2-01

Negative File Number:

ADDITIONAL ARCHITECTURAL AND STRUCTURAL DESCRIPTION:

This 1 1/2 story frame house features a 1 1/2 story pyramidal hip-roofed tower on the southeast corner.

It is topped by a copper finial. The main block has a multi-panel and light sidelall entry door with a door/bell supported by decorative brackets. All the windows have two-over-one sash and projecting lintels caps. The medium-pitched roof is topped by one tall chimney with a corbeled cap, and the eave treatment is a boxed cornice with slight gable end returns and a wide frieze.

A 1 1/2 story gable-roofed wing to the southeast has the same foundation, siding, windows, and eave treatment as the main block. It has a multi-panel door with one large light.

A 1 1/2 story gable-roofed ell to the southwest has the same foundation, siding windows, door and eave treatment as the main block.

RELATED STRUCTURES AND CONTEXT: There is a separate three-car garage and a chicken coop to the south.

BOUNDARY AND ACREAGE DESCRIPTION: Bounded on the S. E. by Kanto Development Inc.,
... 1.8 Acres

REFERENCES:

1892 Map

STATEMENT OF SIGNIFICANCE (Evaluation & Historical Associations):

The S. Durgin House is a nice example of late 19th century building, the tower being of particular interest. It contributes to the architectural interest of the South Kingston historic area.

MAP DATA: 1856: Railroad depot next door to this site.
1892: S. Durgin

SURROUNDING ENVIRONMENT: Open Land__ Woodland__ Scattered Bldgs__ Moderately Built Up__
Densely Built Up__ Residential__ Commercial__ Industrial__ Agricultural__
Roadside Strip Development__ Other__

Recorded By: Susan Lovell, Herb Dubert

Date: 6/5/80

