

# HISTORIC PRESERVATION ASSISTANCE PROJECT

Strafford Rockingham Regional Council

1 Water Street, Exeter, New Hampshire

Phone: (603) 778-0885

TOWN: Kingston	COUNTY: Rockingham
SURVEY NUMBER: 12	
COMMON NAME: Fellows House	
HISTORIC NAME: W. J. Poiley House	
LOCATION: SW side of Newton Junction Road, .81 miles SE of the inter. of Rte. 125	
OWNER: Frank & Janet Fellows	
ADDRESS: 59 Newton Jct. Rd., Kingston, NH	
MAP & PARCEL #: R-4/13	
DATE: c. 1880	
SOURCE: Inspection	
STYLE: Late 19th century Vernacular	

UTM: Z 19 /E 330900 /N 4748175
USGS QUAD: Haverhill Quad 15' Series
FUNCTIONAL TYPE: Residential
PRESENT USE: residential
ARCHITECT/BUILDER: Unknown
CONDITION: Exc. <u>Good</u> X Fair Poor Ruins
INTEGRITY: Original Site X Moved (When: )
Major alterations & date: Side Porch 1930's 1 story porch 1980
LEVEL/SIGNIFICANCE: Natl State Local X

## GENERAL DESCRIPTION: Structural System

- FOUNDATION: Stone Brick X Concrete Concrete Block
- WALL STRUCTURE: Wood Frame Post & Beam Ballon Frame X Other  
Load Bearing Masonry Stone Brick Concrete Block Other  
Metal Iron Steel Other
- WALL COVERING: Clapboard Wood Shingle X Board & Batten Shiplap Aluminum  
Novelty Stucco Stone Brick Sheet Metal Asphalt Shingles Vinyl  
Asphalt Sheeting Composite Board Other X
- ROOF SHEATHING: Wood Shingle Asphalt Shingle X Standing Seam Tim Slate  
Pressed Metal Sheet Metal Rolled Asphalt Other
- ENGINEERING STRUCTURE:
- OTHER:  
# of Stories 1 1/2 # of Bays 2x3 Approx. Dimensions 20' x 25' M.B.  
Roof Style: Gable X Hip Gambrel Flat Shed Mansard Jerkinhead  
Monitor Sawtooth Other  
Appendages: Porches 2 Towers Dormers Bay Windows 1 Ells 1 Chimneys 1  
Wings Cupolas Sheds Garage X Other  
Entry Location: Center Sidehall X Other

## MAP (Indicate North in circle):

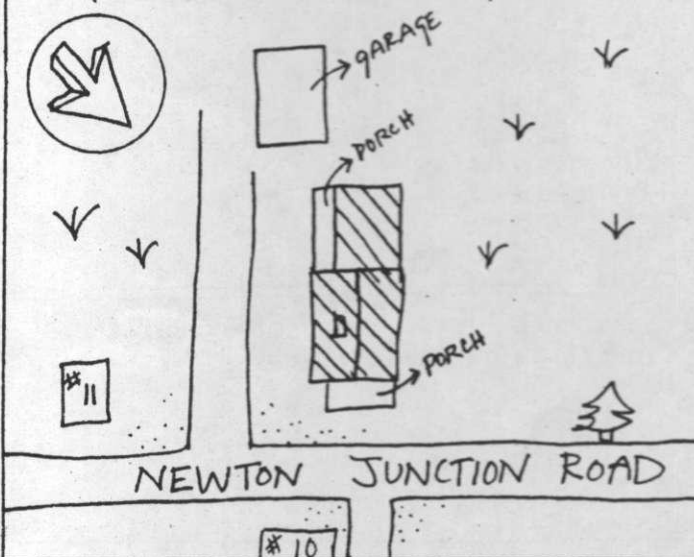

## PHOTO



Description of View: Front-northeast  
Side-southeast

Photographer: Scott Novak  
Negative with: S.R.R.C.  
Negative File Number: K-80-6-c/12-12A

#### ADDITIONAL ARCHITECTURAL AND STRUCTURAL DESCRIPTION:

The Fellows House is a vernacular house built around the turn of the century. The center entry door has four panels with a large light surrounded by small lights, and is sheltered by small, 1-story porch supported by square wooden columns. All windows are two-over-two. The medium-pitched roof is topped by one chimney with a corbeled cap, and the eave treatment consists of a boxed cornice with gable end returns.

A 1-story, gable-roofed ell has the same windows, foundation, and eave treatment as the main block.

A 1-story, shed-roofed porch has a cement block foundation, large one-over-one window, and the same siding and eave treatment as the main block. A bay window is located next to the front porch.

RELATED STRUCTURES AND CONTEXT: Modern 2-car garage has 1-story shed on side.

BOUNDARY AND ACREAGE DESCRIPTION: .5 acres bounded to the N-Newton Junction Road, S-Fellows, E-Fellows, W-Fellows.

#### REFERENCES:

1892 Map

#### STATEMENT OF SIGNIFICANCE (Evaluation & Historical Associations):

The W. J. Poiley House is a small vernacular, late 19th century structure which contributes to the streetscape of Newton Junction Road.

MAP DATA: 1892: W.J. Poiley

MAP DATA

SURROUNDING ENVIRONMENT: Open Land ☐ Woodland ☐ Scattered Bldgs ☐ Moderately Built Up ☐  
Densely Built Up ☐ Residential ☐ Commercial ☐ Industrial ☐ Agricultural ☐  
Roadside Strip Development ☐ Other ☐

Recorded By: Scott Novak  
Herb Eubank

Date: 2/6/80

