

HISTORIC PRESERVATION ASSISTANCE PROJECT

Strafford Rockingham Regional Council

1 Water Street, Exeter, New Hampshire

Phone: (603) 778-0885

TOWN: Kingston	COUNTY: Rockingham
SURVEY NUMBER: 1	
COMMON NAME: The Mitchell House	
HISTORIC NAME: O. Hunt House	
LOCATION: 1/2 mile Hunt Rd., 1.25 Mi. N. of Intersection of Rt. 125	
OWNER: George Mitchell	
ADDRESS: 61 Hunt Rd., Kingston, NH.	
MAP & PARCEL #: R7-19	
DATE: C. 1790	
SOURCE: Inspection	
STYLE: Federal Cape	

UTM: Z 19 /E 320100 /N 4750150
USGS QUAD: Haverhill Quad 15' series
FUNCTIONAL TYPE: Dwelling
PRESENT USE: Residential
ARCHITECT/BUILDER: Unknown
CONDITION: Exc. <input checked="" type="checkbox"/> Good <input type="checkbox"/> Fair <input type="checkbox"/> Poor <input type="checkbox"/> Ruins
INTEGRITY: Original Site <input checked="" type="checkbox"/> Moved <input type="checkbox"/> (When:)
Major alterations & date: Dormer added, date unknown
LEVEL/SIGNIFICANCE: Natl <input type="checkbox"/> State <input type="checkbox"/> Local <input checked="" type="checkbox"/>

GENERAL DESCRIPTION: Structural System

1. FOUNDATION: Stone ☒ Brick ☐ Concrete ☐ Concrete Block ☐
2. WALL STRUCTURE: Wood Frame ☐ Post & Beam ☒ Ballon Frame ☐ Other ☐
Load Bearing Masonry ☐ Stone ☐ Brick ☐ Concrete Block ☐ Other ☐
Metal ☐ Iron ☐ Steel ☐ Other ☐
3. WALL COVERING: Clapboard ☒ Wood Shingle ☐ Board & Batten ☐ Shiplap ☐ Aluminum ☐
Novelty ☐ Stucco ☐ Stone ☐ Brick ☐ Sheet Metal ☐ Asphalt Shingles ☐ Vinyl ☐
Asphalt Sheeting ☐ Composite Board ☐ Other ☐
4. ROOF SHEATHING: Wood Shingle ☐ Asphalt Shingle ☒ Standing Seam Tin ☐ Slate ☐
Pressed Metal ☐ Sheet Metal ☐ Rolled Asphalt ☐ Other ☐
5. ENGINEERING STRUCTURE:
6. OTHER:
of Stories 1 # of Bays 5X2 Approx. Dimensions 27' X 36'
Roof Style: Gable ☒ Hip ☐ Gambrel ☐ Flat ☐ Shed ☐ Mansard ☐ Jerkinhead ☐
Monitor ☐ Sawtooth ☐ Other ☐
Appendages: Porches ☐ Towers ☐ Dormers 1 Bay Windows ☐ Ells 1 Chimneys 1
Wings 1 Cupolas ☐ Sheds 2 Garage 1 Other ☐
Entry Location: Center ☒ Sidehall ☐ Other ☐

MAP (Indicate North in circle):

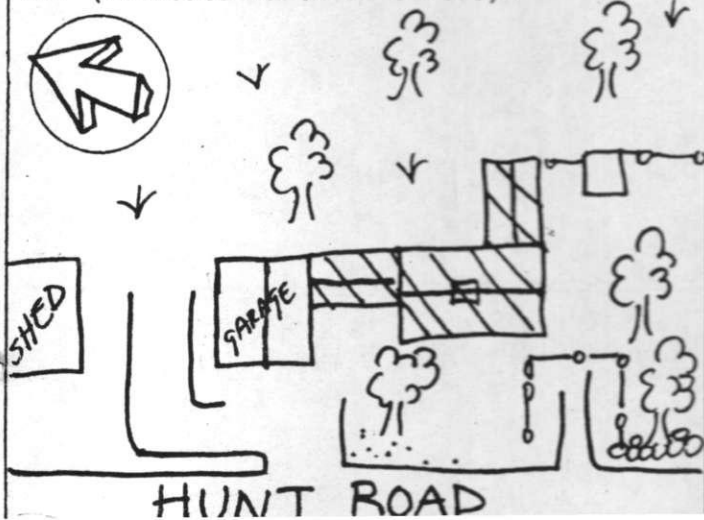

PHOTO



Description of View:

Front (N) Side (S)

Photographer: Scott Novak
Negative with: S R D C

ADDITIONAL ARCHITECTURAL AND STRUCTURAL DESCRIPTION:

The Mitchell House is a 1 1/2 story cape built in the Federal style. The center entry has a 4 panelled door flanked by sidelights which extend halfway.

The first story windows are nine over six and those in the gable-ends have six over six sash. All of the windows are framed by shutters. A shed roofed dormer is located on the northeast elevation. The medium pitched roof is topped by a central chimney and the roofline has close raking and lateral eaves. The house is supported by a granite slab foundation.

The 1 story, gable roofed ell has wood shingle siding, fixed single pane windows, and a cement foundation.

A 1 story gable roofed wing with board and batten siding, a vertical board door, and a cement foundation, projects to the north and connects with a 1 story gable roofed garage.

RELATED STRUCTURES AND CONTEXT: A separate 1 story gable roofed shed is located to the north of the main block. It has board and batten siding, sliding double doors, and a cement foundation. A separate 1 story gable roofed shed is located to the southeast of the main block.

BOUNDARY AND ACREAGE DESCRIPTION: 3.0 Acres. Bounded to the N. by Cunningham, E. by Babcock and Chase, W. by Brooks, S. by Hunt Road.

REFERENCES:

1856 Map 1892 Map

STATEMENT OF SIGNIFICANCE (Evaluation & Historical Associations):

Associated with the prominent Hunt family, the O. Hunt House is a well preserved example of a Federal cape and makes an important contribution to the historic rural character of Hunt Road.

MAP DATA: 1856: O. Hunt
1892: O. Hunt heirs

SURROUNDING ENVIRONMENT: Open Land ☐ Woodland ☒ Scattered Bldgs ☒ Moderately Built Up ☐
Densely Built Up ☐ Residential ☐ Commercial ☐ Industrial ☐ Agricultural ☐
Roadside Strip Development ☐ Other ☐

Recorded By: H. Bubert, S. Novak

Date: 2/7/00

