

HISTORIC PRESERVATION ASSISTANCE PROJECT

Strafford Rockingham Regional Council

1 Water Street, Exeter, New Hampshire

Phone: (603) 778-0885

TOWN: Kingston	COUNTY: Rockingham	UTM: Z 19 /E 329525 /N 4752250
SURVEY NUMBER: 38		USGS QUAD: Haverhill Quad 15' Series
COMMON NAME: Swallow House		FUNCTIONAL TYPE: Residential
HISTORIC NAME: The C. George House		PRESENT USE: Residential
LOCATION: West side of Mill Road, .21 miles S of the inter. of Rte. 111 & Mill Road.		ARCHITECT/BUILDER: Unknown
OWNER: Frances L. Swallow		CONDITION: Exc. <input checked="" type="checkbox"/> Good <input checked="" type="checkbox"/> Fair <input type="checkbox"/> Poor <input type="checkbox"/> Ruins <input type="checkbox"/>
ADDRESS: 58 Mill Road Kingston, NH.		INTEGRITY: Original Site <input checked="" type="checkbox"/> Moved <input type="checkbox"/> (When: _____)
MAP & PARCEL #: R-22/24		Major alterations & date: _____
DATE: c. 1880		
SOURCE: Inspection		
STYLE: Vernacular/Queen Anne		LEVEL/SIGNIFICANCE: Natl <input type="checkbox"/> State <input type="checkbox"/> Local <input checked="" type="checkbox"/>

GENERAL DESCRIPTION: Structural System

- FOUNDATION: Stone ☒ Brick ☐ Concrete ☐ Concrete Block ☐
- WALL STRUCTURE: Wood Frame ☐ Post & Beam ☐ Ballon Frame ☒ Other ☐
Load Bearing Masonry ☐ Stone ☐ Brick ☐ Concrete Block ☐ Other ☐
Metal ☐ Iron ☐ Steel ☐ Other ☐
- WALL COVERING: Clapboard ☒ Wood Shingle ☐ Board & Batten ☐ Shiplap ☐ Aluminum ☐
Novelty ☐ Stucco ☐ Stone ☐ Brick ☐ Sheet Metal ☐ Asphalt Shingles ☐ Vinyl ☐
Asphalt Sheeting ☐ Composite Board ☐ Other ☐
- ROOF SHEATHING: Wood Shingle ☐ Asphalt Shingle ☒ Standing Seam Tin ☐ Slate ☐
Pressed Metal ☐ Sheet Metal ☐ Rolled Asphalt ☐ Other ☐
- ENGINEERING STRUCTURE:
- OTHER:
of Stories 1½ # of Bays 3x4 Approx. Dimensions 20' x 25'
Roof Style: Gable ☒ Hip ☐ Gambrel ☐ Flat ☐ Shed ☐ Mansard ☐ Jerkinhead ☐
Monitor ☐ Sawtooth ☐ Other ☐
Appendages: Porches 1 Towers ☐ Dormers 2 Bay Windows ☐ Ells 2 Chimneys 2
Wings ☐ Cupolas ☐ Sheds 1 Garage ☒ Other ☐
Entry Location: Center ☐ Sidehall ☒ Other ☐

MAP (Indicate North in circle):

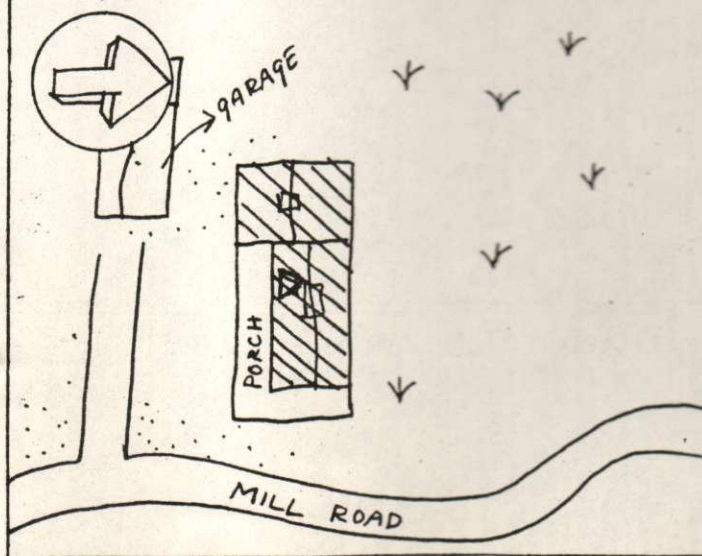

PHOTO

Description of View: Front-south
Side-westPhotographer: Scott Novak
Negative with: S.R.R.C.
Negative File Number: K-80-8c/6-6A

ADDITIONAL ARCHITECTURAL AND STRUCTURAL DESCRIPTION:

The Swallow House is a 1½-story vernacular structure with some Queen Anne style detailing. The sidehall entry has a multi-panelled door with one large light, and is located within the 1-story, shed-roofed, open porch that extends along the south and east facades. Windows are two-over-one with shutters and projecting caps. Eaves treatment consists of a boxed cornice with gable-end returns. There is a 1-bay, shed-roofed wall dormer on both the north and the south sides of the house. There are decorative shingles in the gable end.

A 1-story, gable-roofed ell rests on a stone foundation. It has the identical windows to those of the main block, clapboard siding, close eaves, and a tall chimney with a vault.

A 1-story, shed-roofed ell has vertical-board siding, two-over-two windows, close eaves, and a fieldstone foundation.

RELATED STRUCTURES AND CONTEXT: Modern 1½-story, gable-roofed garage attached.

BOUNDARY AND ACREAGE DESCRIPTION: .5 acres bounded to the N-Senter, S-Lafayette, W-Senter, E-Mill Road.

REFERENCES:

Kingston Historic Advisory Committee; interviews w/members, Spring 1980

1892 Map C. George

STATEMENT OF SIGNIFICANCE (Evaluation & Historical Associations):

In Swallow family since 1925. At one time there was a 1-room building separate from house and barn which housed a 10-15 person shoe factory. On South boundary, there was a toll road running west along a ridge; no signs visible now, as it became a gravel bank c. 12 years ago.

The C. George House is an interesting example of a small vernacular house with Queen Anne detailing; e.g., the cut shingle patterns in the gabled end.

Map Data: 1892: C. George

* SEE ADDITION / CORRECTION SHEETS
FOR OWNER COMMENTS

SURROUNDING ENVIRONMENT: Open Land ☒ Woodland ☐ Scattered Bldgs ☒ Moderately Built Up ☐
Densely Built Up ☐ Residential ☐ Commercial ☐ Industrial ☐ Agricultural ☐
Roadside Strip Development ☐ Other ☐

Recorded By: Scott Novak
Herb Bubert

Date: 2/8/80

