

## HISTORIC PRESERVATION ASSISTANCE PROJECT

Strafford Rockingham Regional Council

1 Water Street, Exeter, New Hampshire

Phone: (603) 778-0885

TOWN: Kingston	COUNTY: Rockingham	UTM: Z 19/E 329650 /N 4752100
SURVEY NUMBER: 41		USGS QUAD: Haverhill Quad 15' Series
COMMON NAME: Lessard House		FUNCTIONAL TYPE: Residential
HISTORIC NAME: H. R. Downing House		PRESENT USE: Residential
LOCATION: East side of Mill Road, .31 miles S of the inter. of Rte. 111 & Mill Road.		ARCHITECT/BUILDER: Unknown
OWNER: Brian & Marie Lessard		CONDITION: Exc. <input type="checkbox"/> Good <input checked="" type="checkbox"/> Fair <input type="checkbox"/> Poor <input type="checkbox"/> Ruins <input type="checkbox"/>
ADDRESS: 49 Mill Road Kingston, NH.		INTEGRITY: Original Site <input checked="" type="checkbox"/> Moved <input type="checkbox"/> (When: <input type="text"/> )
MAP & PARCEL #: R-12/5		Major alterations & date: <input type="text"/>
DATE: c. 1850		Modified in c.1930
SOURCE: Inspection		LEVEL/SIGNIFICANCE: Natl <input type="checkbox"/> State <input type="checkbox"/> Local <input checked="" type="checkbox"/>
STYLE: Greek Revival		

GENERAL DESCRIPTION: Structural System

1. FOUNDATION: Stone ☒ Brick ☐ Concrete ☐ Concrete Block ☐
2. WALL STRUCTURE: Wood Frame ☐ Post & Beam ☐ Ballon Frame ☒ Other ☐  
Load Bearing Masonry ☐ Stone ☐ Brick ☐ Concrete Block ☐ Other ☐  
Metal ☐ Iron ☐ Steel ☐ Other ☐
3. WALL COVERING: Clapboard ☒ Wood Shingle ☐ Board & Batten ☐ Shiplap ☐ Aluminum ☐  
Novelty ☐ Stucco ☐ Stone ☐ Brick ☐ Sheet Metal ☐ Asphalt Shingles ☐ Vinyl ☐  
Asphalt Sheeting ☐ Composite Board ☐ Other ☐
4. ROOF SHEATHING: Wood Shingle ☐ Asphalt Shingle ☒ Standing Seam Tim ☐ Slate ☐  
Pressed Metal ☐ Sheet Metal ☐ Rolled Asphalt ☐ Other ☐
5. ENGINEERING STRUCTURE:
6. OTHER:  
# of Stories 1 1/2 # of Bays 2x2 Approx. Dimensions 25' x 25' M.B.  
Roof Style: Gable ☒ Hip ☐ Gambrel ☐ Flat ☐ Shed ☐ Mansard ☐ Jerkinhead ☐  
Monitor ☐ Sawtooth ☐ Other ☐  
Appendages: Porches 1 Towers ☐ Dormers ☐ Bay Windows ☐ Ells 2 Chimneys 1  
Wings ☐ Cupolas ☐ Sheds ☐ Garage 1 Other ☐  
Entry Location: Center ☐ Sidehall ☐ Other ☒ via new porch

## MAP (Indicate North in circle):

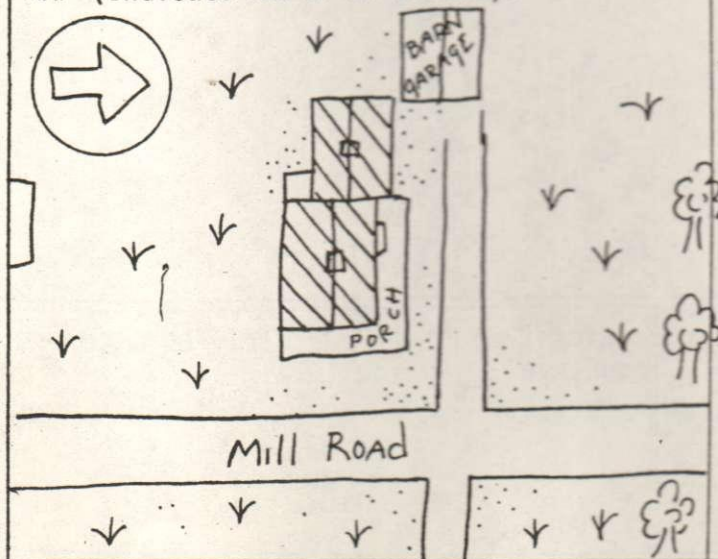

## PHOTO



Description of View: Front-east  
Side-north

Photographer: Herb Bubert  
Negative with: S.R.R.C.  
Negative File Number: K-80-8c/10-10A



#### ADDITIONAL ARCHITECTURAL AND STRUCTURAL DESCRIPTION:

The Lessard House is a 1½-story vernacular structure built around the turn of the century. The entry door is sheltered by a 1-story, shed-roofed enclosed porch that extends along the north and east facades. The porch sits on a concrete block foundation, has clapboard siding, two-over-one windows, and two identical door; each with two panels and three lights.

The main block has a medium-pitched roof topped by a narrow chimney, and the eaves treatment is a boxed cornice. Windows are two-over-two.

A large, 1-story, gable-roofed ell has the same siding, eaves, and windows as the main block, and is topped by a tall corbel-capped stove chimney.

Another 1-story ell has a shed roof with exposed rafters, and rests on a concrete foundation.

**RELATED STRUCTURES AND CONTEXT:** An attached 1½-story, gable-roofed barn has clapboard siding, two-over-two windows, a modern garage door, and a vertical-board hayloft door.

**BOUNDARY AND ACREAGE DESCRIPTION:** 1 acre bounded to the N-Lafayette, S-Mosher, E-Lafayette, W-Mill Road.

#### REFERENCES:

1856 Map H. R. Downing, 1892 Map D. P. Searer

#### STATEMENT OF SIGNIFICANCE (Evaluation & Historical Associations):

This house is a vernacular example from the mid 19th century of a small self-sufficient farm movement.

Map Data: 1856: H. R. Downing  
1892: D. P. Searer

**SURROUNDING ENVIRONMENT:** Open Land ☒ Woodland ☒ Scattered Bldgs ☐ Moderately Built Up ☒  
Densely Built Up ☐ Residential ☒ Commercial ☐ Industrial ☐ Agricultural ☐  
Roadside Strip Development ☐ Other ☐

Recorded By: Scott Novak  
Herb Bubert

Date: 2/13/80



