

## HISTORIC PRESERVATION ASSISTANCE PROJECT

Strafford Rockingham Regional Council

1 Water Street, Exeter, New Hampshire

Phone: (603) 778-0885

TOWN: Kingston	COUNTY: Rockingham	UTM: Z 19 /E 329600 /N 4752775
SURVEY NUMBER: 42		USGS QUAD: Haverhill Quad 15' series
COMMON NAME: McLure House		FUNCTIONAL TYPE: Dwelling
HISTORIC NAME: Page House		PRESENT USE: Residential
LOCATION: W. side Mill Rd., .31 Mi. W of intersection of Rt. 111 and Mill Rd.		ARCHITECT/BUILDER: Unknown
OWNER: Roger & Mary McLure		CONDITION: Exc. <u>Good</u> Fair <u>X</u> Poor Ruins
ADDRESS: 52 Mill Road, Kingston, NH		INTEGRITY: Original Site <u>X</u> Moved (When: )
MAP & PARCEL #: R22-21		Major alterations & date: Asbestos shingle siding added, date unknown.
DATE: C. 1850		LEVEL/SIGNIFICANCE: Natl State Local <u>X</u>
SOURCE: Inspection		
STYLE: Greek Revival		

GENERAL DESCRIPTION: Structural System

- FOUNDATION: Stone X Brick Concrete Concrete Block
- WALL STRUCTURE: Wood Frame Post & Beam Ballon Frame X Other  
Load Bearing Masonry Stone Brick Concrete Block Other  
Metal Iron Steel Other
- WALL COVERING: Clapboard Wood Shingle Board & Batten Shiplap Aluminum  
Novelty Stucco Stone Brick Sheet Metal Asphalt Shingles Vinyl  
Asphalt Sheeting Composite Board Other Asbestos Shingles
- ROOF SHEATHING: Wood Shingle Asphalt Shingle X Standing Seam Tim Slate  
Pressed Metal Sheet Metal Rolled Asphalt Other
- ENGINEERING STRUCTURE:
- OTHER:  
# of Stories 1 # of Bays 3X3 Approx. Dimensions 20' X 24'  
Roof Style: Gable X Hip Gambrel Flat Shed Mansard Jerkinhead  
Monitor Sawtooth Other  
Appendages: Porches 1 Towers Dormers Bay Windows Ells 1 Chimneys 1 on TD  
Wings 1 Cupolas Sheds Garage 1 Other 1 on ell  
Entry Location: Center Sidehall Other

## MAP (Indicate North in circle):

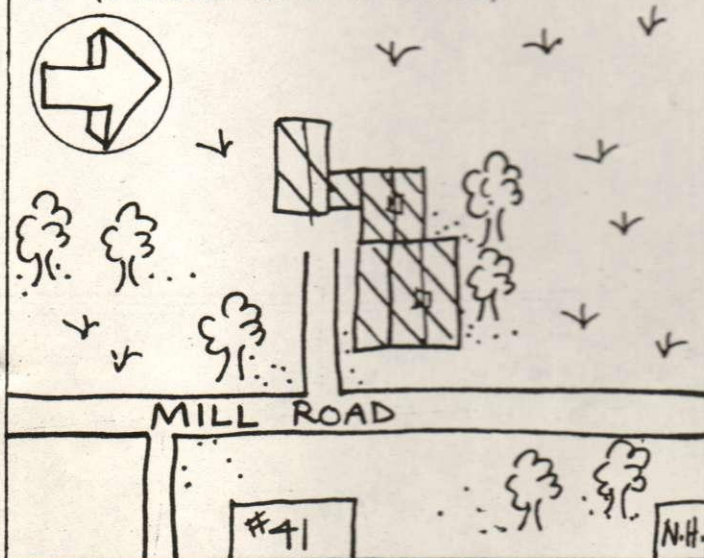

## PHOTO

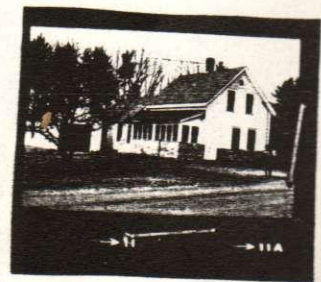

## Description of View:

Front (E) Side (S)

Photographer: Herb Bubert

Negative with: S.R.R.C.

Negative File Number: K-80-8-C/11-11A



**ADDITIONAL ARCHITECTURAL AND STRUCTURAL DESCRIPTION:**

The McLure house is a 1 1/2 story, gable-roofed, greek revival style structure. The sidehall entry has been covered over and the house is now entered by a 1 story, shed-roofed enclosed porch on the south elevation. The windows on the main block have two over two six over one, and six over two each, framed by architrave trim and projecting caps. The medium pitched roof is topped by a narrow, corbel capped chimney and the roofline has a boxed cornice with a sloped soffit along the lateral eaves. Simulated stone siding has been applied to the porch and the lower front facade of the main block. The structure rests upon a fieldstone foundation. The 1 story gable roofed ell has asbestos shingle siding, two over two windows, a narrow corbel capped chimney and a fieldstone foundation. A 1 story flat roofed wing projects to the south of the main block and connects with a 1 story, gable roofed garage.

**RELATED STRUCTURES AND CONTEXT:** Attached 1 story gabled roof garage with new garage door and asbestos siding.

**BOUNDARY AND ACREAGE DESCRIPTION:** 1.5 Acres. Bounded to the N. by the Senters, S. by the Raymonds, E. by Mill Road, W. by the Deuosts.

**REFERENCES:**

1856 Map  
1892 Map

**STATEMENT OF SIGNIFICANCE (Evaluation & Historical Associations):**

The Page House is a vernacular, mid-19th century house which has been modified fairly recently with the addition of asbestos siding and stone face veneer.

Map Data: 1856: Page  
1892: M. G. Wilson

MAP DATA 1892-M G Wilson? 1856-Page?

**SURROUNDING ENVIRONMENT:** Open Land ☐ Woodland ☐ Scattered Bldgs ☐ Moderately Built Up ☐  
Densely Built Up ☐ Residential ☒ Commercial ☐ Industrial ☐ Agricultural ☐  
Roadside Strip Development ☐ Other ☐

Recorded By: H. Bubert, S. Novak

Date: 2/13/80



