

HISTORIC PRESERVATION ASSISTANCE PROJECT

Strafford Rockingham Regional Council

1 Water Street, Exeter, New Hampshire

Phone: (603) 778-0885

TOWN: Kingston	COUNTY: Rockingham	UTM: Z 19 /E 330325 /N 4750925
SURVEY NUMBER: 50		USGS QUAD: Haverhill Quad 15' series
COMMON NAME: The Driscoll House		FUNCTIONAL TYPE: Residential
HISTORIC NAME: Dr. Sleeper House		PRESENT USE: Residence
LOCATION: NW side Old Mill Rd., .46 mi. N. of S. intersection of Old Mill Rd. & Rt.		ARCHITECT/BUILDER: Unknown
OWNER: John P. Sebetes, Jr. 125		CONDITION: Exc. <input checked="" type="checkbox"/> Good <input checked="" type="checkbox"/> Fair <input type="checkbox"/> Poor <input type="checkbox"/> Ruins
ADDRESS: 26 Old Mill Rd., Kingston, NH		INTEGRITY: Original Site <input checked="" type="checkbox"/> Moved <input type="checkbox"/> (When: <input type="text"/>)
MAP & PARCEL #: R11-26		Major alterations & date: Unknown
DATE: C. 1750		
SOURCE: Inspection		
STYLE: Georgian Cape		LEVEL/SIGNIFICANCE: Natl <input type="checkbox"/> State <input type="checkbox"/> Local <input checked="" type="checkbox"/>

GENERAL DESCRIPTION: Structural System

- FOUNDATION: Stone ☒ Brick ☐ Concrete ☐ Concrete Block ☐
- WALL STRUCTURE: Wood Frame ☐ Post & Beam ☐ Ballon Frame ☐ Other ☐
Load Bearing Masonry ☐ Stone ☐ Brick ☐ Concrete Block ☐ Other ☐
Metal ☐ Iron ☐ Steel ☐ Other ☐
- WALL COVERING: Clapboard ☒ Wood Shingle ☐ Board & Batten ☐ Shiplap ☐ Aluminum ☐
Novelty ☐ Stucco ☐ Stone ☐ Brick ☐ Sheet Metal ☐ Asphalt Shingles ☐ Vinyl ☐
Asphalt Sheeting ☐ Composite Board ☐ Other ☐
- ROOF SHEATHING: Wood Shingle ☐ Asphalt Shingle ☐ Standing Seam Tim ☐ Slate ☐
Pressed Metal ☐ Sheet Metal ☐ Rolled Asphalt ☐ Other ☐
- ENGINEERING STRUCTURE:
- OTHER:
of Stories 1 # of Bays 5X2 Approx. Dimensions 30' X 20'
Roof Style: Gable ☒ Hip ☐ Gambrel ☐ Flat ☐ Shed ☐ Mansard ☐ Jerkinhead ☐
Monitor ☐ Sawtooth ☐ Other ☐
Appendages: Porches 1 Towers ☐ Dormers ☐ Bay Windows ☐ Ells 1 Chimneys 1 on MD
Wings 2 Cupolas ☐ Sheds 1 Garage ☐ Other ☐
Entry Location: Center ☒ Sidehall ☐ Other ☐ 1 on wing

MAP (Indicate North in circle):

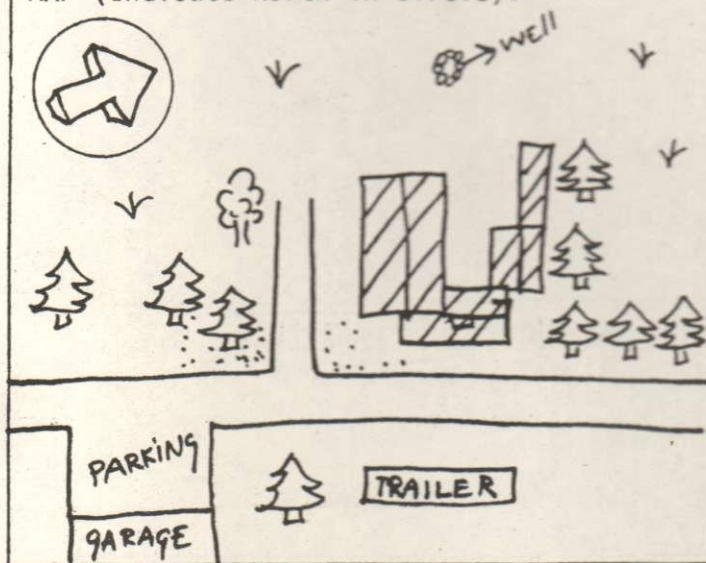

PHOTO



Description of View:

Front (SW) side (SE)

Photographer: Herb Bubert

Negative with: S.R.R.C.

Negative File Number: K-80-86/20-20A

ADDITIONAL ARCHITECTURAL AND STRUCTURAL DESCRIPTION:

The Driscoll house is a 1½ story, georgian cape style house which features several victorian era windows with decoratively arranged sash and shutters. The center entry has a 5 panelled door with one large light. The medium pitched roof is topped by a narrow, corbel-capped chimney and the roofline has close raking and lateral eaves. The structure rests upon a fieldstone foundation. On the southeast facade is a 1 story portico which leads to a 1 story gable roofed ell. On the northwest elevation of the ell is a 1 story gable roofed wing which has an attached shed on its northwest elevation.

RELATED STRUCTURES AND CONTEXT:

BOUNDARY AND ACREAGE DESCRIPTION: Bounded to the N. by Senter, and Great Lakes Container Corp, S. by the Holts, W. by the Senters, E. by Old Mill Road.

10 acres

REFERENCES:

1856 Map & 1892 Map

STATEMENT OF SIGNIFICANCE (Evaluation & Historical Associations):

Dr. Sleeper House is a typical example of a Georgian cape as exemplified by small narrow windows which rise to meet the eaveline of the steeply pitched roof.

Map Data: 1856: Dr. Sleeper
1892: Mrs. A. Hunt

SURROUNDING ENVIRONMENT: Open Land ☐ Woodland ☐ Scattered Bldgs ☐ Moderately Built Up ☐
Densely Built Up ☐ Residential ☐ Commercial ☐ Industrial ☐ Agricultural ☐
Roadside Strip Development ☐ Other ☐

Recorded By: H. P. ... , D. Now...

Date: 2/14/80

