

HISTORIC PRESERVATION ASSISTANCE PROJECT

Strafford Rockingham Regional Council

1 Water Street, Exeter, New Hampshire

Phone: (603) 778-0885

TOWN: Kingston	COUNTY: Rockingham	UTM: Z 19 /E 329500 /N 4753000
SURVEY NUMBER: 60		USGS QUAD: Haverhill Quad 15' Series
COMMON NAME: Cross House		FUNCTIONAL TYPE: Residential
HISTORIC NAME: J. K. Kimball House		PRESENT USE: Residential
LOCATION: NE side of Danville Rd. .12 miles west of the inter. of Cheney Mill Road. 65 Danville Rd.		ARCHITECT/BUILDER: Unknown
OWNER: Robert Cross	CONDITION: Exc. <input type="checkbox"/> Good <input checked="" type="checkbox"/> Fair <input type="checkbox"/> Poor <input type="checkbox"/> Ruins <input type="checkbox"/>	
ADDRESS: 442 Main Street Haverhill, Mass.	INTEGRITY: Original Site <input checked="" type="checkbox"/> Moved <input type="checkbox"/> (When: <input type="checkbox"/>)	
MAP & PARCEL #: R-22/49	Major alterations & date: <input type="text"/>	
DATE: c. 1840		
SOURCE: Inspection		
STYLE: Federal Cape	LEVEL/SIGNIFICANCE: Natl <input type="checkbox"/> State <input type="checkbox"/> Local <input checked="" type="checkbox"/>	

GENERAL DESCRIPTION: Structural System

1. FOUNDATION: Stone ☒ Brick ☒ Concrete ☐ Concrete Block ☐
2. WALL STRUCTURE: Wood Frame ☐ Post & Beam ☐ Ballon Frame ☐ Other ☐
Load Bearing Masonry ☐ Stone ☐ Brick ☐ Concrete Block ☐ Other ☐
Metal ☐ Iron ☐ Steel ☐ Other ☐
3. WALL COVERING: Clapboard ☒ Wood Shingle ☐ Board & Batten ☐ Shiplap ☐ Aluminum ☐
Novelty ☐ Stucco ☐ Stone ☐ Brick ☐ Sheet Metal ☐ Asphalt Shingles ☐ Vinyl ☐
Asphalt Sheeting ☐ Composite Board ☐ Other ☐
4. ROOF SHEATHING: Wood Shingle ☐ Asphalt Shingle ☒ Standing Seam Tim ☐ Slate ☐
Pressed Metal ☐ Sheet Metal ☐ Rolled Asphalt ☐ Other ☐
5. ENGINEERING STRUCTURE:
6. OTHER:
of Stories 1 1/2 # of Bays 5x2 Approx. Dimensions 34' x 30' M.B.
Roof Style: Gable ☒ Hip ☐ Gambrel ☐ Flat ☐ Shed ☐ Mansard ☐ Jerkinhead ☐
Monitor ☐ Sawtooth ☐ Other ☐
Appendages: Porches 1 Towers ☐ Dormers 1 Bay Windows ☐ Ells ☐ Chimneys 2
Wings 1 Cupolas ☐ Sheds ☐ Garage ☐ Other ☐
Entry Location: Center ☒ Sidehall ☐ Other ☐

MAP (Indicate North in circle):

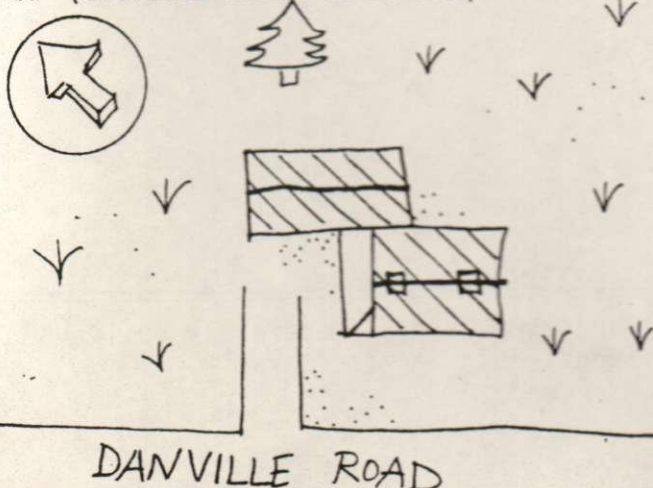

PHOTO



Description of View: Front-north
Side-east

Photographer: Scott Novak
Negative with: S.R.R.C.
Negative File Number: K-80-8c/35-5A

ADDITIONAL ARCHITECTURAL AND STRUCTURAL DESCRIPTION:

The Cross House is a 1½-story Federal Cape style structure. The central entry door has four panels and one large light. Windows are two-over-two. Treatment at the eaves consists of a boxed cornice with gable end returns. The medium-pitched roof is topped by two chimneys, and the northeast slope is topped with a shed dormer. There is an open shed-roofed porch along the northwest elevation of the main block.

A 1-story, gable-roofed wing to the west has the same cornice treatment and windows as the main block, and wood shingle siding.

RELATED STRUCTURES AND CONTEXT:

BOUNDARY AND ACREAGE DESCRIPTION: .8 acres bounded to the N-Cross, S-Danville Road, E-Cross, W-Danville Road, Cross.

REFERENCES:

1856 Map
1892 Map

STATEMENT OF SIGNIFICANCE (Evaluation & Historical Associations):

The J. K. Kimball House is a fine example of a Federal style cape with a steeply pitched roof and very small windows.

Map Data: 1856: J. K. Kimball
1892: G. Martin

MAP DATA 1892-G. Martin

SURROUNDING ENVIRONMENT: Open Land ☒ Woodland ☐ Scattered Bldgs ☒ Moderately Built Up ☐
Densely Built Up ☐ Residential ☐ Commercial ☐ Industrial ☐ Agricultural ☐
Roadside Strip Development ☐ Other ☐

Recorded By: Scott Novak
Herb Bubert

Date: 2/27/80

