

HISTORIC PRESERVATION ASSISTANCE PROJECT

Strafford Rockingham Regional Council

1 Water Street, Exeter, New Hampshire

Phone: (603) 778-0885

TOWN: Kingston	COUNTY: Rockingham	UTM: Z 19 /E 329650 /N 4753050
SURVEY NUMBER: 68		USGS QUAD: Haverhill Quad 15' series
COMMON NAME: Patterson House		FUNCTIONAL TYPE: Dwelling
HISTORIC NAME: E. J. Webster House		PRESENT USE: Residential
LOCATION: E. side Cheney Mill Rd., .63 Mi. E. intersection Cheney Mill Rd. & Long Pond Rd.		ARCHITECT/BUILDER: Unknown
OWNER: Carl Patterson		CONDITION: Exc. <u>Good</u> <input checked="" type="checkbox"/> Fair <u>Poor</u> <u>Ruins</u>
ADDRESS: 5 Cheney Mill Rd., Kingston, NH		INTEGRITY: Original Site <input checked="" type="checkbox"/> Moved <u> </u> (When: <u> </u>)
MAP & PARCEL #: R22-51		Major alterations & date: Porch and shed dormer added dates unknown
DATE: C. 1820		LEVEL/SIGNIFICANCE: Natl <u>State</u> Local <input checked="" type="checkbox"/>
SOURCE: Inspection		
STYLE: Federal Cape		

GENERAL DESCRIPTION: Structural System

- FOUNDATION: Stone ☒ Brick Concrete Concrete Block
- WALL STRUCTURE: Wood Frame Post & Beam ☒ Ballon Frame Other
Load Bearing Masonry Stone Brick Concrete Block Other
Metal Iron Steel Other
- WALL COVERING: Clapboard ☒ Wood Shingle Board & Batten Shiplap Aluminum
Novelty Stucco Stone Brick Sheet Metal Asphalt Shingles Vinyl
Asphalt Sheeting Composite Board Other
- ROOF SHEATHING: Wood Shingle Asphalt Shingle ☒ Standing Seam Tim Slate
Pressed Metal Sheet Metal Rolled Asphalt Other
- ENGINEERING STRUCTURE:
- OTHER:
of Stories 1 # of Bays 5 Approx. Dimensions 24' X 34'
Roof Style: Gable ☒ Hip Gambrel Flat Shed Mansard Jerkinhead
Monitor Sawtooth Other
Appendages: Porches 1 Towers Dormers 1 Bay Windows Ells 2 Chimneys 1
Wings 1 Cupolas Sheds 1 Garage Other
Entry Location: Center Sidehall Other

MAP (Indicate North in circle):

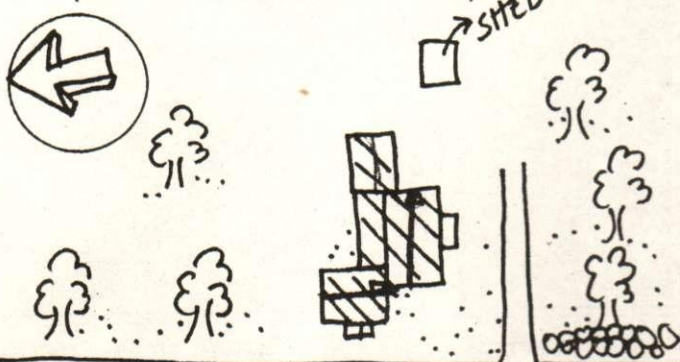

CHENEY MILL ROAD

PHOTO



Description of View:

Front (NW) Side (NE)

Photographer: Herb Bubert

Negative with: S.R.R.C.

Negative File Number: K80-9C-11A-12

ADDITIONAL ARCHITECTURAL AND STRUCTURAL DESCRIPTION:

The Patterson House is a 1 1/2 story Cape built in the Federal Style. The center entry has a 4 panelled door with one light and is sheltered by a 1 story, gable roofed, enclosed porch. All of the windows have nine over six sash with molded trim. A 2-bay shed dormer is located on the northeast elevation. The long lateral roof is topped by a narrow, corbel-capped chimney and the roofline has close siding and lateral eaves. A fieldstone foundation supports the structure.

A 1 story gable roofed wing projects to the east. It has clapboard siding, recent windows, and a concrete block foundation. The 1 story, shed roofed ell has clapboard siding, recent windows, and a fieldstone foundation. The 1 story gable roofed ell has clapboard siding, nine over six windows and a fieldstone foundation.

RELATED STRUCTURES AND CONTEXT: A separate 1 story, gable roofed shed is located to the southeast of the main block.

BOUNDARY AND ACREAGE DESCRIPTION: 1.1 Acres. Bounded to the N. by land of the Nasons, S. & E. by land of the Cross family, W. by Cheney Mill Road.

REFERENCES:

1856 Map
1892 Map

STATEMENT OF SIGNIFICANCE (Evaluation & Historical Associations):

The E. J. Webster House is a modified example of a Federal Cape. The pavillion masses the Federal entry on the facade.

Map Data: 1856: E. J. Webster
1892: Mrs. E. George

SURROUNDING ENVIRONMENT: Open Land ☐ Woodland ☐ Scattered Bldgs ☐ Moderately Built Up ☐
Densely Built Up ☐ Residential ☐ Commercial ☐ Industrial ☐ Agricultural ☐
Roadside Strip Development ☐ Other ☐

Recorded By:

Date: 2/27/00

