

# HISTORIC PRESERVATION ASSISTANCE PROJECT

Strafford Rockingham Regional Council

1 Water Street, Exeter, New Hampshire

Phone: (603) 778-0885

TOWN: Kingston	COUNTY: Rockingham
SURVEY NUMBER: 72 Central	
COMMON NAME: The Sweetland House	
HISTORIC NAME: Col. S. Winslow House	
LOCATION: W. side Ball Rd., .03 Mi. N. of intersection Danville Rd. & Ball Rd.	
OWNER: Vincent Sweetland	
ADDRESS: 2 Ball Rd., Kingston, NH	
MAP & PARCEL #: R22-54	
DATE: C. 1855	
SOURCE: Inspection	
STYLE: Italianate (modified)	

UTM: Z 18 /E 330150 /N 4752900
USGS QUAD: Haverhill Quad 17' series
FUNCTIONAL TYPE: Residence
PRESENT USE: Residence
ARCHITECT/BUILDER: Unknown
CONDITION: Exc. Good Fair Poor Ruins
INTEGRITY: Original Site Moved (When: )
Major alterations & date: Addition of single
Leveling added date unknown
LEVEL/SIGNIFICANCE: Natl State Local

## GENERAL DESCRIPTION: Structural System

1. FOUNDATION: Stone Brick Concrete Concrete Block
2. WALL STRUCTURE: Wood Frame Post & Beam Ballon Frame Other  
Load Bearing Masonry Stone Brick Concrete Block Other  
Metal Iron Steel Other
3. WALL COVERING: Clapboard Wood Shingle Board & Batten Shiplap Aluminum  
Novelty Stucco Stone Brick Sheet Metal Asphalt Shingles Vinyl  
Asphalt Sheeting Composite Board Other
4. ROOF SHEATHING: Wood Shingle Asphalt Shingle Standing Seam Tim Slate  
Pressed Metal Sheet Metal Rolled Asphalt Other
5. ENGINEERING STRUCTURE:
6. OTHER:  
# of Stories 2 # of Bays Approx. Dimensions 20' x 20'  
Roof Style: Gable Hip Gambrel Flat Shed Mansard Jerkinhead  
Monitor Sawtooth Other  
Appendages: Porches Towers Dormers Bay Windows Ells Chimneys  
Wings Cupolas Sheds Garage Other  
Entry Location: Center Sidehall Other

## MAP (Indicate North in circle):

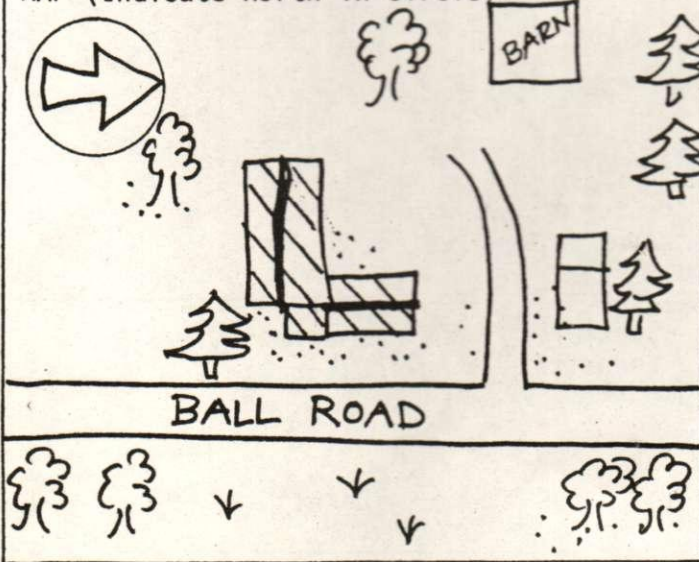

## PHOTO



## Description of View:

From (S) (N) (E) (W)

Photographer:

Negative with S.R.R.C.

Negative File Number: 100-11-15



### ADDITIONAL ARCHITECTURAL AND STRUCTURAL DESCRIPTION:

The Sweetland house is a 2 story Italianate style structure which has been altered by the addition of asbestos shingle siding. The center entry has a multi-panelled door with one large light. It is sheltered by a shed roofed doorhood supported by square brackets. Most of the windows have two over one sash framed by architrave trim. Two narrow one over one windows are located above the entrance. A 2 story bay window with narrow one over one lights is located on the front facade. The steeply pitched roof is topped by a narrow, corbel capped chimney and the roofline has a boxed cornice with gable end returns. A brick foundation supports the main block.

A 1 story shed roofed enclosed porch is located on the east elevation of the main block. The 1 story gable roofed ell has asbestos shingle siding, two over two windows framed by architrave trim, and 6 panelled doors. The roof is topped by a narrow chimney and the structure is supported by a brick and fieldstone foundation.

**RELATED STRUCTURES AND CONTEXT:** To the northwest of the main block is a separate 1 story, gable roofed barn with board and batten siding, fixed six pane windows, a sliding vertical board door, and a concrete block foundation. To the north of the main block is a separate 1 story, gable roofed shed with an attached 1 story, shed roofed shed on its

### BOUNDARY AND ACREAGE DESCRIPTION:

27 Acres. Bounded to the N. by Nason, Dunn, S. by Danville Road, E. by Ball Road, W. by McGlynn.

elevation.

### REFERENCES:

1856 Map S. S. Winslow, 1892 Map S. S. Winslow

### STATEMENT OF SIGNIFICANCE (Evaluation & Historical Associations):

A basic 5x2 bay, 2½ story house plan from the mid-19th century which seems to have been updated around the turn of the century with the addition of the shallow, 3-part, 2-bay, bay window, and matching paired windows over the center entry which is topped by a simple shed roof doorhood.

Map Data: 1856: Col. S. Winslow  
1892: S. S. Winslow

**SURROUNDING ENVIRONMENT:** Open Land ☐ Woodland ☐ Scattered Bldgs ☐ Moderately Built Up ☐  
Densely Built Up ☐ Residential ☐ Commercial ☐ Industrial ☐ Agricultural ☐  
Roadside Strip Development ☐ Other ☐

Recorded By:

Date: 2/28/90



