

## HISTORIC PRESERVATION ASSISTANCE PROJECT

Strafford Rockingham Regional Council

1 Water Street, Exeter, New Hampshire

Phone: (603) 778-0885

TOWN: Kingston	COUNTY: Rockingham	UTM: Z 19 /E 332150 /N 4753650
SURVEY NUMBER: 89		USGS QUAD: Haverhill Quad 15' series
COMMON NAME: The Simes House		FUNCTIONAL TYPE: Farmhouse
HISTORIC NAME: J. F. Tucker House		PRESENT USE: Residential
LOCATION: N. side New Boston Rd. @ intersection New Boston Rd. & Main St. on NE Corner		ARCHITECT/BUILDER: Unknown
OWNER: Lyonia & Sarah Simes heirs		CONDITION: Exc. <u>Good</u> <u>X</u> Fair <u>Poor</u> <u>Ruins</u>
ADDRESS: 2 New Boston Rd., Kingston, NH		INTEGRITY: Original Site <u>X</u> Moved <u>    </u> (When: <u>    </u> )
MAP & PARCEL #: R26-1		Major alterations & date: Asbestos shingles added, date unknown, Wing added C. 1950
DATE: C. 1890		LEVEL/SIGNIFICANCE: Natl <u>    </u> State <u>    </u> Local <u>X</u>
SOURCE: Inspection		
STYLE: Late 19th Century Cottage		

GENERAL DESCRIPTION: Structural System

- FOUNDATION: Stone X Brick      Concrete      Concrete Block
- WALL STRUCTURE: Wood Frame      Post & Beam      Ballon Frame X Other       
Load Bearing Masonry      Stone      Brick      Concrete Block      Other       
Metal      Iron      Steel      Other
- WALL COVERING: Clapboard      Wood Shingle      Board & Batten      Shiplap      Aluminum       
Novelty      Stucco      Stone      Brick      Sheet Metal      Asphalt Shingles      Vinyl       
Asphalt Sheeting      Composite Board      Other Asbestos shingles & simulated stone
- ROOF SHEATHING: Wood Shingle      Asphalt Shingle X Standing Seam Tim      Slate       
Pressed Metal      Sheet Metal      Rolled Asphalt      Other
- ENGINEERING STRUCTURE:
- OTHER:  
# of Stories 1½ # of Bays 2X2 Approx. Dimensions 15' X 24'  
Roof Style: Gable X Hip      Gambrel      Flat      Shed      Mansard      Jerkinhead       
Monitor      Sawtooth      Other       
Appendages: Porches 1 Towers      Dormers      Bay Windows      Ells 1 Chimneys 1 on MB  
Wings 1 Cupolas      Sheds      Garage 1 Other Barn 1 on ell  
Entry Location: Center      Sidehall      Other Via porch

MAP (Indicate North in circle):

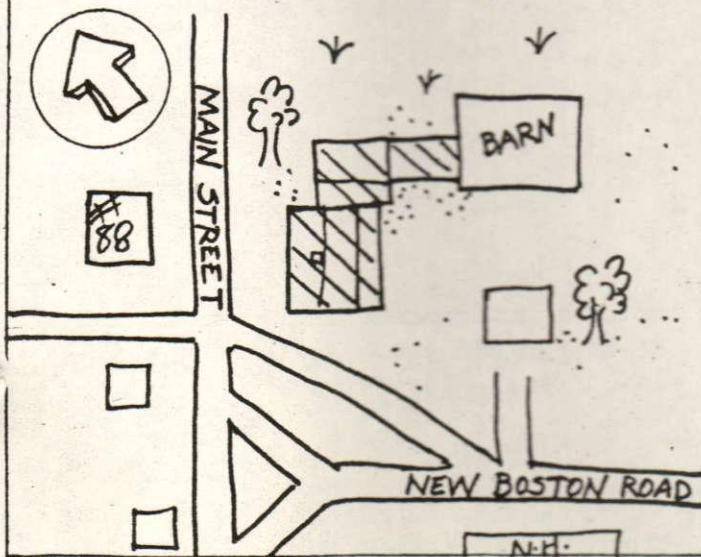

PHOTO



Description of View:  
Front (SW) Side (NW)

Photographer: Herb Bubert  
Negative with: S.R.R.C.  
Negative File Number: k80-9C-33A-34



#### ADDITIONAL ARCHITECTURAL AND STRUCTURAL DESCRIPTION:

The Simes house is a  $1\frac{1}{2}$  story late nineteenth century cottage which has been extensively remodeled including the addition of asbestos shingle and simulated stone siding. The house is entered through a 1 story, shed roofed, enclosed porch with two over one windows and a 3 panelled door with nine lights. All of the windows on the main block have two over two sash and molded surrounds. The medium pitched roof is topped by a narrow chimney and the eaves treatment consists of a boxed cornice with gable end returns.

The  $1\frac{1}{2}$  story, gable roofed ell has the same siding as the main block. It has one over one and two over two windows, a fieldstone foundation, and is topped by narrow corbel capped chimney. To the southeast of the ell is a 1 story, gable roofed wing with two over one windows, a vertical board door, and a concrete block foundation.

**RELATED STRUCTURES AND CONTEXT:** Attached to the wing and projecting to the southeast is a  $1\frac{1}{2}$  story, gable roofed barn with clapboard and asphalt shingle siding, two over two windows, double vertical board doors and a fieldstone foundation. A separate 1-story gable roofed garage is located to the south of the house.

**BOUNDARY AND ACREAGE DESCRIPTION:** 17 Acres. Bounded to the N. by Boyington, S. by New Boston Road and Simes, E. by State of N.H., W. by Main Street.

#### REFERENCES:

1892 Map J. F. Tucker

#### STATEMENT OF SIGNIFICANCE (Evaluation & Historical Associations):

The Simes house is of no particular architectural significance.

MAP DATA: 1892: J. F. Tucker

**SURROUNDING ENVIRONMENT:** Open Land ☒ Woodland ☐ Scattered Bldgs ☒ Moderately Built Up ☐  
Densely Built Up ☐ Residential ☐ Commercial ☐ Industrial ☐ Agricultural ☐  
Roadside Strip Development ☐ Other ☐

Recorded By:

Date: 3/4/80



