

HISTORIC PRESERVATION ASSISTANCE PROJECT
Strafford Rockingham Regional Council
1 Water Street, Exeter, New Hampshire
Phone: (603) 778-0885

TOWN: <u>Kingston</u>	COUNTY: <u>Rockingham</u>
SURVEY NUMBER: <u>99</u>	
COMMON NAME: <u>Marshall House</u>	
HISTORIC NAME: <u>Kimball House</u>	
LOCATION: <u>SW side of Rte. 107A, .22 miles Southwest of intersection of Depot Road.</u>	
OWNER: <u>J.E. Marshall</u>	
ADDRESS: <u>9 Powwow River Road</u> <u>Kingston, NH.</u>	
MAP & PARCEL #: <u>R-28/9</u>	
DATE: <u>c. 1910</u>	
SOURCE: <u>Inspection</u>	
STYLE: <u>Bungalow</u>	

UTM: <u>Z 19 /E 333300 /N 4754500</u>
USGS QUAD: <u>Haverhill Quad 15' Series</u>
FUNCTIONAL TYPE: <u>Residential</u>
PRESENT USE: <u>Residential</u>
ARCHITECT/BUILDER: <u>Unknown</u>
CONDITION: <u>Exc.</u> <input checked="" type="checkbox"/> <u>Good</u> <input type="checkbox"/> <u>Fair</u> <input type="checkbox"/> <u>Poor</u> <input type="checkbox"/> <u>Ruins</u> <input type="checkbox"/>
INTEGRITY: Original Site <input checked="" type="checkbox"/> <u>Moved</u> <input type="checkbox"/> (When: <u> </u>)
Major alterations & date: <u> </u>
LEVEL/SIGNIFICANCE: <u>Nat'l</u> <u>State</u> <u>Local</u> <input checked="" type="checkbox"/>

GENERAL DESCRIPTION: Structural System

- FOUNDATION: Stone ☒ Brick ☐ Concrete ☐ Concrete Block ☐
- WALL STRUCTURE: Wood Frame ☐ Post & Beam ☐ Ballon Frame ☒ Other ☐
Load Bearing Masonry ☐ Stone ☐ Brick ☐ Concrete Block ☐ Other ☐
Metal ☐ Iron ☐ Steel ☐ Other ☐
- WALL COVERING: Clapboard ☐ Wood Shingle ☒ Board & Batten ☐ Shiplap ☐ Aluminum ☐
Novelty ☐ Stucco ☐ Stone ☐ Brick ☐ Sheet Metal ☐ Asphalt Shingles ☐ Vinyl ☐
Asphalt Sheeting ☐ Composite Board ☐ Other ☐
- ROOF SHEATHING: Wood Shingle ☐ Asphalt Shingle ☒ Standing Seam Tin ☐ Slate ☐
Pressed Metal ☐ Sheet Metal ☐ Rolled Asphalt ☐ Other ☐
- ENGINEERING STRUCTURE:
- OTHER:
of Stories 1 1/2 # of Bays 3x3 Approx. Dimensions 30' x 26'
Roof Style: Gable ☐ Hip ☒ Gambrel ☐ Flat ☐ Shed ☐ Mansard ☐ Jerkinhead ☐
Monitor ☐ Sawtooth ☐ Other ☐
Appendages: Porches 2 Towers ☐ Dormers 4 Bay Windows ☐ Ells ☐ Chimneys 1
Wings 1 Cupolas ☐ Sheds 2 Garage 1 Other ☐
Entry Location: Center ☒ Sidehall ☐ Other ☐

MAP (Indicate North in circle):

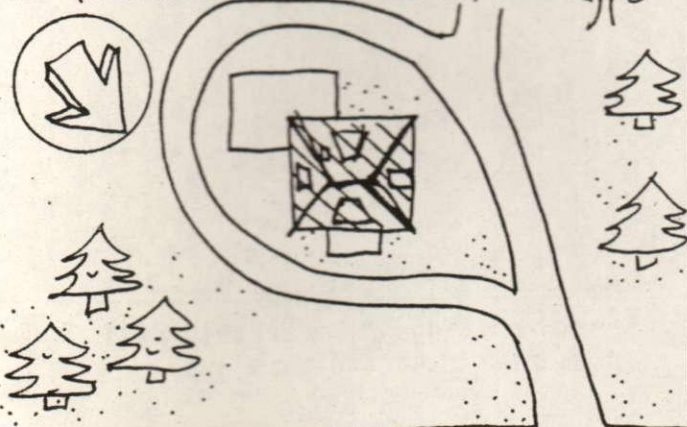

ROUTE 107A

PHOTO

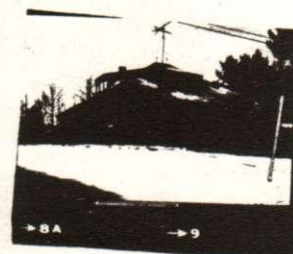

Description of View: Front-north
Side-east

Photographer: Herb Bubert
Negative with: S.R.R.C.
Negative File Number: K-80-10c/8A-9

ADDITIONAL ARCHITECTURAL AND STRUCTURAL DESCRIPTION:

The Marshall House is a 1½-story Bungalow style structure. The multi-paneled center entry door has eight lights and dentils. It is sheltered by a shed-roofed porch which is supported by square, tapering columns that rest on fieldstone piers. Windows have eight-over-one, eight-over-two, and six-over-one sash. The medium-pitched roof is topped by four shed-roofed dormers, and the cornice treatment consists of projecting eaves with exposed rafters. The entire structure rests on a rusticated cement foundation.

A screened 1-story porch on the rear has a hipped-roof with exposed rafters.

A 1-story shed-roofed wing to the northwest has the same siding, windows, eave treatment and foundation as the main block.

RELATED STRUCTURES AND CONTEXT: 1-story, gable-roofed, garage rests on a fieldstone foundation. Swimming pool, and 2 sheds.

BOUNDARY AND ACREAGE DESCRIPTION: .8 acres bounded to the N-Powwow River Road, Fuller, S-Bakie, E-Powwow River Road, W-Bakie, Fuller.

REFERENCES:

Kingston Historic Advisory Committee, interviews w/members, Spring 1980

STATEMENT OF SIGNIFICANCE (Evaluation & Historical Associations):

The Marshall House is a well developed example of the Bungalow Style said to be the last truly original American style. The rustic shingle siding and rusticated foundation as well as the sweeping rooflines are all hallmarks of this popular style.

SURROUNDING ENVIRONMENT: Open Land ☒ Woodland ☒ Scattered Bldgs ☒ Moderately Built Up ☐
Densely Built Up ☐ Residential ☐ Commercial ☐ Industrial ☐ Agricultural ☐
Roadside Strip Development ☐ Other ☐

Recorded By: Scott Novak
Herb Bubert

Date: 3/12/80

