

HISTORIC PRESERVATION ASSISTANCE PROJECT

Strafford Rockingham Regional Council

1 Water Street, Exeter, New Hampshire

Phone: (603) 778-0885

TOWN: Kingston	COUNTY: Rockingham	UTM: Z 19 /E 332550 /N 4754900
SURVEY NUMBER: 114		USGS QUAD: Haverhill Quad 15' series
COMMON NAME: The Quigley House		FUNCTIONAL TYPE: Residential
HISTORIC NAME: W. Abrahams House		PRESENT USE: Residence
LOCATION: N. side Scotland Rd., .30 Mi. W. Intersection Depot Road		ARCHITECT/BUILDER: Unknown
OWNER: David Quigley		CONDITION: Exc. <input checked="" type="checkbox"/> Good <input checked="" type="checkbox"/> Fair <input type="checkbox"/> Poor <input type="checkbox"/> Ruins <input type="checkbox"/>
ADDRESS: 10 Scotland Rd., Kingston, NH		INTEGRITY: Original Site <input checked="" type="checkbox"/> Moved <input type="checkbox"/> (When: <input type="text"/>)
MAP & PARCEL #: U9 - 53		Major alterations & date: Unknown
DATE: C. 1820		
SOURCE: Assessors Office Kingston		
STYLE: Federal Cape		LEVEL/SIGNIFICANCE: Natl <input type="checkbox"/> State <input type="checkbox"/> Local <input checked="" type="checkbox"/>

GENERAL DESCRIPTION: Structural System

1. FOUNDATION: Stone ☒ Brick ☐ Concrete ☐ Concrete Block ☐
2. WALL STRUCTURE: Wood Frame ☐ Post & Beam ☒ Ballon Frame ☐ Other ☐
Load Bearing Masonry ☐ Stone ☐ Brick ☐ Concrete Block ☐ Other ☐
Metal ☐ Iron ☐ Steel ☐ Other ☐
3. WALL COVERING: Clapboard ☒ Wood Shingle ☐ Board & Batten ☐ Shiplap ☐ Aluminum ☐
Novelty ☐ Stucco ☐ Stone ☐ Brick ☐ Sheet Metal ☐ Asphalt Shingles ☐ Vinyl ☐
Asphalt Sheeting ☐ Composite Board ☐ Other ☐
4. ROOF SHEATHING: Wood Shingle ☐ Asphalt Shingle ☒ Standing Seam Tim ☐ Slate ☐
Pressed Metal ☐ Sheet Metal ☐ Rolled Asphalt ☐ Other ☐
5. ENGINEERING STRUCTURE:
6. OTHER:
of Stories 1 1/2 # of Bays 5X2 Approx. Dimensions 36' X 28'
Roof Style: Gable ☒ Hip ☐ Gambrel ☐ Flat ☐ Shed ☐ Mansard ☐ Jerkinhead ☐
Monitor ☐ Sawtooth ☐ Other ☐
Appendages: Porches ☐ Towers ☐ Dormers ☐ Bay Windows ☐ Ells ☐ Chimneys 1
Wings ☐ Cupolas ☐ Sheds ☐ Garage 1 Other ☐
Entry Location: Center ☒ Sidehall ☐ Other ☐

MAP (Indicate North in circle):

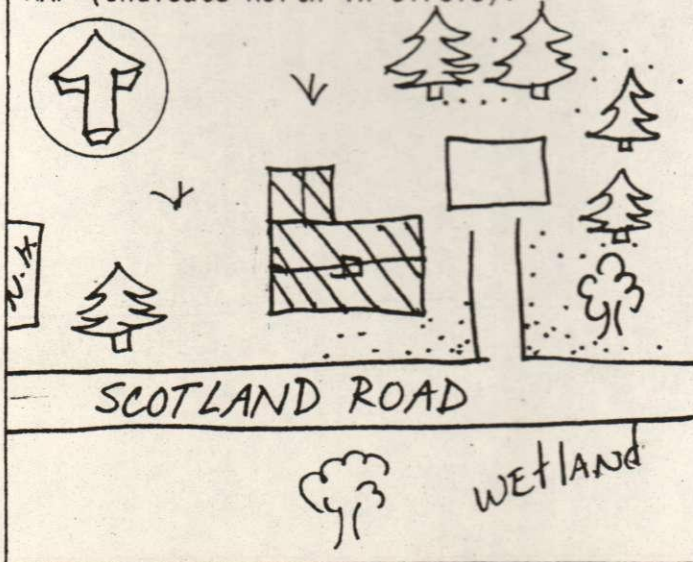

PHOTO

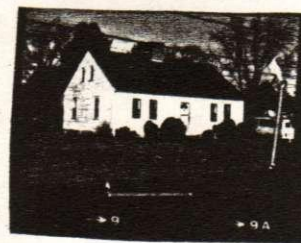

Description of View:

Front (S) Side (W)

Photographer: Herb Bubert

Negative with: S.R.R.C.

Negative File Number: K-80-5-C/9-9A

ADDITIONAL ARCHITECTURAL AND STRUCTURAL DESCRIPTION:

The Quigley house is a 1½ story Cape built in the Federal style. The center entry has a recent 4 panelled door with four lights arranged in a semi-circle. Flanking the door are pilasters which rise to meet a panelled, recessed transom. All of the windows have two over one sash and are framed with architrave trim. There are two smaller windows in each gable. A 2 bay, gable roofed dormer is located on the north elevation. The medium-pitched roof is topped by a large, central, corbel-capped chimney and the eaves treatment consists of close raking eaves and a molded boxed cornice on the lateral eaves. The structure is supported by a stone foundation above which is a wooden water table. On the north elevation is a 1 story, shed roofed open porch.

RELATED STRUCTURES AND CONTEXT:

A 1 story, gable roofed garage is located to the northeast of the house.

BOUNDARY AND ACREAGE DESCRIPTION: 1.6 Acres. Bounded to the N. by Bake, S. by Scotland Road, E. by Greenwood, W. by Moriarty, Clark

REFERENCES:

1856 Map

1892 Map

STATEMENT OF SIGNIFICANCE (Evaluation & Historical Associations):

The W. Abrahams House is a fine example of a cape built in the Federal style. It relates to Sites 112 and 113 which are strikingly similar. These three structures may have been built by the same builder.

MAP DATA: 1856: W. Abrahams
1892: D. Collins

SURROUNDING ENVIRONMENT: Open Land__ Woodland__ Scattered Bldgs__ Moderately Built Up__
Densely Built Up__ Residential^X Commercial__ Industrial__ Agricultural__
Roadside Strip Development__ Other__

Recorded By: H. Bubert, S. Novak

Date: 3/20/80

