

HISTORIC PRESERVATION ASSISTANCE PROJECT

Strafford Rockingham Regional Council

1 Water Street, Exeter, New Hampshire

Phone: (603) 778-0885

TOWN: Kingston	COUNTY: Rockingham	UTM: Z 19 /E 332625 /N 4755150
SURVEY NUMBER: 116		USGS QUAD: Haverhill Quad 15' series
COMMON NAME: The Goulet House		FUNCTIONAL TYPE: Farmhouse
HISTORIC NAME: R. Davis House		PRESENT USE: Residential
LOCATION: N. side Bartlett St, .18 Mi. W. of intersection of Depot Road		ARCHITECT/BUILDER: Unknown
OWNER: Dennis Goulet		CONDITION: Exc. <u>Good</u> X Fair <u>Poor</u> Ruins
ADDRESS: 16 Bartlett St., Kingston, NH		INTEGRITY: Original Site <u>X</u> Moved <u> </u> (When: <u> </u>)
MAP & PARCEL #: U9-17		Major alterations & date: Unknown
DATE: C. 1870		
SOURCE: Inspection		
STYLE: Vernacular/ Queen Anne		LEVEL/SIGNIFICANCE: Natl State Local <u>X</u>

GENERAL DESCRIPTION: Structural System

- FOUNDATION: Stone Brick X Concrete Concrete Block
- WALL STRUCTURE: Wood Frame Post & Beam Ballon Frame X Other
Load Bearing Masonry Stone Brick Concrete Block Other
Metal Iron Steel Other
Other and
- WALL COVERING: Clapboard X Wood Shingle X Board & Batten Shiplap Aluminum
Novelty Stucco Stone Brick Sheet Metal Asphalt Shingles Vinyl
Asphalt Sheeting Composite Board Other
- ROOF SHEATHING: Wood Shingle Asphalt Shingle X Standing Seam Tim Slate
Pressed Metal Sheet Metal Rolled Asphalt Other
- ENGINEERING STRUCTURE:
- OTHER:
of Stories 1 1/2 # of Bays 3X1 Approx. Dimensions 28' X 15'
Roof Style: Gable X Hip Gambrel Flat Shed Mansard Jerkinhead
Monitor Sawtooth Other
Appendages: Porches 3 Towers Dormers 2 Bay Windows Ells 3 Chimneys 1 on M.B.
Wings Cupolas Sheds Garage Other Barn 2 on ells
Entry Location: Center X Sidehall Other

MAP (Indicate North in circle):

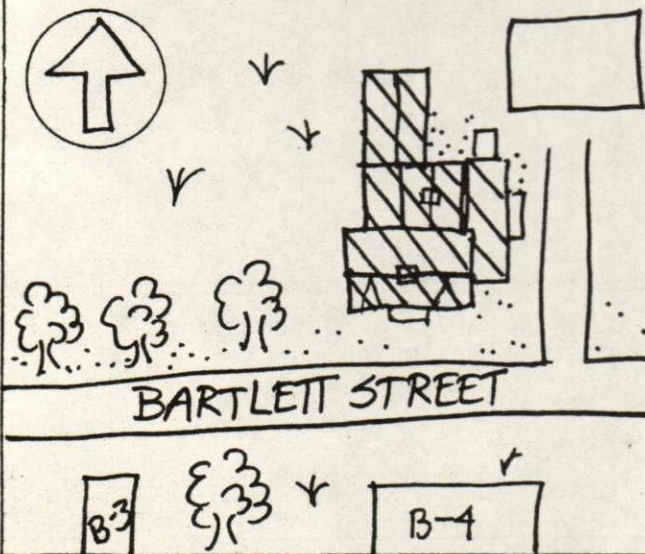

PHOTO

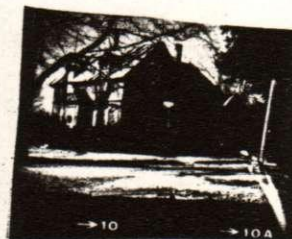

Description of View:
Front (S) Side (E)

Photographer: Herb Bubert
Negative with: S.R.R.C.
Negative File Number: K-80-5-C/10-10A

ADDITIONAL ARCHITECTURAL AND STRUCTURAL DESCRIPTION:

The Goulet house is a $1\frac{1}{2}$ story, vernacular Queen Anne style structure characterized by numerous projections and the use of decorative shingles. The center entry has a multi-panelled victorian door with several lights which is sheltered by a 1 story, jerkinhead-roofed, enclosed porch with decorative wood shingles. All of the windows have two over two sash and are framed by projecting caps and shutters. The medium-pitched roof is topped by a tall, narrow chimney and the eaves treatment consists of a boxed cornice with gable end returns. Two, 1 bay, gable roofed, pedimented, wall dormers have been set into the roof on the front facade. Decorative wood shingles have been applied to the upper third of the front facade. The structure rests on a brick foundation.

On the east elevation is a 1 story, shed roofed, open porch which leads to a 1 story gable roofed wing with a pedimented gable. The $1\frac{1}{2}$ story gable roofed ell has clapboard siding with the same decorative wood shingles applied to the upper third of the wall surface. It has two over two windows and rests on a brick foundation. A 1 story shed-roofed ell leads to a third, 1 story ell with a gable roof, two over two windows and a 4 panelled door. Both of these ells rest on brick foundations.

RELATED STRUCTURES AND CONTEXT: To the northeast of the house is a $1\frac{1}{2}$ story, jerkinhead-roofed barn with two over two windows, a vertical board door, and a brick foundation. Above its entrance is a gable roofed wall dormer with decorative wood shingles.

BOUNDARY AND ACREAGE DESCRIPTION: .7 Acres. Bounded to the N. by Bake, S. by Bartlett St., E. by Diamondon, W. by Brewster.

REFERENCES:

1892 Map

STATEMENT OF SIGNIFICANCE (Evaluation & Historical Associations):

The R. Davis house is one of very few examples of the Queen Anne style in Kingston. It is architecturally significant in Kingston's building stock and more broadly to the region as this was not a time of prosperity in the region.

MAP DATA: 1892: R. Davis

SURROUNDING ENVIRONMENT: Open Land__ Woodland__ Scattered Bldgs__ Moderately Built Up__
Densely Built Up__ Residential__☒ Commercial__ Industrial__ Agricultural__
Roadside Strip Development__ Other__

Recorded By: H. Bubert, S. Novak

Date: 3/20/80

