

# HISTORIC PRESERVATION ASSISTANCE PROJECT

Strafford Rockingham Regional Council

1 Water Street, Exeter, New Hampshire

Phone: (603) 778-0885

TOWN: Kingston	COUNTY: Rockingham
SURVEY NUMBER: 122	
COMMON NAME: Clarke House	
HISTORIC NAME: G. F. Carter House	
LOCATION: E side of Church St., .02 miles S of the intersection of Cottage Street.	
OWNER: Harry Clarke	
ADDRESS: 17 Church Street	
Kingston, NH.	
MAP & PARCEL #: R-34/16	
DATE: c. 1870	
SOURCE: Assessor's Office, Kingston	
STYLE: Late 19th Century Vernacular	

UTM: Z 19 /E 332225 /N 4755850
USGS QUAD: Haverhill Quad 15' Series
FUNCTIONAL TYPE: Residential
PRESENT USE: Residential
ARCHITECT/BUILDER: Unknown
CONDITION: Exc. <input checked="" type="checkbox"/> Good <input type="checkbox"/> Fair <input type="checkbox"/> Poor <input type="checkbox"/> Ruins <input type="checkbox"/>
INTEGRITY: Original Site <input checked="" type="checkbox"/> Moved <input type="checkbox"/> (When: )
Major alterations & date:
LEVEL/SIGNIFICANCE: Natl <input type="checkbox"/> State <input type="checkbox"/> Local <input checked="" type="checkbox"/>

## GENERAL DESCRIPTION: Structural System

1. FOUNDATION: Stone ☐ Brick ☒ Concrete ☐ Concrete Block ☐
2. WALL STRUCTURE: Wood Frame ☐ Post & Beam ☐ Ballon Frame ☒ Other ☐  
Load Bearing Masonry ☐ Stone ☐ Brick ☐ Concrete Block ☐ Other ☐  
Metal ☐ Iron ☐ Steel ☐ Other ☐
3. WALL COVERING: Clapboard ☒ Wood Shingle ☐ Board & Batten ☐ Shiplap ☐ Aluminum ☐  
Novelty ☐ Stucco ☐ Stone ☐ Brick ☐ Sheet Metal ☐ Asphalt Shingles ☐ Vinyl ☐  
Asphalt Sheeting ☐ Composite Board ☐ Other ☐
4. ROOF SHEATHING: Wood Shingle ☐ Asphalt Shingle ☒ Standing Seam Tin ☐ Slate ☐  
Pressed Metal ☐ Sheet Metal ☐ Rolled Asphalt ☐ Other ☐
5. ENGINEERING STRUCTURE:
6. OTHER:  
# of Stories 1 1/2 # of Bays 3x2 Approx. Dimensions 20' x 24'  
Roof Style: Gable ☒ Hip ☐ Gambrel ☐ Flat ☐ Shed ☐ Mansard ☐ Jerkinhead ☐  
Monitor ☐ Sawtooth ☐ Other ☐  
Appendages: Porches 1 Towers ☐ Dormers ☐ Bay Windows ☐ Ells 2 Chimneys 1  
Wings 1 Cupolas ☐ Sheds ☐ Garage ☐ Other ☐  
Entry Location: Center ☐ Sidehall ☒ Other ☐

## MAP (Indicate North in circle):

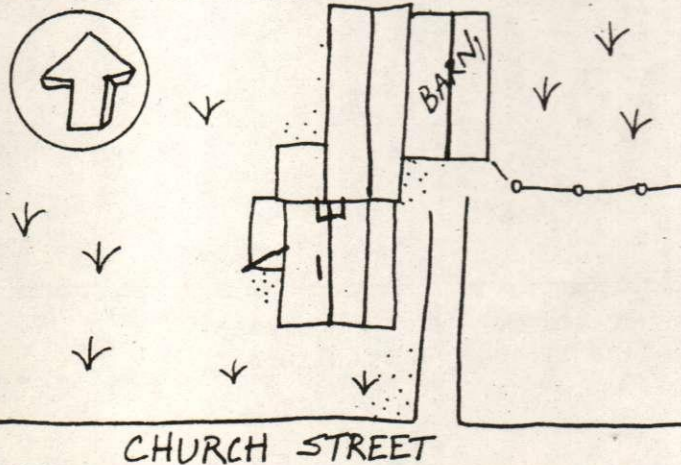

## PHOTO



Description of View: Front-south  
Side-east

Photographer: Herb Bubert  
Negative with: S.R.R.C.  
Negative File Number: K-80-10c/34A-35



#### ADDITIONAL ARCHITECTURAL AND STRUCTURAL DESCRIPTION:

The Clarke House is a 1½-story late nineteenth century vernacular structure featuring gable front orientation to the street. The 4-panelled sidehall entry door contains one large light, and is surmounted by a flat-roofed doorhood supported by brackets. Windows have two-over-two sash and shutters. An exterior chimney has a corbelled cap. Treatment at the eaves consists of a boxed cornice with gable end returns.

A 1-story screened, jerkinhead-roofed porch on the south elevation rests on a cement foundation.

A 1-story flat-roofed wing on the north elevation has clapboard siding, and windows with two-over-two sash.

A 1-story flat-roofed ell has clapboard siding and rests on a concrete block foundation.

A 1-story gable-roofed ell rests on a brick foundation. It has clapboard siding, and windows with two-over-two sash and shutters. The medium-pitched roof is topped by a tall, corbel-capped chimney, and the eaves treatment consists of a boxed cornice with gable end returns.

**RELATED STRUCTURES AND CONTEXT:** A 1½-story gable-roofed barn rests on a fieldstone and cement block foundation. It has clapboard siding, windows with two-over-two sash and shutters, and a vertical-board hayloft door.

**BOUNDARY AND ACREAGE DESCRIPTION:** .8 acres bounded to the N-Sweeney, Carr, S-Clarke, E-Carr, W-Church Street.

#### REFERENCES:

Kingston Historic Advisory Committee; interviews w/members, Spring 1980

1892 Map

#### STATEMENT OF SIGNIFICANCE (Evaluation & Historical Associations):

The G. F. Carter House is an intact example of late 19th century building perpetuating story and ½ sidehall house plan.

Historic Associations: Building to south on 1892 map was Carter's carriage shop. Both sites stayed in the Carter family until well into the 20th century; after the carriage business folded, Carter had a garage here.

MAP DATA: 1892: G. F. Carter

**SURROUNDING ENVIRONMENT:** Open Land ☒ Woodland ☐ Scattered Bldgs ☐ Moderately Built Up ☐  
Densely Built Up ☐ Residential ☒ Commercial ☐ Industrial ☐ Agricultural ☐  
Roadside Strip Development ☐ Other ☐

Recorded By: Scott Novak  
Herb Bubert

Date: 3/24/80



