

## HISTORIC PRESERVATION ASSISTANCE PROJECT

Strafford Rockingham Regional Council

1 Water Street, Exeter, New Hampshire

Phone: (603) 778-0885

TOWN: Kingston	COUNTY: Rockingham	UTM: Z 19 /E 332100 /N 4755975
SURVEY NUMBER: 124		USGS QUAD: Haverhill Quad 15' Series
COMMON NAME: Cross House		FUNCTIONAL TYPE: Residential
HISTORIC NAME: H. D. Webster House		PRESENT USE: Residential
LOCATION: W side of Church St., across the street from the inter. of Cottage St.		ARCHITECT/BUILDER: Unknown
OWNER: Mary Cross		CONDITION: Exc. <input checked="" type="checkbox"/> Good <input type="checkbox"/> Fair <input type="checkbox"/> Poor <input type="checkbox"/> Ruins <input type="checkbox"/>
ADDRESS: 24 Church Street Kingston, NH.		INTEGRITY: Original Site <input checked="" type="checkbox"/> Moved <input type="checkbox"/> (When: <input type="text"/> )
MAP & PARCEL #: R-30/5		Major alterations & date: <input type="text"/>
DATE: c. 1860		
SOURCE: Inspection		
STYLE: Greek Revival		LEVEL/SIGNIFICANCE: Natl <input type="checkbox"/> State <input type="checkbox"/> Local <input checked="" type="checkbox"/>

GENERAL DESCRIPTION: Structural System

- FOUNDATION: Stone ☐ Brick ☒ Concrete ☐ Concrete Block ☐
- WALL STRUCTURE: Wood Frame ☐ Post & Beam ☐ Ballon Frame ☒ Other ☐  
Load Bearing Masonry ☐ Stone ☐ Brick ☐ Concrete Block ☐ Other ☐  
Metal ☐ Iron ☐ Steel ☐ Other ☐
- WALL COVERING: Clapboard ☒ Wood Shingle ☐ Board & Batten ☐ Shiplap ☐ Aluminum ☐  
Novelty ☐ Stucco ☐ Stone ☐ Brick ☐ Sheet Metal ☐ Asphalt Shingles ☐ Vinyl ☐  
Asphalt Sheeting ☐ Composite Board ☐ Other ☐
- ROOF SHEATHING: Wood Shingle ☐ Asphalt Shingle ☒ Standing Seam Tim ☐ Slate ☐  
Pressed Metal ☐ Sheet Metal ☐ Rolled Asphalt ☐ Other ☐
- ENGINEERING STRUCTURE:
- OTHER:  
# of Stories 1 1/2 # of Bays 3x2 Approx. Dimensions 20' x 30'  
Roof Style: Gable ☒ Hip ☐ Gambrel ☐ Flat ☐ Shed ☐ Mansard ☐ Jerkinhead ☐  
Monitor ☐ Sawtooth ☐ Other ☐  
Appendages: Porches 1 Towers ☐ Dormers ☐ Bay Windows ☐ Ells 1 Chimneys 1  
Wings 2 Cupolas ☐ Sheds ☐ Garage ☐ Other ☐  
Entry Location: Center ☐ Sidehall ☒ Other ☐

MAP (Indicate North in circle):

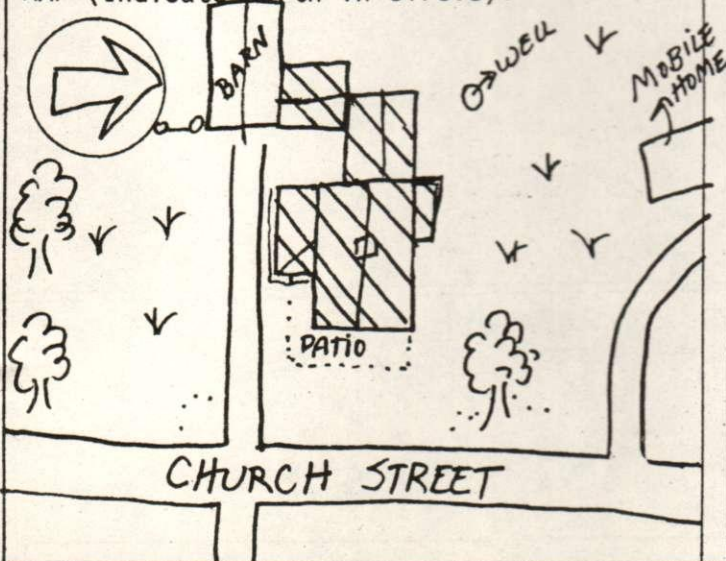

PHOTO

Description of View: Front-east  
Side-southPhotographer: Herb Bubert  
Negative with: S.R.R.C.  
Negative File Number: K-80-10c/36A-37



#### ADDITIONAL ARCHITECTURAL AND STRUCTURAL DESCRIPTION:

The Cross House is a 1½-story Greek Revival style structure featuring gable front orientation to the street. The 2-panalled sidehall entry door contains two vertical lights with segmentally arched heads, and is surmounted by a partial entablature. Windows have two-over-two sash, and are flanked by shutters and surmounted by slightly projecting caps. The medium-pitched roof is surmounted by one chimney, and the treatment at the eaves consists of a boxed cornice with gable end returns.

An enclosed 1-story shed-roofed porch on the south elevation has windows with two-over-two sash and recessed ponds below.

A 1-story, flat-roofed wing on the north elevation has the same siding, windows, foundation, and eaves treatment as the main block.

A 1-story, gable-roofed ell rests on a brick foundation. It has clapboard siding, assorted new windows, and a boxed cornice.

A 1-story, gable-roofed wing is attached to the ell. It has clapboard siding, a boxed cornice, and two-over-two windows. It rests on a brick foundation.

**RELATED STRUCTURES AND CONTEXT:** An attached 2-story, gable-roofed barn rests on a brick foundation. It has clapboard siding, projecting eaves, two-over-two windows, a vertical-board hayloft door, and a new garage door.

**BOUNDARY AND ACREAGE DESCRIPTION:** .6 acres bounded to the N-Magnusson, S-Maule, Town of Kingston, E-Church Street, W-Christie.

#### REFERENCES:

1892 Map

#### STATEMENT OF SIGNIFICANCE (Evaluation & Historical Associations):

The H. D. Webster House is a fine example of a 1½ story kneewall sidehall typical in rural New Hampshire homes.

MAP DATA: 1892: H.D. Webster

**SURROUNDING ENVIRO. MENT:** Open Land ☒ Woodland ☐ Scattered Bldgs ☐ Moderately Built Up ☐  
Densely Built Up ☐ Residential ☒ Commercial ☐ Industrial ☐ Agricultural ☐  
Roadside Strip Development ☐ Other ☐

Recorded By: Scott Novak  
Herb Bubert

Date: 3/24/80



