

## HISTORIC PRESERVATION ASSISTANCE PROJECT

Strafford Rockingham Regional Council

1 Water Street, Exeter, New Hampshire

Phone: (603) 778-0885

TOWN: Kingston	COUNTY: Rockingham	UTM: Z 19 /E 331650 /N 4756425
SURVEY NUMBER: 131		USGS QUAD: Haverhill Quad 15' Series
COMMON NAME: Radigan House		FUNCTIONAL TYPE: Farmhouse
HISTORIC NAME: R. B. Bartlett House		PRESENT USE: Residential
LOCATION: N side of North Danville Rd., .34 miles W of the inter. of Church Street.		ARCHITECT/BUILDER: Unknown
OWNER: Frank Radigan		CONDITION: Exc. <u>Good</u> <u>X</u> Fair <u>Poor</u> <u>Ruins</u>
ADDRESS: 21 N. Danville Road Kingston, NH.		INTEGRITY: Original Site <u>X</u> Moved <u>    </u> (When: <u>    </u> )
MAP & PARCEL #: R-33/38		Major alterations & date: Doors, windows, and chimney changed, dates unknown
DATE: c.1849		LEVEL/SIGNIFICANCE: Natl <u>State</u> <u>Local</u> <u>X</u>
SOURCE: Inspection		
STYLE: Greek Revival/Three Quarter House		

GENERAL DESCRIPTION: Structural System

- FOUNDATION: Stone X Brick      Concrete      Concrete Block
- WALL STRUCTURE: Wood Frame      Post & Beam X Ballon Frame      Other       
Load Bearing Masonry      Stone      Brick      Concrete Block      Other       
Metal      Iron      Steel      Other
- WALL COVERING: Clapboard X Wood Shingle      Board & Batten      Shiplap      Aluminum       
Novelty      Stucco      Stone      Brick      Sheet Metal      Asphalt Shingles      Vinyl       
Asphalt Sheeting      Composite Board      Other
- ROOF SHEATHING: Wood Shingle      Asphalt Shingle X Standing Seam Tim      Slate       
Pressed Metal      Sheet Metal      Rolled Asphalt      Other
- ENGINEERING STRUCTURE:
- OTHER:  
# of Stories 1½ # of Bays 4x1 Approx. Dimensions 24' x 17'  
Roof Style: Gable X Hip      Gambrel      Flat      Shed      Mansard      Jerkinhead       
Monitor      Sawtooth      Other       
Appendages: Porches      Towers      Dormers      Bay Windows      Ells 1 Chimneys 1 on MB.  
Wings 1 Cupolas      Sheds 2 Garage      Other      Barn      1 on ell  
Entry Location: Center      Sidehall X Other

MAP (Indicate North in circle):

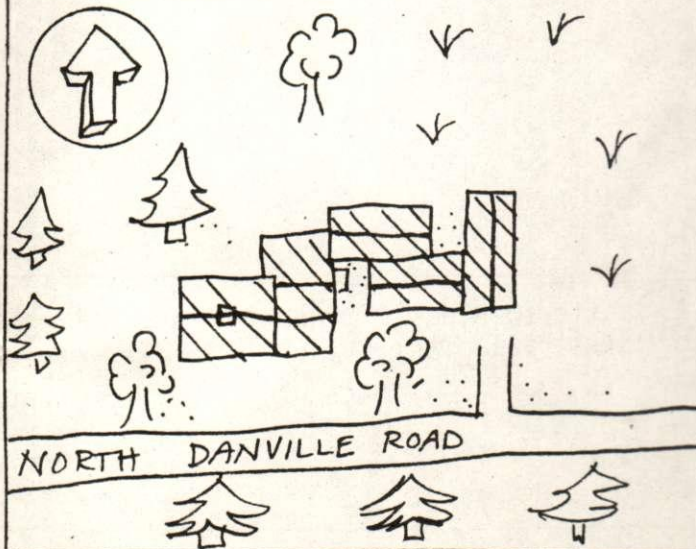

PHOTO

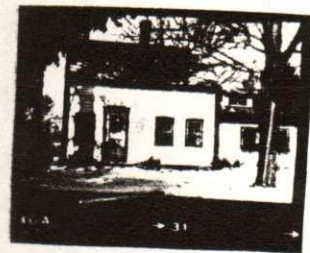

Description of View: Front-south

Photographer: Herb Bubert  
 Negative with: S.R.R.C.  
 Negative File Number: K-80-10c/30A-31



**ADDITIONAL ARCHITECTURAL AND STRUCTURAL DESCRIPTION:**

The Radigan house is a 1½-story, Greek Revival, Three-Quarter house with Victorian era remodeling. The offset entry has a 5-panelled (Victorian) door with one large light surmounted by a pediment motif. All of the windows have two-over-one sash with pedimented lintels. The medium-pitched roof is topped by a narrow, corbel-capped chimney. The house rests on a granite slab foundation.

A 1½-story, gable-roofed ell projects to the northeast. On its east elevation is a 1-story, shed-roofed wing. To the rear of the ell and wing is a 1-story shed.

**RELATED STRUCTURES AND CONTEXT:** To the east of the house is an attached 1-story, gable-roofed shed which leads to a 1½-story, gable-roofed barn.

**BOUNDARY AND ACREAGE DESCRIPTION:** .3 acres bounded to the N-Sloan, S-North Danville Road, E-Spear, W-Hatch, Sloan.

**REFERENCES:**

1856 Map

1892 Map

**STATEMENT OF SIGNIFICANCE (Evaluation & Historical Associations):**

The Bartlett House is a small vernacular structure with surprisingly well developed window caps. Another fine feature is its current paint scheme which accentuates its details.

MAP DATA: 1856: Mrs. Bartlett  
1892: R. B. Bartlett

**SURROUNDING ENVIRONMENT:** Open Land ☒ Woodland ☒ Scattered Bldgs ☒ Moderately Built Up ☐  
Densely Built Up ☐ Residential ☐ Commercial ☐ Industrial ☐ Agricultural ☐  
Roadside Strip Development ☐ Other ☐

Recorded By: Scott Novak  
Herb Bubert

Date: 3/28/86



