

## HISTORIC PRESERVATION ASSISTANCE PROJECT

Strafford Rockingham Regional Council

1 Water Street, Exeter, New Hampshire

Phone: (603) 778-0885

TOWN: Kingston	COUNTY: Rockingham	UTM: Z 19 /E 331950 /N 4756350
SURVEY NUMBER: 133		USGS QUAD: Haverhill Quad 15' series
COMMON NAME: The Martin House		FUNCTIONAL TYPE: Farmhouse
HISTORIC NAME: J. S. Judkins House		PRESENT USE: Residence
LOCATION: N. side North Danville Rd., .10 Mi. W. intersection of Church St.		ARCHITECT/BUILDER: Unknown
OWNER: Ruth A. Martin		CONDITION: Exc. <u>Good</u> <u>X</u> Fair <u>Poor</u> <u>Ruins</u>
ADDRESS: 5 N. Danville Rd., Kingston, NH		INTEGRITY: Original Site <u>X</u> Moved <u>    </u> (When: <u>    </u> )
MAP & PARCEL #: R33-43		Major alterations & date: <u>ells added,</u>
DATE: C. 1850		<u>dates unknown</u>
SOURCE: Inspection		LEVEL/SIGNIFICANCE: Natl <u>State</u> Local <u>X</u>
STYLE: Greek Revival		

GENERAL DESCRIPTION: Structural System

- FOUNDATION: Stone X Brick      Concrete      Concrete Block
- WALL STRUCTURE: Wood Frame      Post & Beam X Ballon Frame      Other       
Load Bearing Masonry      Stone      Brick      Concrete Block      Other       
Metal      Iron      Steel      Other
- WALL COVERING: Clapboard X Wood Shingle      Board & Batten      Shiplap      Aluminum       
Novelty      Stucco      Stone      Brick      Sheet Metal      Asphalt Shingles      Vinyl       
Asphalt Sheeting      Composite Board      Other
- ROOF SHEATHING: Wood Shingle      Asphalt Shingle X Standing Seam Tim      Slate       
Pressed Metal      Sheet Metal      Rolled Asphalt      Other
- ENGINEERING STRUCTURE:
- OTHER:  
# of Stories 1½ # of Bays 3X4 Approx. Dimensions 26' X 26'  
Roof Style: Gable X Hip      Gambrel      Flat      Shed      Mansard      Jerkinhead       
Monitor      Sawtooth      Other       
Appendages: Porches 2 Towers      Dormers      Bay Windows      Ells 2 Chimneys 2  
Wings      Cupolas      Sheds 1 Garage 1 Other       
Entry Location: Center      Sidehall XX Other

MAP (Indicate North in circle):

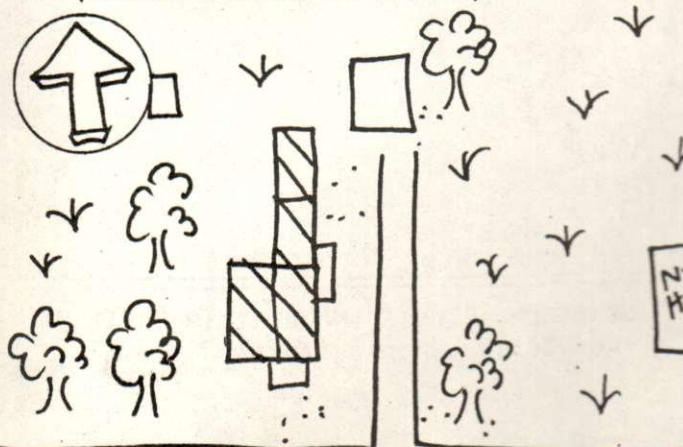

NORTH DANVILLE ROAD

PHOTO



Description of View:

Front (S) Side (W)

Photographer: Herb Bubert

Negative with: S.R.R.C.

Negative File Number: K80-10C-33A-34



#### ADDITIONAL ARCHITECTURAL AND STRUCTURAL DESCRIPTION:

The Martin house is a 1½ story, gable-roofed, Greek Revival style house which has further evolved with some victorian era additions, including a 1 story, hip-roofed open porch supported by turned posts with decoratively arranged ballusters. The sidehall entry, sheltered by the above mentioned porch, has a multi-panelled (Victorian) door with one large light flanked by 3/4 length sidelights. All of the windows have six over six sash surmounted by pedimented lintels. The medium pitch roof is topped by two narrow chimneys and the eaves treatment consists of a boxed cornice with a wide frieze and gable end returns. The main block is framed by wide, panelled pilasters. The house rests on a stone foundation.

On the east elevation of the house is a 1 story, gable roofed enclosed porch. The 1 story gable roofed ell has clapboard siding, six over one and six over six windows, and rest on a cement foundation. A second 1 story, gable roofed ell has clapboard siding, six over six windows, and a vertical board door. It has an exterior, concrete block chimney and rests on a cement foundation.

**RELATED STRUCTURES AND CONTEXT:** To the northwest of the house is a separate 1 story shed. A 1½ story, gable roofed garage is located to the northeast of the house.

**BOUNDARY AND ACREAGE DESCRIPTION:** 8.4 Acres. Bounded to the N. by Call, Martin and Dolliver, S. by North Danville Road, E. by Harvey, Martin and Call, W. by Ready.

#### REFERENCES:

1856 Map

1892 Map

#### STATEMENT OF SIGNIFICANCE (Evaluation & Historical Associations):

The J. Judkins House is a beautifully proportioned house with very fine Victorian details. In addition, it contributes a great deal to Kingston's building stock.

MAP DATA: 1856: J. S. Judkins  
1892: J. P. Davis

**SURROUNDING ENVIRONMENT:** Open Land ☒ Woodland ☐ Scattered Bldgs ☒ Moderately Built Up ☐  
Densely Built Up ☐ Residential ☐ Commercial ☐ Industrial ☐ Agricultural ☐  
Roadside Strip Development ☐ Other ☐

Recorded By:

Date: 3/28/80



