

HISTORIC PRESERVATION ASSISTANCE PROJECT

Strafford Rockingham Regional Council

1 Water Street, Exeter, New Hampshire

Phone: (603) 778-0885

TOWN: Kingston	COUNTY: Rockingham	UTM: Z 19 /E 331500 /N 4757100
SURVEY NUMBER: 144		USGS QUAD: Haverhill Quad 15' Series
COMMON NAME: Parkins House		FUNCTIONAL TYPE: Dwelling
HISTORIC NAME: Marshall Carriage Shop		PRESENT USE: Residential
LOCATION: South side of Marshall Road, .4 miles E of the intersection of Thorn Road.		ARCHITECT/BUILDER: Unknown
OWNER: Cecil Parkins		CONDITION: Exc. <input checked="" type="checkbox"/> Good <input type="checkbox"/> Fair <input type="checkbox"/> Poor <input type="checkbox"/> Ruins <input type="checkbox"/>
ADDRESS: 20 Marshall Rd., Kingston, NH		INTEGRITY: Original Site <input type="checkbox"/> Moved <input checked="" type="checkbox"/> (When: <input type="checkbox"/>)
MAP & PARCEL #: R-33/26		Major alterations & date: <input type="text"/>
DATE: c. 1880		
SOURCE: Inspection		
STYLE: Late 19th Century Vernacular		LEVEL/SIGNIFICANCE: Natl <input type="checkbox"/> State <input type="checkbox"/> Local <input checked="" type="checkbox"/>

GENERAL DESCRIPTION: Structural System

1. FOUNDATION: Stone ☐ Brick ☐ Concrete ☐ Concrete Block ☒
2. WALL STRUCTURE: Wood Frame ☐ Post & Beam ☐ Ballon Frame ☒ Other ☐
Load Bearing Masonry ☐ Stone ☐ Brick ☐ Concrete Block ☐ Other ☐
Metal ☐ Iron ☐ Steel ☐ Other ☐
3. WALL COVERING: Clapboard ☒ Wood Shingle ☒ Board & Batten ☐ Shiplap ☐ Aluminum ☐
Novelty ☐ Stucco ☐ Stone ☐ Brick ☐ Sheet Metal ☐ Asphalt Shingles ☐ Vinyl ☐
Asphalt Sheeting ☐ Composite Board ☐ Other ☐
4. ROOF SHEATHING: Wood Shingle ☐ Asphalt Shingle ☒ Standing Seam Tin ☐ Slate ☐
Pressed Metal ☐ Sheet Metal ☐ Rolled Asphalt ☐ Other ☐
5. ENGINEERING STRUCTURE:
6. OTHER:
of Stories 1 1/2 # of Bays 3x4 Approx. Dimensions 25' x 35'
Roof Style: Gable ☒ Hip ☐ Gambrel ☐ Flat ☐ Shed ☐ Mansard ☐ Jerkinhead ☐
Monitor ☐ Sawtooth ☐ Other ☐
Appendages: Porches 1 Towers ☐ Dormers ☐ Bay Windows ☐ Ells ☐ Chimneys 1
Wings ☐ Cupolas ☐ Sheds ☐ Garage ☐ Other ☐
Entry Location: Center ☐ Sidehall ☒ Other ☐

MAP (Indicate North in circle):

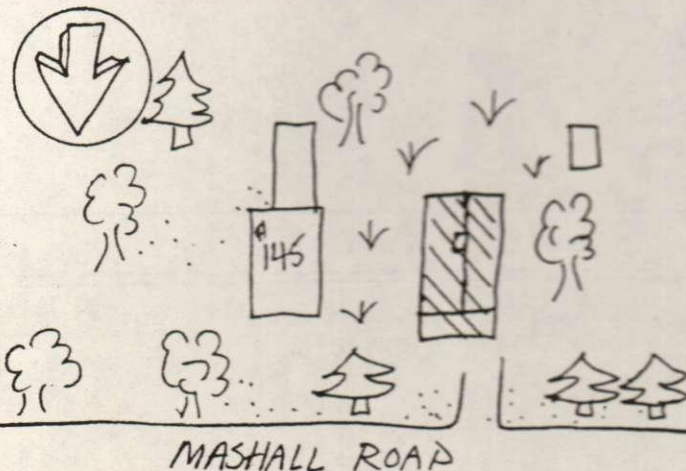

PHOTO



Description of View: Front-north

Photographer: Scott Novak

Negative with: S.R.R.C.

Negative File Number: K-80-11c/20-20A

ADDITIONAL ARCHITECTURAL AND STRUCTURAL DESCRIPTION:

The Parkins House is a 1½-story late nineteenth century vernacular structure. The multi-light center entry door is sheltered by a 1-story, flat-roofed, screened porch. Windows have six-over-six sash, and some are flanked by shutters. The medium-pitched roof is topped by a tall, narrow, corbel-capped chimney, and the cornice treatment consists of close, molded, lateral and raking eaves.

RELATED STRUCTURES AND CONTEXT: A separate 1-story, shed-roofed to the west of the house has novelty siding.

BOUNDARY AND ACREAGE DESCRIPTION: .6 acres bounded to the N-Marshall Road, S-Gifford, E-Gifford, Borthwick, W-Gifford.

REFERENCES:

Kingston Historic Advisory Committee; interviews w/members, Spring 1980
1892 Map

STATEMENT OF SIGNIFICANCE (Evaluation & Historical Associations):

This small vernacular structure is historically linked with Site #143, the J. F. Marshall House. It was apparently a carriage shop associated with the Marshall carriage industry.

Historic Associations: Formerly a carriage shop belonging to Marshall Estate (Site 143)

MAP DATA: 1892: Carriage shop

MAP DATA 1892-Carriage Shop

SURROUNDING ENVIRONMENT: Open Land ☐ Woodland ☐ Scattered Bldgs ☐ Moderately Built Up ☐
Densely Built Up ☐ Residential ☐ Commercial ☐ Industrial ☐ Agricultural ☐
Roadside Strip Development ☐ Other ☐

Recorded By: Scott Novak
Herb Buberl

Date: 4/1/80

