

HISTORIC PRESERVATION ASSISTANCE PROJECT

Strafford Rockingham Regional Council

1 Water Street, Exeter, New Hampshire

Phone: (603) 778-0885

TOWN: Kingston	COUNTY: Rockingham	UTM: Z 19 /E 331750 /N 4757150
SURVEY NUMBER: 148		USGS QUAD: Haverhill Quad 15' series
COMMON NAME: The Blackburn House		FUNCTIONAL TYPE: Farmhouse
HISTORIC NAME: J. W. Sanborn House		PRESENT USE: Residence
LOCATION: N. side Marshall Rd., .60 Mi. E. of intersection of Thorne Road		ARCHITECT/BUILDER: Unknown
OWNER: Robert Blackburn		CONDITION: Exc. <input checked="" type="checkbox"/> Good <input type="checkbox"/> Fair <input type="checkbox"/> Poor <input type="checkbox"/> Ruins <input type="checkbox"/>
ADDRESS: 15 Marshall Rd., Kingston, NH		INTEGRITY: Original Site <input checked="" type="checkbox"/> Moved <input type="checkbox"/> (When: <input type="text"/>)
MAP & PARCEL #: R41-13		Major alterations & date: Unknown
DATE: C. 1840		
SOURCE: Inspection		
STYLE: Greek Revival		LEVEL/SIGNIFICANCE: Natl <input type="checkbox"/> State <input type="checkbox"/> Local <input checked="" type="checkbox"/>

GENERAL DESCRIPTION: Structural System

- FOUNDATION: Stonex ☒ Brick ☐ Concrete ☐ Concrete Block ☐
- WALL STRUCTURE: Wood Frame ☐ Post & Beam ☒ Ballon Frame ☐ Other ☐
Load Bearing Masonry ☐ Stone ☐ Brick ☐ Concrete Block ☐ Other ☐
Metal ☐ Iron ☐ Steel ☐ Other ☐
- WALL COVERING: Clapboard ☒ Wood Shingle ☐ Board & Batten ☐ Shiplap ☐ Aluminum ☐
Novelty ☐ Stucco ☐ Stone ☐ Brick ☐ Sheet Metal ☐ Asphalt Shingles ☐ Vinyl ☐
Asphalt Sheeting ☐ Composite Board ☐ Other ☐
- ROOF SHEATHING: Wood Shingle ☐ Asphalt Shingle ☒ Standing Seam Tim ☐ Slate ☐
Pressed Metal ☐ Sheet Metal ☐ Rolled Asphalt ☐ Other ☐
- ENGINEERING STRUCTURE:
- OTHER:
of Stories $1\frac{1}{2}$ # of Bays 3X4 Approx. Dimensions 22' X 30'
Roof Style: Gable ☒ Hip ☐ Gambrel ☐ Flat ☐ Shed ☐ Mansard ☐ Jerkinhead ☐
Monitor ☐ Sawtooth ☐ Other ☐
Appendages: Porches 2 Towers ☐ Dormers ☐ Bay Windows ☐ Ells 1 Chimneys 1 on MB
Wings ☐ Cupolas ☐ Sheds ☐ Garage ☐ Other ☐ Barn 1 on ell
Entry Location: Center ☐ Sidehall ☒ Other ☐

MAP (Indicate North in circle):

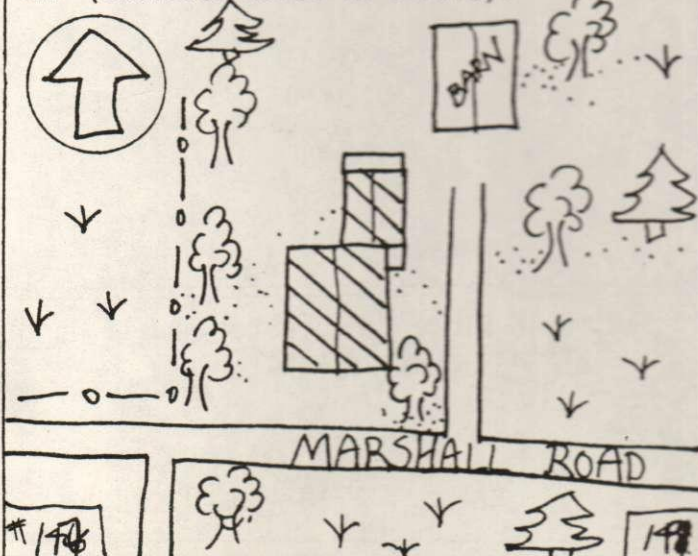

PHOTO



Description of View:
Front (S) Side (W)

Photographer: Herb Bubert
Negative with: S.R.R.C.
Negative File Number: K80-11C-26-26A

ADDITIONAL ARCHITECTURAL AND STRUCTURAL DESCRIPTION:

The Blackburn house is a $1\frac{1}{2}$ story, Greek Revival style house characterized by gable front orientation to the street, sidehall entry, and classical ornamentation. Within the recessed entry is a panelled reveal and a 6 panelled door flanked by full length side-lights. Framing the entrance are panelled pilasters which rise to a full entablature. All of the windows have six over six sash and most of them are capped with pedimented lintels. The main block is framed by panelled pilasters. The medium pitch roof is topped by a narrow, corbel capped chimney and the eaves treatment consists of a boxed cornice with a wide frieze and gable end returns. The house rests on a granite slab foundation. A 1 story, gable roofed ell projects to the north. It has an enclosed porch located on its north elevation.

A separate $2\frac{1}{2}$ story gable roofed barn is located to the northeast of the house.

RELATED STRUCTURES AND CONTEXT: A separate $2\frac{1}{2}$ story gabled roof barn has clapboard siding, six over six and fixed six pane windows, fieldstone foundation and vertical board doors.

BOUNDARY AND ACREAGE DESCRIPTION: .8 Acres. Bounded to the N. by Christie, S. by Route 107, E. by Bean, W. by Winslade.

REFERENCES:

1856 Map

1892 Map

STATEMENT OF SIGNIFICANCE (Evaluation & Historical Associations):

The J. W. Sanborn House is a fine example of a small Greek Revival kneewall house with a handsome recessed doorway. Historic association with prominent Sanborn family.

MAP DATA: 1856: J. W. Sanborn
1892: J. W. Sanborn

SURROUNDING ENVIRONMENT: Open Land ☒ Woodland ☐ Scattered Bldgs ☒ Moderately Built Up ☐
Densely Built Up ☐ Residential ☐ Commercial ☐ Industrial ☐ Agricultural ☐
Roadside Strip Development ☐ Other ☐

Recorded By: Herb Bubert, Scott Novak

Date: 4/3/80

