

HISTORIC PRESERVATION ASSISTANCE PROJECT

Strafford Rockingham Regional Council

1 Water Street, Exeter, New Hampshire

Phone: (603) 778-0885

TOWN: Kingston	COUNTY: Rockingham	UTM: Z 19 /E 334025 /N 4757350
SURVEY NUMBER: 152		USGS QUAD: Haverhill Quad 15' series
COMMON NAME: The Stevens House		FUNCTIONAL TYPE: Residential
HISTORIC NAME: Robinson House		PRESENT USE: Residence
LOCATION: N. side Little River Rd., .09 Mi. W. intersection of Shore Road		ARCHITECT/BUILDER: J. Warren Sanborn
OWNER: Arthur & Ann Stevens		CONDITION: Exc. <u>Good</u> <u>X</u> Fair <u>Poor</u> <u>Ruins</u>
ADDRESS: 61 Little River Rd., Kingston		INTEGRITY: Original Site <u>X</u> Moved <u> </u> (When: <u> </u>)
MAP & PARCEL #: R39-37		Major alterations & date: <u> </u>
DATE: C. 1860		LEVEL/SIGNIFICANCE: Natl <u> </u> State <u> </u> Local <u>X</u>
SOURCE: Inspection		
STYLE: Greek Revival		

GENERAL DESCRIPTION: Structural System

- FOUNDATION: Stone Brick X Concrete Concrete Block
- WALL STRUCTURE: Wood Frame Post & Beam Ballon Frame X Other
Load Bearing Masonry Stone Brick Concrete Block Other
Metal Iron Steel Other
- WALL COVERING: Clapboard X Wood Shingle Board & Batten Shiplap Aluminum
Novelty Stucco Stone Brick Sheet Metal Asphalt Shingles Vinyl
Asphalt Sheeting Composite Board Other
- ROOF SHEATHING: Wood Shingle Asphalt Shingle X Standing Seam Tim Slate
Pressed Metal Sheet Metal Rolled Asphalt Other
- ENGINEERING STRUCTURE:
- OTHER:
of Stories 2 1/2 # of Bays 3X4 Approx. Dimensions 21' X 32'
Roof Style: Gable X Hip Gambrel Flat Shed Mansard Jerkinhead
Monitor Sawtooth Other
Appendages: Porches 2 Towers Dormers Bay Windows Ells 1 Chimneys
Wings Cupolas Sheds Garage Other
Entry Location: Center Sidehall X Other

MAP (Indicate North in circle):

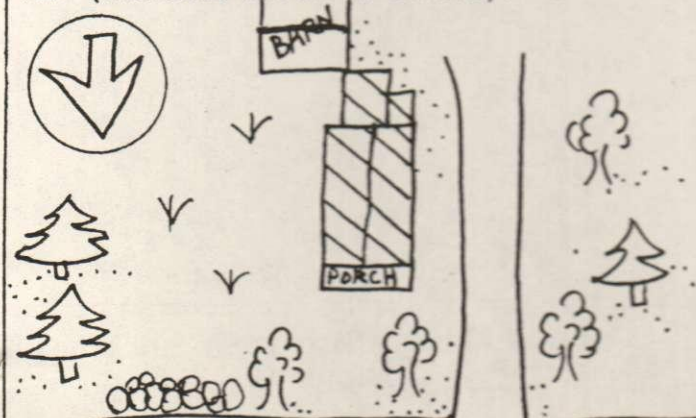

LITTLE RIVER ROAD

PHOTO



Description of View:

Front (N) Side (W)

Photographer: Herb Bubert

Negative with: S.R.R.C.

Negative File Number: K80-12-C/14A-15

ADDITIONAL ARCHITECTURAL AND STRUCTURAL DESCRIPTION:

The Stevens house is a 2½ story Greek Revival style structure featuring gable end orientation to the street. The 2 panelled sidehall entry door contains two lights, and is sheltered by a 1 story, enclosed shed roofed porch. The porch has projecting eaves with exposed rafters, and is supported by round, tapering columns. Windows have two over two sash, and are surmounted by projecting caps. The medium pitched roof is topped by a narrow chimney, and the eaves treatment consists of a boxed cornice with a wide frieze and gable end returns.

There is a 1 story, shed roofed enclosed porch on the west elevation.

A 1 story gable roofed ell has clapboard siding, one chimney, a fixed light window, and a stone foundation.

Supposedly unchanged and intact.

RELATED STRUCTURES AND CONTEXT: An attached 1½ story gable roofed barn has clapboard siding, a horizontally sliding vertical board door with a hayloft door above, and a boxed cornice with gable end returns.

BOUNDARY AND ACREAGE DESCRIPTION: .3 Acres. Bounded to the N. by Little River Road, S. by Gould, E. by Gould, W. by Gould.

REFERENCES:

Kingston Historic Advisory Committee; interviews w/members, Spring 1980

1892 Map

STATEMENT OF SIGNIFICANCE (Evaluation & Historical Associations):

Built by J. S. Sanborn, a member of the prominent Sanborn family, this house is a simple vernacular example of mid 19th century building. Sited prominently on a knoll, the house should be considered for inclusion in the Little River Historic District.

Historic Associations: Built by J. Warren Sanborn who owned adjacent sawmill.

MAP DATA: 1892: Mrs. Robinson

SURROUNDING ENVIRONMENT: Open Land ☐ Woodland ☒ Scattered Bldgs ☐ Moderately Built Up ☐
Densely Built Up ☐ Residential ☐ Commercial ☐ Industrial ☐ Agricultural ☐
Roadside Strip Development ☐ Other ☐

Recorded By: Herb Bubert, Scott Novak

Date: 4/3/80

