

CULTURAL RESOURCES SURVEY FORM

TOWN: Kingston COUNTY: Rockingham

SURVEY NUMBER: 154A

COMMON NAME: Dunbar House

HISTORIC NAME: A. C. Chase House

LOCATION: Off Little River Rd. at Rte 125

OWNER: Richard & Irene Dunbar
3 Rte 125 Access Road

ADDRESS: Kingston, NH

MAP & PARCEL#: R-34 43

DATE: c. 1895

SOURCE: Inspection

STYLE: Late 19th century Vernacular

UTM: Z /E /N

USGS QUAD:

FUNCTIONAL TYPE:

PRESENT USE: Residence

ARCHITECT/BUILDER: Unknown

CONDITION: Exc ___ Good x Fair ___ Poor ___ Ruins ___

INTEGRITY: Original Site ___ Moved x
Date 1950

Major Alterations & Date:
*Moved when junction Routes 125+111
rebuilt in 1950's*

LEVEL/SIGNIFICANCE: Natl ___ State ___ Local ___

BOUNDARY AND ACREAGE DESCRIPTION: 11 Acres

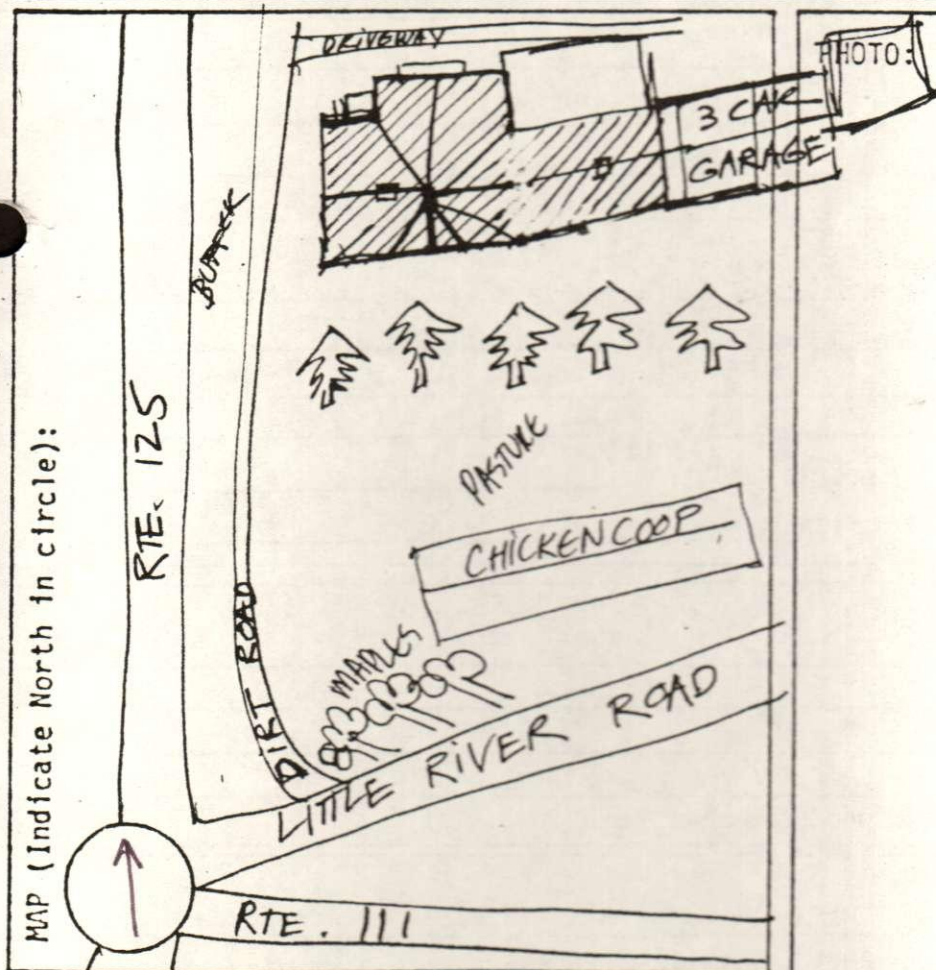

COMMENTS:

Photographer Facing:

Negative File Number:

Photographer:

Negative on file with:

SURVEYOR: L. Monroe

DATE: Dec. 82

1. STYLE		BUILDING TYPE		date
2. # STORIES	2½	DIMENSIONS	25 x 50	BAYS Irreg. FORM Rectangular
3. FOUNDATION	New block	4. STRUCTURE	Balloon	
5. WALLS: Sheathing	Clapboard	Ornamentation	Cornerboards, frieze	
6. ROOF: Type	Cross gable	Sheathing	Asphalt	
	Dormers/Cupolas	Details		
7. CHIMNEYS: #	2	Location	Brick interior	Materials
	Description	Stove corbel		
8. EAVES TREATMENT:	Lateral Molded cornice, boxed, projecting with returns.			
	Gable End			
9. WINDOWS: Placement	Irregular	Shape	Rectangular	Sash 2/2
	Surrounds	Plain boards with 2nd story small cape		
10. ENTRIES: MAIN: Location	Left wing; porch	Door	Single lite victorian panel	
	Surround: Flanked	Simple board surrounds	Topped 4 horizontal panels.	
	Framed			
OTHERS: #		Location		Surrounds
	Shed roof enclosed porch supported by clapboard parapet on centerblock foundation			
	Front shed roof entry porch with square posts			
11. PORCHES/HOODS: #		Style/Roof type		
	Location(s)	Supports		
	Other Features			
12. BAY WINDOWS/TOWERS: #	1	Location	Hip roof	Stories Shape rec.
	Description(s)	Molded surrounds		
13. ELLS/WINGS: #	1	letter on map	Stories A B C	Bays A B C
	Description(s)	ell and garage, same as main block 2x2 bays		
14. STOREFRONTS: Configuration		Windows		
	Doors	Materials/Details		
		Signage		

SITE DESCRIPTION/SURROUNDING ENVIRONMENT

15. RELATED STRUCTURES #	0	Type	
	Description		
16. LANDSCAPE FEATURES: Built			
	Natural		
17. CONTEXT:	Surrounded by pasture and woods nearby, rural.		

SIGNIFICANCE

18. ARCHITECTURAL IMPORTANCE/INTEGRITY	While unusual in its present location, this well-developed Victorian structure would have appeared appropriate in its original in-town setting.
19. SITE INTEGRITY	Moved when Rte. 125 was established.
20. HISTORIC ASSOCIATIONS	

REFERENCES

MAP DATA 1892: A. C. Chase