

HISTORIC PRESERVATION ASSISTANCE PROJECT

Strafford Rockingham Regional Council

1 Water Street, Exeter, New Hampshire

Phone: (603) 778-0885

TOWN: Kingston	COUNTY: Rockingham	UTM: Z 19 /E 336150 /N 4757700
SURVEY NUMBER: 158		USGS QUAD: Haverhill Quad 15' series
COMMON NAME: The Philpott House		FUNCTIONAL TYPE: Farmhouse
HISTORIC NAME: C.H. DeRochemont House		PRESENT USE: Residential
LOCATION: W. side Exeter Rd., .18 Mi. SW of intersection of South Road		ARCHITECT/BUILDER: Unknown
OWNER: Arad Philpott		CONDITION: Exc. <input type="checkbox"/> Good <input checked="" type="checkbox"/> Fair <input type="checkbox"/> Poor <input type="checkbox"/> Ruins <input type="checkbox"/>
ADDRESS: 116 Exeter Rd., Kingston, NH		INTEGRITY: Original Site <input checked="" type="checkbox"/> Moved <input type="checkbox"/> (When: <input type="text"/>)
MAP & PARCEL #: R37-4		Major alterations & date: <input type="text"/>
DATE: C. 1840		
SOURCE: Inspection		
STYLE: Greek Revival		LEVEL/SIGNIFICANCE: Natl <input type="checkbox"/> State <input type="checkbox"/> Local <input checked="" type="checkbox"/>

GENERAL DESCRIPTION: Structural System

1. FOUNDATION: Stonex ☒ Brick ☐ Concrete ☐ Concrete Block ☐ Granite Block ☐
2. WALL STRUCTURE: Wood Frame ☐ Post & Beam ☒ Ballon Frame ☐ Other ☐
Load Bearing Masonry ☐ Stone ☐ Brick ☐ Concrete Block ☐ Other ☐
Metal ☐ Iron ☐ Steel ☐ Other ☐
3. WALL COVERING: Clapboard ☒ Wood Shingle ☐ Board & Batten ☐ Shiplap ☐ Aluminum ☐
Novelty ☐ Stucco ☐ Stone ☐ Brick ☐ Sheet Metal ☐ Asphalt Shingles ☐ Vinyl ☐
Asphalt Sheeting ☐ Composite Board ☐ Other ☐
4. ROOF SHEATHING: Wood Shingle ☐ Asphalt Shingle ☒ Standing Seam Tim ☐ Slate ☐
Pressed Metal ☐ Sheet Metal ☐ Rolled Asphalt ☐ Other ☐
5. ENGINEERING STRUCTURE:
6. OTHER:
of Stories $1\frac{1}{2}$ # of Bays 5X2 Approx. Dimensions 36' X 28'
Roof Style: Gable ☒ Hip ☐ Gambrel ☐ Flat ☐ Shed ☐ Mansard ☐ Jerkinhead ☐
Monitor ☐ Sawtooth ☐ Other ☐
Appendages: Porches ☐ Towers ☐ Dormers ☐ 2 Bay Windows ☐ Ells ☐ Chimneys ☐
Wings ☐ Cupolas ☐ Sheds ☐ Garage ☐ Other ☐ 1 Bow window ☐
Entry Location: Center ☒ Sidehall ☐ Other ☐

MAP (Indicate North in circle):

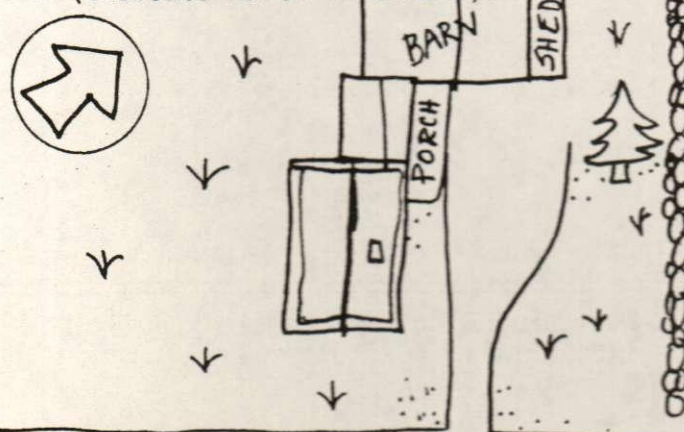

PHOTO



Description of View:

Front (SE) Side (NE)

Photographer: Scott Novak

Negative with: S.R.R.C.

Negative File Number: K80-11-C/36-36A

ADDITIONAL ARCHITECTURAL AND STRUCTURAL DESCRIPTION:

The Philpott house is a $1\frac{1}{2}$ story Greek Revival style structure with its five bay, gable end oriented toward the street. The 4 panelled center entry door is flanked by sidelights and panelled pilasters which rise to meet a full pedimented entablature. Window sash includes two over two, six over two and four over four, all with arched caps. There is one multi-light bow window on the northeast elevation. The medium pitched roof is topped by one corbel capped chimney, and two four bay shed dormers. The eaves treatment consists of a boxed cornice with a wide frieze, and gable end returns visually supported by panelled pilasters.

A 1 story gable roofed ell rests on a cement foundation. It has a 4 panelled door sheltered by an overhanging shed roofed porch, clapboard siding, and windows with six over six sash.

RELATED STRUCTURES AND CONTEXT: Attached is a $1\frac{1}{2}$ story gabled roof barn has wood shingle siding, swinging type vertical board doors and an extended shed roofed open shed.

BOUNDARY AND ACREAGE DESCRIPTION: 9.5 Acres. Bounded to the N. by Verrill, Quintel, Regen, and Teppen, S. by Goodwin, E. by Exeter Road, W. by Kerkhoff.

REFERENCES:

• 1856 Map

1892 Map

STATEMENT OF SIGNIFICANCE (Evaluation & Historical Associations):

The C. H. DeRochemont House is one of four wide gable Greek Revival houses built on the Exeter Road c.1840. The other three are Sites #159 and 162, with the last on the Exeter portion of the road. This interesting architectural configuration was not widely used and is interesting to find in concentration in this area.

MAP DATA: 1856: C. H. DeRochemont
1892: D. P. DeRochemont

SURROUNDING ENVIRONMENT: Open Land ☒ Woodland ☐ Scattered Bldgs ☒ Moderately Built Up ☐
Densely Built Up ☐ Residential ☐ Commercial ☐ Industrial ☐ Agricultural ☐
Roadside Strip Development ☐ Other ☐

Recorded By: Scott Novak, Herb Bubert

Date: 4/7/80

