

HISTORIC PRESERVATION ASSISTANCE PROJECT

Strafford Rockingham Regional Council

1 Water Street, Exeter, New Hampshire

Phone: (603) 778-0885

TOWN: Kingston	COUNTY: Rockingham	UTM: Z 19 /E 324975 /N 4757050
SURVEY NUMBER: 162		USGS QUAD: Haverhill Quad 15' Series
COMMON NAME: Kemp House		FUNCTIONAL TYPE: Farmhouse
HISTORIC NAME: Moses Sanborn House		PRESENT USE: Residential
LOCATION: S side of Exeter Rd., .15 miles NE of intersection of Willow Road.		ARCHITECT/BUILDER: Unknown
OWNER: G. Austin Kemp heirs & Nellie		CONDITION: Exc. <input checked="" type="checkbox"/> Good <input checked="" type="checkbox"/> Fair <input type="checkbox"/> Poor <input type="checkbox"/> Ruins <input type="checkbox"/>
ADDRESS: 71 Exeter Rd., Kingston, NH		INTEGRITY: Original Site <input checked="" type="checkbox"/> Moved <input type="checkbox"/> (When: <input type="text"/>)
MAP & PARCEL #: R-36/4		Major alterations & date: <input type="text"/>
DATE: c. 1830		LEVEL/SIGNIFICANCE: Natl <input type="checkbox"/> State <input type="checkbox"/> Local <input checked="" type="checkbox"/>
SOURCE: Inspection		
STYLE: Greek Revival		

GENERAL DESCRIPTION: Structural System

- FOUNDATION: Stone ☒ Brick ☐ Concrete ☐ Concrete Block ☐
- WALL STRUCTURE: Wood Frame ☐ Post & Beam ☒ Ballon Frame ☐ Other ☐
Load Bearing Masonry ☐ Stone ☐ Brick ☐ Concrete Block ☐ Other ☐
Metal ☐ Iron ☐ Steel ☐ Other ☐
- WALL COVERING: Clapboard ☒ Wood Shingle ☐ Board & Batten ☐ Shiplap ☐ Aluminum ☐
Novelty ☐ Stucco ☐ Stone ☐ Brick ☐ Sheet Metal ☐ Asphalt Shingles ☐ Vinyl ☐
Asphalt Sheeting ☐ Composite Board ☐ Other ☐
- ROOF SHEATHING: Wood Shingle ☐ Asphalt Shingle ☒ Standing Seam Tin ☐ Slate ☐
Pressed Metal ☐ Sheet Metal ☐ Rolled Asphalt ☐ Other ☐
- ENGINEERING STRUCTURE:
- OTHER:
of Stories 1 1/2 # of Bays 5x4 Approx. Dimensions 32' x 30'
Roof Style: Gable ☒ Hip ☐ Gambrel ☐ Flat ☐ Shed ☐ Mansard ☐ Jerkinhead ☐
Monitor ☐ Sawtooth ☐ Other ☐
Appendages: Porches 1 Towers ☐ Dormers ☐ Bay Windows ☐ Ells 1 Chimneys 2
Wings ☐ Cupolas ☐ Sheds ☐ Garage ☐ Other ☐
Entry Location: Center ☒ Sidehall ☐ Other ☐

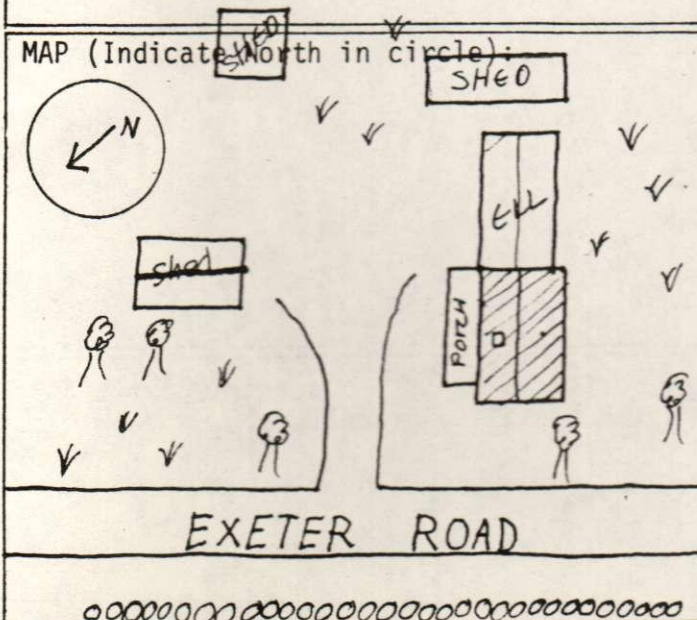

PHOTO



Description of View: Front-west
Side-north

Photographer: Herb Bubert
Negative with: S.R.R.C.
Negative File Number: K-80-12c/5A-6

ADDITIONAL ARCHITECTURAL AND STRUCTURAL DESCRIPTION:

The Kemp House is a 1½-story early Greek Revival style structure with its five-bay, gable end oriented toward the street. The 5-panelled center entry door contains one large light, and is flanked by double, half-length sidelights, and surmounted by a partial entablature. Windows have two-over-two sash and one framed by architrave trim. There is one window with six-over-six sash in the gable. The medium-pitched roof is topped by two chimneys, and the cornice treatment consists of close, molded, lateral and raking eaves. Panelled corner pilasters meet the gable end returns.

A 1-story, shed-roofed enclosed porch has clapboard siding and windows with one-over-one sash.

A 1-story, gable-roofed ell rests on a granite block foundation. It has a vertical-board door, clapboard siding, and windows with two-over-two sash.

RELATED STRUCTURES AND CONTEXT: There are three separate 1-story, gable-roofed sheds.

BOUNDARY AND ACREAGE DESCRIPTION: .5 acres bounded to the N-Route 111, S-Kemp, E-Kemp, W-Henshaw.

REFERENCES: Kingston Historic Advisory Committee; interviews w/members, Spring 1980
1856 Map; 1892 Map
Sanborn, Leonard. The Sanborns of Kingston, New Hampshire (typed manuscripts)

STATEMENT OF SIGNIFICANCE (Evaluation & Historical Associations):

The Moses Sanborn House is another in the group of four wide gable Greek Revival style houses (Sites 158, 159, and one in Exeter on Exeter Road). This architectural configuration was not widely used and is interesting to find in concentration in this area.

Historic Associations: "Tanner Moses" Sanborn had a tanning pit across the street (site still survives.) Sanborn was an important member of the prominent Sanborn family.

MAP DATA: 1856: Moses Sanborn
1892: E. J. Norfolk

SURROUNDING ENVIRONMENT: Open Land ☒ Woodland ☐ Scattered Bldgs ☒ Moderately Built Up ☐
Densely Built Up ☐ Residential ☐ Commercial ☐ Industrial ☐ Agricultural ☐
Roadside Strip Development ☐ Other ☐

Recorded By: Scott Novak
Herb Bubert

Date: 4/7/80