

HISTORIC PRESERVATION ASSISTANCE PROJECT

Strafford Rockingham Regional Council

1 Water Street, Exeter, New Hampshire

Phone: (603) 778-0885

TOWN: Kingston	COUNTY: Rockingham	UTM: Z 19 /E 334700 /N 4756950
SURVEY NUMBER: 163		USGS QUAD: Haverhill Quad 15' series
COMMON NAME: The Henshaw House		FUNCTIONAL TYPE: Farmhouse
HISTORIC NAME: L. Sanborn House		PRESENT USE: Farmhouse
LOCATION: NW side Exeter Rd., .01 Mi. SW Intersection Willow Rd.		ARCHITECT/BUILDER: Mr. Sanborn
OWNER: George Henshaw		CONDITION: Exc. <input checked="" type="checkbox"/> Good <input type="checkbox"/> Fair <input type="checkbox"/> Poor <input type="checkbox"/> Ruins <input type="checkbox"/>
ADDRESS: 66 Exeter Rd., Kingston, NH		INTEGRITY: Original Site <input checked="" type="checkbox"/> Moved <input type="checkbox"/> (When:)
MAP & PARCEL #: R39-34		Major alterations & date: Windows changed date unknown
DATE: C. 1809		LEVEL/SIGNIFICANCE: Natl State Local <input checked="" type="checkbox"/>
SOURCE: Assessors Office, Kingston		
STYLE: Federal		

GENERAL DESCRIPTION: Structural System

- FOUNDATION: Stonex ☒ Brick ☐ Concrete ☐ Concrete Block ☐
- WALL STRUCTURE: Wood Frame ☐ Post & Beam ☒ Ballon Frame ☐ Other ☐
Load Bearing Masonry ☐ Stone ☐ Brick ☐ Concrete Block ☐ Other ☐
Metal ☐ Iron ☐ Steel ☐ Other ☐
- WALL COVERING: Clapboard ☒ Wood Shingle ☐ Board & Batten ☐ Shiplap ☐ Aluminum ☐
Novelty ☐ Stucco ☐ Stone ☐ Brick ☐ Sheet Metal ☐ Asphalt Shingles ☐ Vinyl ☐
Asphalt Sheeting ☐ Composite Board ☐ Other ☐
- ROOF SHEATHING: Wood Shingle ☐ Asphalt Shingle ☒ Standing Seam Tin ☐ Slate ☐
Pressed Metal ☐ Sheet Metal ☐ Rolled Asphalt ☐ Other ☐
- ENGINEERING STRUCTURE:
- OTHER:
of Stories 2 1/2 # of Bays 5X4 Approx. Dimensions 41' X 30'
Roof Style: Gable ☒ Hip ☐ Gambrel ☐ Flat ☐ Shed ☐ Mansard ☐ Jerkinhead ☐
Monitor ☐ Sawtooth ☐ Other ☐
Appendages: Porches ☐ Towers ☐ Dormers ☐ Bay Windows ☐ Ells 1 Chimneys 2
Wings 1 Cupolas ☐ Sheds ☐ Garage ☐ Other ☐ Barn ☐
Entry Location: Center ☒ Sidehall ☐ Other ☐

MAP (Indicate North in circle):

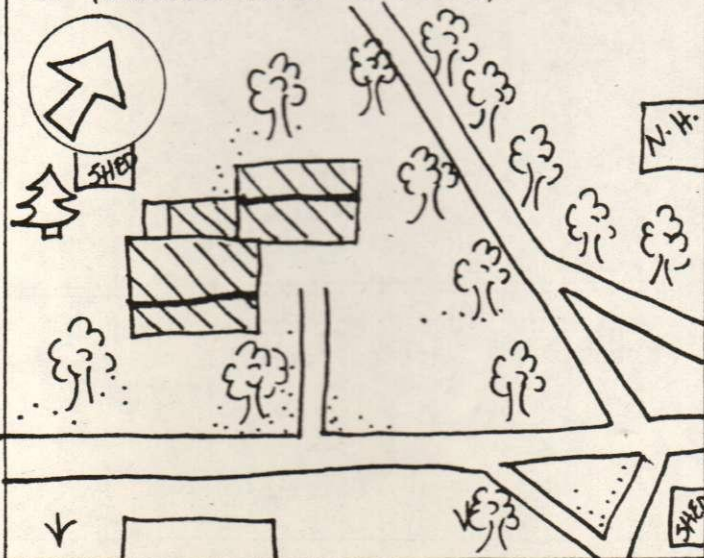

PHOTO



Description of View:

Front (SE) Side (NE)

Photographer: Herb Bubert

Negative with: S.R.R.C.

Negative File Number: K80-12C-6A-7

ADDITIONAL ARCHITECTURAL AND STRUCTURAL DESCRIPTION:

The Henshaw house is a 2 $\frac{1}{2}$ story, gable roofed twin chimney, Federal style house. The center entry has a 6 panelled door flanked by half-length sidelights. Framing the entrance are fluted pilasters which rise to a full entablature. All of the windows have six over six sash. The house rests on a granite slab foundation. A 1 story, enclosed porch and a 1 story shed roofed ell project to the northwest.

Struck by lightning c.1965. Blew out front of house.

RELATED STRUCTURES AND CONTEXT: To the northwest of the house is a 1 story, gable roofed shed. Across the street to the south is a 2 $\frac{1}{2}$ story, gable roofed barn with a sheet metal silo and two attached sheds.

BOUNDARY AND ACREAGE DESCRIPTION: 5.1 Acres. Bounded to the N. by Little River Road, S. by Exeter Road, and Bradbrook, E. by Little River Road, Exeter Road, W. by Bradbrook.

REFERENCES:

1856 Map

1892 Map

STATEMENT OF SIGNIFICANCE (Evaluation & Historical Associations):

The L. Sanborn House is a fine example of a vernacular Federal style farmhouse associated with the prominent Sanborn family.

MAP DATA: 1856: L. Sanborn
1892: J. H. Sanborn

SURROUNDING ENVIRONMENT: Open Land ☒ Woodland ☐ Scattered Bldgs ☒ Moderately Built Up ☐
Densely Built Up ☐ Residential ☐ Commercial ☐ Industrial ☐ Agricultural ☒
Roadside Strip Development ☐ Other ☐

Recorded By: Herb Bubert, Scott Novak

Date: 4/7/80

