

HISTORIC PRESERVATION ASSISTANCE PROJECT

Strafford Rockingham Regional Council

1 Water Street, Exeter, New Hampshire

Phone: (603) 778-0885

TOWN: Kingston	COUNTY: Rockingham	UTM: Z 19 /E 334350 /N 4756800
SURVEY NUMBER: 164		USGS QUAD: Haverhill Quad 15' series
COMMON NAME: The Bradbrook House		FUNCTIONAL TYPE: Farmhouse
HISTORIC NAME: M. P. French House		PRESENT USE: Residence
LOCATION: S. Side Exeter Rd., .32 Mi. SW intersection of Willow Rd.		ARCHITECT/BUILDER: Unknown
OWNER: Robert Bradbrook		CONDITION: Exc. <input checked="" type="checkbox"/> Good <input type="checkbox"/> Fair <input type="checkbox"/> Poor <input type="checkbox"/> Ruins <input type="checkbox"/>
ADDRESS: 53 Exeter Rd., Kingston, NH		INTEGRITY: Original Site <input checked="" type="checkbox"/> Moved <input type="checkbox"/> (When: <input type="text"/>)
MAP & PARCEL #: R35-12		Major alterations & date: <input type="text"/>
DATE: C. 1820		
SOURCE: Inspection		
STYLE: Federal/Greek Revival		LEVEL/SIGNIFICANCE: Natl <input type="checkbox"/> State <input type="checkbox"/> Local <input checked="" type="checkbox"/>

GENERAL DESCRIPTION: Structural System

- FOUNDATION: Stone ☒ Brick ☐ Concrete ☐ Concrete Block ☐
- WALL STRUCTURE: Wood Frame ☐ Post & Beam ☒ Ballon Frame ☒ Other ☐
Load Bearing Masonry ☐ Stone ☐ Brick ☐ Concrete Block ☐ Other ☐
Metal ☐ Iron ☐ Steel ☐ Other ☐
- WALL COVERING: Clapboard ☐ Wood Shingle ☐ Board & Batten ☐ Shiplap ☐ Aluminum ☐
Novelty ☐ Stucco ☐ Stone ☐ Brick ☐ Sheet Metal ☐ Asphalt Shingles ☐ Vinyl ☒
Asphalt Sheeting ☐ Composite Board ☐ Other ☐
- ROOF SHEATHING: Wood Shingle ☐ Asphalt Shingle ☒ Standing Seam Tin ☐ Slate ☐
Pressed Metal ☐ Sheet Metal ☐ Rolled Asphalt ☐ Other ☐
- ENGINEERING STRUCTURE:
- OTHER:
of Stories 2 # of Bays 5X2 Approx. Dimensions 33' X 25'
Roof Style: Gable ☒ Hip ☐ Gambrel ☐ Flat ☐ Shed ☐ Mansard ☐ Jerkinhead ☐
Monitor ☐ Sawtooth ☐ Other ☐
Appendages: Porches 1 Towers ☐ Dormers ☐ Bay Windows ☐ Ells ☐ Chimneys 2
Wings 1 Cupolas ☐ Sheds 2 Garage ☐ Other ☐
Entry Location: Center ☒ Sidehall ☐ Other ☐

MAP (Indicate North in circle):

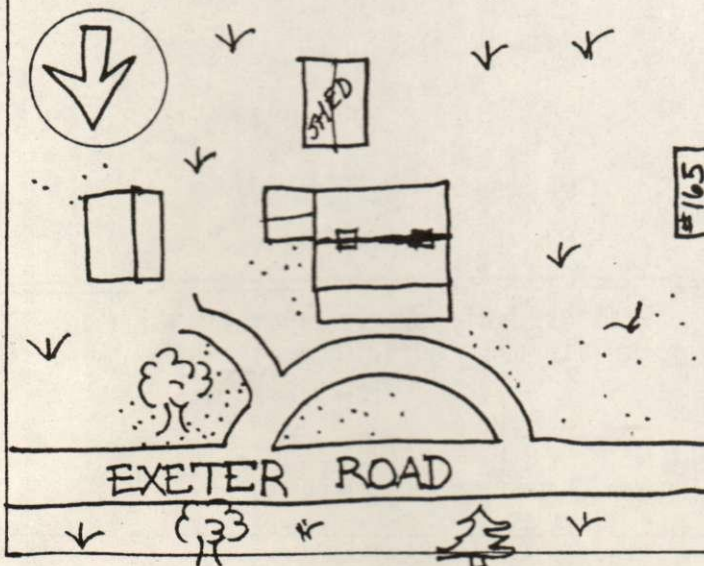

PHOTO



Description of View:

Front (N) Side (E)

Photographer: Herb Bubert

Negative with: S.R.R.C.

Negative File Number: K80-12-C/7A-8

ADDITIONAL ARCHITECTURAL AND STRUCTURAL DESCRIPTION:

The Bradbrook house is a 2½ story transitional Federal/Greek Revival style structure. The 6 panelled center entry door contains one light, and is flanked by sidelights extending halfway to floor level, and pilasters. It is sheltered by a 1 story, shed roofed open porch that extends across the facade. It is supported by round tapering columns, and the eaves treatment consists of a boxed cornice with a pedimented gable in the center. The main block windows have six over six sash, and are surmounted by slightly projecting caps. The medium pitched roof is topped by two chimneys and the eaves treatment consists of a boxed cornice with a wide frieze and gable end returns. A 1 story gable roofed wing to the East has the same foundation, siding cornice and window sash as the main block.

RELATED STRUCTURES AND CONTEXT: A 1 story gable roofed shed rests on a stone foundation. It has wood shingle siding and windows with six over six sash.

A 1½ story gable roofed shed has a 4 panelled door, windows with six over six sash, clapboard siding a horizontally sliding door and a hayloft door and vergeboard in the gable.

BOUNDARY AND ACREAGE DESCRIPTION: 2 Acres. Bounded to the N. by Route 111, S. by Bradbrook, and Farrow, E. by Route 111 and Farrow, W. by Bradbrook and Wajda.

REFERENCES:

1856 Map

1892 Map

STATEMENT OF SIGNIFICANCE (Evaluation & Historical Associations):

The M. P. French House is an example of a transitional period between Federal and Greek Revival styles featuring typical Federal massing and floor plan.

MAP DATA: 1856: M. P. French
1892: S. E. Gilman

SURROUNDING ENVIRONMENT: Open Land ☒ Woodland ☐ Scattered Bldgs ☒ Moderately Built Up ☐
Densely Built Up ☐ Residential ☐ Commercial ☐ Industrial ☐ Agricultural ☐
Roadside Strip Development ☐ Other ☐

Recorded By: Scott Novak, Herb Bubert

Date: 4/8/80

