

HISTORIC PRESERVATION ASSISTANCE PROJECT

Strafford Rockingham Regional Council

1 Water Street, Exeter, New Hampshire

Phone: (603) 778-0885

TOWN: Kingston	COUNTY: Rockingham
SURVEY NUMBER: 166	
COMMON NAME: The Shaw Kennedy House	
HISTORIC NAME: C. L. Eastman House	
LOCATION: N. Side Exeter Road, .75 Mi. SW intersection of Willow Road	
OWNER: Grace S. Shaw Kennedy	
ADDRESS: 32 Exeter Rd., Kingston, NH	
MAP & PARCEL #: R35-5	
DATE: C. 1840	
SOURCE: Inspection	
STYLE: Greek Revival/ Italianate	

UTM: Z 19 /E 333700 /N 4756700
USGS QUAD: Haverhill Quad 15' series
FUNCTIONAL TYPE: Residential
PRESENT USE: Residence
ARCHITECT/BUILDER: Unknown
CONDITION: Exc. <u>Good</u> <u>X</u> Fair <u>Poor</u> <u>Ruins</u>
INTEGRITY: Original Site <u>X</u> Moved <u> </u> (When: <u> </u>)
Major alterations & date: Siding 1982; garage rebuilt 1981
LEVEL/SIGNIFICANCE: Natl <u> </u> State <u> </u> Local <u>X</u>

GENERAL DESCRIPTION: Structural System

- FOUNDATION: Stonex Brick Concrete Concrete Block
- WALL STRUCTURE: Wood Frame Post & Beam Ballon Frame X Other
Load Bearing Masonry Stone Brick Concrete Block Other
Metal Iron Steel Other
- WALL COVERING: Clapboard X Wood Shingle Board & Batten Shiplap Aluminum Novelty Stucco Stone Brick Sheet Metal Asphalt Shingles Vinyl Asphalt Sheeting Composite Board Other
- ROOF SHEATHING: Wood Shingle Apshalt Shingle X Standing Seam Tim Slate Pressed Metal Sheet Metal Rolled Asphalt Other
- ENGINEERING STRUCTURE:
- OTHER:
of Stories 2 1/2 # of Bays 5X4 Approx. Dimensions 35' X 32'
Roof Style: Gable X Hip Gambrel Flat Shed Mansard Jerkinhead Monitor Sawtooth Other
Appendages: Porches Towers Dormers Bay Windows Ells 1 Chimneys 1 on MB
Wings 1 Cupolas Sheds 2 Garage Other Barn 1 on ell
Entry Location: Center X Sidehall Other

MAP (Indicate North in circle):

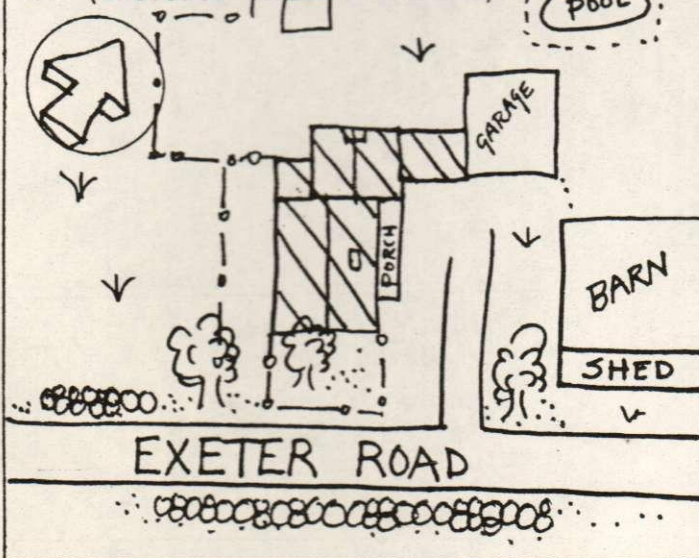

PHOTO



Description of View:

Front (S) Side (E)

Photographer: Herb Bubert

Negative with: S.R.R.C.

Negative File Number: K80-12-C/9A-10

ADDITIONAL ARCHITECTURAL AND STRUCTURAL DESCRIPTION:

The Shaw Kennedy house is a $2\frac{1}{2}$ story Greek Revival/Italianate style structure. The double leaf central entry door each contain three recessed panels. They are flanked by pilasters which rise to meet a full, bracketed, entablature. Windows have two over one sash and are framed by molded trim and caps. The medium pitched roof is topped by one narrow chimney, and the eaves treatment consists of a boxed cornice with a wide frieze that is bracketed on the raking eaves. The bracketed gable end returns are visually supported by wide corner pilasters.

A 1 story shed roofed open porch on the east elevation is supported by round, tapering columns. It shelters a double leaf door identical to the front door.

A $1\frac{1}{2}$ story gable roofed ell has clapboard siding, close eaves and a tall narrow chimney. There is a 1 story shed roofed shed on the west elevation of the ell.

A 1 story gable roofed wing off the east elevation of the ell rests on a cement foundation. It has clapboard siding, a 4 light door, and windows with two over two sash.

RELATED STRUCTURES AND CONTEXT: There is an attached (recent) $1\frac{1}{2}$ story 2 bay garage. A separate $1\frac{1}{2}$ story gable roofed barn to the east of the house rests on a fieldstone foundation. It has horizontally sliding vertical board doors, asbestos shingle siding, and windows with six over six sash. It also has an attached shed roofed shed. There is a separate 1 story gable roofed shed.

BOUNDARY AND ACREAGE DESCRIPTION: 31 Acres. Bounded to the N. by Brimicombe, Daubenspeck, and Twombly, S. by Exeter Rd., E. by Bastien, W. by Houleheins.

REFERENCES:

1856 Map

1892 Map

STATEMENT OF SIGNIFICANCE (Evaluation & Historical Associations):

The C. L. Eastman House is an outstanding example of early 19th century building. Its fine detailing and unusual square plan make this an extremely attractive structure.

MAP DATA: 1856: C. L. Eastman
1892: J. Smith

SURROUNDING ENVIRONMENT: Open Land ☒ Woodland ☐ Scattered Bldgs ☒ Moderately Built Up ☐
Densely Built Up ☐ Residential ☒ Commercial ☐ Industrial ☐ Agricultural ☐
Roadside Strip Development ☐ Other ☐

Recorded By: Scott Novak, Herb Bubert.

Date: 4/8/80

