

HISTORIC PRESERVATION ASSISTANCE PROJECT

Strafford Rockingham Regional Council

1 Water Street, Exeter, New Hampshire

Phone: (603) 778-0885

TOWN: Kingston	COUNTY: Rockingham	UTM: Z 19 /E 333125 /N 4756525
SURVEY NUMBER: 169		USGS QUAD: Haverhill Quad 15' series
COMMON NAME: The Carney House		FUNCTIONAL TYPE: Farmhouse
HISTORIC NAME: C. Thayer House		PRESENT USE: Residential
LOCATION: N. side Exeter Rd., 1.19 Mi. SW intersection Willow Rd.		ARCHITECT/BUILDER: Unknown
OWNER: Raymond Carney		CONDITION: Exc <input checked="" type="checkbox"/> Good <input type="checkbox"/> Fair <input type="checkbox"/> Poor <input type="checkbox"/> Ruins <input type="checkbox"/>
ADDRESS: 10 Exeter Rd., Kingston, NH		INTEGRITY: Original Site <input checked="" type="checkbox"/> Moved <input type="checkbox"/> (When: <input type="text"/>)
MAP & PARCEL #: R34-58		Major alterations & date: Chimney removed
DATE: C. 1720		porch added dates unknown
SOURCE: Assessors Office, Kingston		LEVEL/SIGNIFICANCE: Natl <input type="checkbox"/> State <input type="checkbox"/> Local <input checked="" type="checkbox"/>
STYLE: Georgian		

GENERAL DESCRIPTION: Structural System

1. FOUNDATION: Stonex ☒ Brick ☐ Concrete ☐ Concrete Block ☒
2. WALL STRUCTURE: Wood Frame ☐ Post & Beam ☒ Ballon Frame ☐ Other ☐
Load Bearing Masonry ☐ Stone ☐ Brick ☐ Concrete Block ☐ Other ☐
Metal ☐ Iron ☐ Steel ☐ Other ☐
3. WALL COVERING: Clapboard ☒ Wood Shingle ☐ Board & Batten ☐ Shiplap ☐ Aluminum ☐
Novelty ☐ Stucco ☐ Stone ☐ Brick ☐ Sheet Metal ☐ Asphalt Shingles ☐ Vinyl ☐
Asphalt Sheeting ☐ Composite Board ☐ Other ☐
4. ROOF SHEATHING: Wood Shingle ☐ Asphalt Shingle ☒ Standing Seam Tim ☐ Slate ☐
Pressed Metal ☐ Sheet Metal ☐ Rolled Asphalt ☐ Other ☐
5. ENGINEERING STRUCTURE:
6. OTHER:
of Stories 2 1/2 # of Bays 3X2 Approx. Dimensions 38' X 26'
Roof Style: Gable ☒ Hip ☐ Gambrel ☐ Flat ☐ Shed ☐ Mansard ☐ Jerkinhead ☐
Monitor ☐ Sawtooth ☐ Other ☐
Appendages: Porches 1 Towers ☐ Dormers 1 Bay Windows ☐ Ells 1 Chimneys 1 on MB
Wings 1 Cupolas ☐ Sheds ☐ Garage ☐ Other ☐ Barn ☐
Entry Location: Center ☒ Sidehall ☐ Other ☐

MAP (Indicate North in circle):

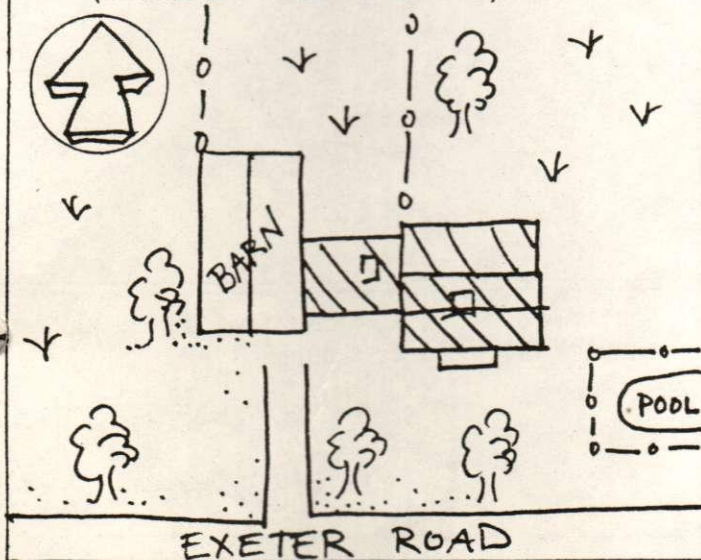

PHOTO



Description of View:

Front (S) Side (W)

Photographer: Herb Bubert

Negative with: S.R.R.C.

Negative File Number: K80-12C-12A-13

ADDITIONAL ARCHITECTURAL AND STRUCTURAL DESCRIPTION:

The Carney house is a 2½ story, gable roofed Georgian Style house which has been remodeled, including the removal of its massive central chimney and the addition of a 1 story, gable roofed enclosed porch on its front facade. A shed roofed ell has been added giving the house the appearance of a saltbox. All of the windows on the main block have two over two sash framed by architrave trim. The low pitched roof is now topped by a narrow corbel capped chimney. The house rests on a fieldstone foundation which has been reinforced with concrete block.

A 1 story, shed roofed wing projects from the west elevation.

RELATED STRUCTURES AND CONTEXT:

To the west of the main block is a 2½ story gable roofed barn.

BOUNDARY AND ACREAGE DESCRIPTION: 2.94 Acres. Bounded to the N. by Briggs, S. by Exeter Road, E. by Sager, W. by Briggs.

REFERENCES:

Kingston Historic Advisory Committee; interviews w/members, Spring 1980

1856 Map

1892 Map

STATEMENT OF SIGNIFICANCE (Evaluation & Historical Associations):

The C. Thayer House has been remodeled extensively, detracting from its architectural significance.

Historic Associations: In 1733 article, house referred to as, "Old Manse."
Elihu Thayer, congregational minister, lived here 1776-1812.

MAP DATA: 1856: C. Thayer
1892: W. Thayer

SURROUNDING ENVIRONMENT: Open Land ☒ Woodland ☐ Scattered Bldgs ☒ Moderately Built Up ☐
Densely Built Up ☐ Residential ☐ Commercial ☐ Industrial ☐ Agricultural ☒
Roadside Strip Development ☐ Other ☐

Recorded By: Herb Bubert, Scott Novak

Date: 4/8/80

